

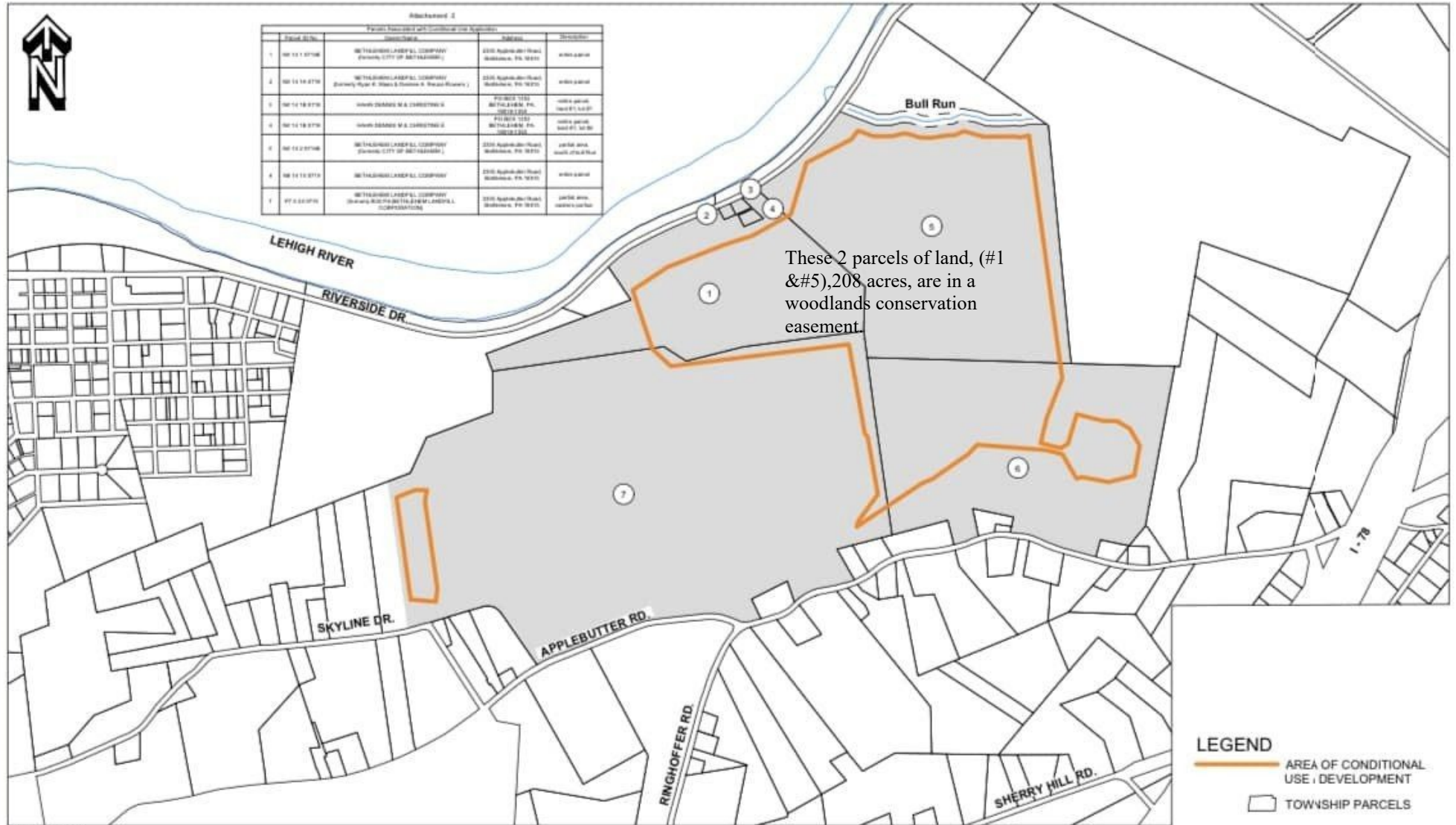

Attachment 2
Parcel Associated with Conditional Use Application

Parcel #/ID	Owner/Holder	Address	Notes
1 100 14 18 0710	100TH STREET LANDFILL CORP/PAV (formerly CITY OF BETHLEHEM)	2310 Applebutter Road, Bethlehem, PA 18010	active parcel
2 100 14 18 0710	100TH STREET LANDFILL CORP/PAV (formerly Roper R. Wilson & Sonnes S. Wilson Owners)	2310 Applebutter Road, Bethlehem, PA 18010	active parcel
3 100 14 18 0710	WILSON DONORS M.A. CHRISTENSEN	PO BOX 1050, BETHLEHEM, PA, 18010-1050	active parcel, used for landfill
4 100 14 18 0710	WILSON DONORS M.A. CHRISTENSEN	PO BOX 1050, BETHLEHEM, PA, 18010-1050	active parcel, used for landfill
5 100 14 18 0710	100TH STREET LANDFILL CORP/PAV (formerly CITY OF BETHLEHEM)	2310 Applebutter Road, Bethlehem, PA 18010	partial area, south of Bull Run
6 100 14 18 0710	100TH STREET LANDFILL CORP/PAV	2310 Applebutter Road, Bethlehem, PA 18010	active parcel
7 100 14 18 0710	100TH STREET LANDFILL CORP/PAV (formerly Roper R. Wilson & Sonnes S. Wilson Owners)	2310 Applebutter Road, Bethlehem, PA 18010	active parcel



These 2 parcels of land, (#1 & #5), 208 acres, are in a woodlands conservation easement.

LEGEND
— AREA OF CONDITIONAL USE / DEVELOPMENT
□ TOWNSHIP PARCELS

1102_SCI22-01.dwg

PREPARED BY:
MMI martin and martin incorporated
37 south main street • suite A
chambersburg, pennsylvania • 17201

NOTE:
PARCEL DATA FROM COUNTY OF NORTHAMPTON (GIS DATA),
ZONING DATA FROM LOWER SAUCON TOWNSHIP.

800' 0' 800' 1600'

ATTACHMENT 2



Aerial view of landfill, facing west. The forested area near the bottom right corner is a partial view the proposed expansion area.