PLEASE TAKE NOTICE that the LIVONIA JOINT PLANNING BOARD will hold a public hearing on Monday, October 27, 2025, at 7 p.m. at the Livonia Town Hall, 35 Commercial Street, Livonia, New York to consider the application of Sonbyrne Sales, LLC/Byrne Dairy for approval of a Conditional Use Permit per Section 150-20D, and for Site Plan review according to Section 150-12 of the Zoning Code of Livonia.

The proposal is for a 4968 SF Byrne Dairy Gas Station and Convenience Store located at the NE corner of Big Tree Road and Thomas Drive, Lakeville, New York, Tax parcel number 65.-1-66.112. Site Plan and Conditional Use Permit approvals are required per Section 150-36 D (12).

The property is zoned Gateway Commercial (GC). The application is on file in the Building & Zoning Department in the Livonia Town Hall, 35 Commercial Street, Livonia, New York, for public review. All interested parties will be heard at this time.

Livonia Joint Planning Board
Alison Houk, Secretary
Publication Date: October 17, 2025



Town of Livonia
35 Commercial Street, PO Box 43
Livonia, New York 14487
(585) 346-2098

APPLICATION FOR REVIEW AND APPROVAL OF SITE PLAN

Boyd Development Corp.

Applicant: Sonbyrne Sales, Inc. Owner of Land: _____
Address: 171 NY-5 Address: 11175 Canaseraga Road
Windsport, NY 13166 Dansville, NY 14437
Email Address: Christian.brunkle@byrnedev.com Brokaw11175@gmail.com
Phone#: 315-420-7575 Phone#: 585-991-8556
Property located in GC Zoning District. Tax parcel of the proposed property: 65-1-66.112
Location of proposed Site Plan (distance & direction to nearest road intersection): Located at the intersection of
Big Tree Road & Thomas Drive. The intersection is at the Southwest property corner.
Size of property (dimensions & area): 2.72 +/- acres
Site Plan prepared by the following Licensed Engineer and/or Land Surveyor: Plumky Engineering PC - Julian Clark
Attorney for Applicant, if any: James Gosier Phone #: 315-703-9093
Address: 2394 US-11 Lafayette, NY 13084
Is property located in a Floodplain area? No
Names of adjoining property owners or owners directly across highway: East: Plumky Realty, LLC North: Boyd Development Corp. & The Conesus
West: 5409 Big Tree Rd, LLC South: Minuta Man Sv, Inc. & Tj's Landscaping, LLC
Describe any Easements or other restrictions on the property: 45' Utility Easement along frontage / 10' Utility Easement
Livingston County Water & Sewer easement / ROW to other properties within the development "park"
The undersigned applicant hereby requests approval by the Livonia Joint Planning Board of the above-identified Subdivision Plans.
Applicant Representative: [Signature] Date: 9/9/2025
Owner: Boyd Brokaw Date: 15/09/25

This application must be accompanied by all Review Fees as determined from the Schedule of Review Fees as adopted by the Town Board, as posted in the Building & Zoning Office.

\$75.00 - Planning Board review.

\$85.00 - Planning Board review & Public Hearing. **Please address payments to: "Livonia Town Clerk"

This application requires the submission of a Short form Environmental form (SEQR), and an Agricultural Date Statement if applicable.

Email the complete digital application to: bzteam@livonianyny.org

The applicant will be required, where applicable, to conform to the Livonia Design Criteria, and specifications for land development. Site Plan Approval is required prior to the issuance of a Building Permit. The Town of Livonia is not responsible for the quantity or quality of water. Permits for Septic Systems must be obtained from Livingston County Health Department. New driveway location(s) must conform to the Town of Livonia requirements and a Permit from Livingston County Highway Department, (DOT) must be obtained.

Costs incurred by the Planning Board for consultation fees or other extraordinary expenses in connection with the review of a proposed Subdivision shall be charged to the applicant. (Example: Town Engineer fees, etc.).

RECEIVED

OCT 09 2025

Town/Village of Livonia

Planning Board
Conditional Use Permit Worksheet

150-20 D. Town & 155-20 D. Village: A permit for any conditional permit use shall be granted only if evidence is presented which establishes that:

1. The proposed building or use will be in harmony with the general purpose, goals, objectives and standards of the Comprehensive Plan; zoning, and where applicable, Chapter 125 Subdivision of Land. YES___ NO___

Explain:

See attachment A

2. The proposed building, hours of operation, or use will not have a substantial or undue adverse effect upon adjacent property, the character of the neighborhood, traffic conditions, parking, utility facilities and other matters affecting the public health, safety, and general welfare. YES___ NO___

Explain:

See attachment A

3. The proposed building or use will be constructed, arranged, and operated so as not to dominate the immediate vicinity or to interfere with the development and use of neighboring property in accordance with the applicable district regulations. YES___ NO___

Explain:

See attachment A

4. The proposed building or use will be adequately served by essential public facilities and services. YES___ NO___

Explain:

See attachment A

5. The proposed building or use complies with all additional standards imposed on it by the particular provision of this chapter authorizing such use. YES___ NO___

Explain:

See attachment A

6. All steps possible have been taken to minimize any adverse effects of the proposed building or use on the immediate vicinity through building design, site design, landscaping, and screening. YES___ NO___

Explain:

See attachment A

7. Is a performance bond or other suitable financial guaranty necessary to assure compliance with the conditions of the conditional use permit? YES___ NO___

Explain:

See attachment A

Livonia Planning Board - Conditional Use Permit Worksheet

Attachment A – Sonbyrne Sales, Inc.

1. Yes. The proposed building will be in harmony with the general purpose, goals, objectives and standards of the comprehensive plan, Lakeville Corridor Strategic Plan and the Town of Livonia, NY zoning code. This is because of a few main reasons:
 - A. The property is within the Gateway Commercial district, which is the most intense district relative to use as GC district allows a wide variety of professional, commercial, and retail uses.
 - B. The intent of the GC District is classified as “The intent of the Gateway Commercial District is to *provide conveniently located areas of moderately intense commercial uses located in freestanding buildings*, multitenant buildings and neighborhood shopping centers” within the Towns zoning code. The Gateway Commercial district is also defined as a district that “accommodate(s) a range of local and nationally known businesses”, “Suitable locations are generally easily accessible from major roads”, and “provide a limited range of commercial services to motorists”.
 - C. The Comprehensive Plan (Last Updated 2004) mentions the Hamlet of Lakeville briefly and mentions the “lack of adequate pedestrian accommodations”, “inadequate parking for businesses”, and “excessive number of curb cuts and lack of roadway definition”. This project will have pedestrian access into the site which is not seen throughout the surrounding area & the hamlet. The property already has an existing private road of Route 20a (Big Tree Road) which is already utilized by the office park. This project will not add additional curb cuts of Route 20a which will allow for better roadway definition per the comprehensive plan. Lastly, this project will have more than adequate parking. With 30 parking spaces being proposed for this project, this is more than sufficient for the use - the Town of Livonia’s zoning code only requires 15 parking spaces for this use.
 - D. Additional, Genesee Transportation Council developed a “Lakeville Corridor Strategic Plan” which mentions the Capital Improvement Project which discusses different options for better pedestrian & vehicular access within the hamlet. Some of the options discussed in the plan include sidewalks along Route 20a as well as possible left-turning lanes. The project will only benefit from these future improvements as pedestrian access is important to the business and better traffic control increases overall safety within the Hamlet.

2. Yes. The proposed property & use is consistent with other similar commercial uses in the town regarding structures, facilities, and hours of operation. The project is located within an already existing commercial area of the Town and sits within a pre-existing office park which also encompasses a restaurant, a motel and a tavern across the street. Also, there is no residential zoning or properties that abut the projects site. Thus, there will be no adverse effects to neighboring properties, the character of the neighborhood, public health, or general welfare. Lastly, as previously mentioned there is more than adequate space for parking, utilities, and traffic flow at the property.
3. Yes. The proposed project will complete the last phase of development for the "Lakeville Office Park". The building & use will be constructed, arranged, and operated to seamlessly flow with the existing properties/buildings surrounding the project site. Furthermore, the project meets all requirements within the development standards for the GC District.
4. Yes. There are adequate public facilities and services at the site for the proposed Byrne Dairy project.
5. Yes. The proposed buildings & use complies with (or will comply with) additional standards imposed by Section 150-65 within the Town of Livonia's zoning code.
6. Yes. The proposed project intends to have no adverse effects on the proposed buildings or use of the vicinity. The building design, overall site layout, internal traffic flow, landscape, & screening are to ensure a positive impact of the immediate surrounding area, customers, neighbors, the Hamlet of Lakeville, and the Town of Livonia, NY.
7. No. A performance bond or other financial guaranty is not necessary for this project.



Livonia Byrne Dairy Project
Letter of Intent
0 Big Tree Rd Lakeville, NY 14480
(County of Livingston)

Sonbyrne Sales, Inc. would like to construct and operate a new Byrne Dairy Retail Store and Fueling Facility located at the intersection of Big Tree Road (NY-20A) & Thomas Drive in the Town of Livonia, NY. The parcel is approximately 2.72+/- acres with 321'+/- of frontage along Big Tree Rd & 195'+/- of frontage on Thomas Dr. The site is currently vacant and was previously a drive-in movie theater 30+ years ago. The new store will be 4,968+/- sq. ft. (46' Wide x 108' Long, 24' High) and will have porches (9' overhang) attached to the South and West side of the main building. The building is wood frame construction with masonry siding and a metal roof. A freestanding fuel canopy will have four (4) fuel pumps, eight (8) fueling positions, and is 24' Wide x 104' Long. The site has existing Public Water and Public Sewer available. The site will have two (2) curb-cuts (driveways) – One (1) off Thomas Dr and one (1) off the existing ROW that is utilized by the other properties within the larger development / “business park”. The store will operate 24 hours per day/365 days per year. An outside, screened dumpster enclosure will be used for refuse and recycling removal. LED and “Dark Sky” approved lighting will be used for ALL exterior site lighting and fuel canopy lighting. The operation will employ more than twenty-five (25) employees or approximately sixteen (16) +/- full-time equivalent employees. The site is currently zoned (GC) Gateway Commercial.

Date: 9-22-25

Christian Brunelle – Sonbyrne Sales Inc.



Sonbyrne Sales, Inc.

Proposed Livonia
Byrne Dairy Store
Town of Livonia, NY



Existing Site

0 Big Tree Rd, Livonia, NY 14487



PROPOSED LIVONIA BYRNE DAIRY



PROPOSED FUEL CANOPY

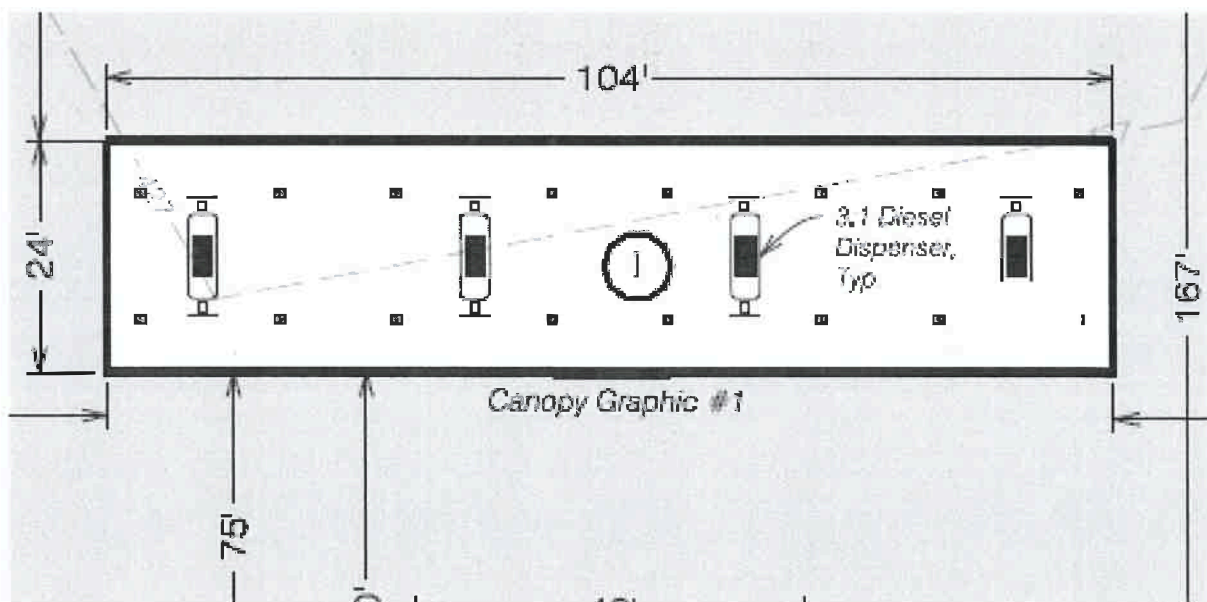



Inside Store

Coffee Bar

Produce Table



Made To Order
Fresh Sandwiches,
Subs, and Salads



Inside Store

Full line of
Groceries

Hot and Fresh
Meal Options



Dairy Case and Frozen
Foods

Flush Parking Bollards



Dumpster Enclosure

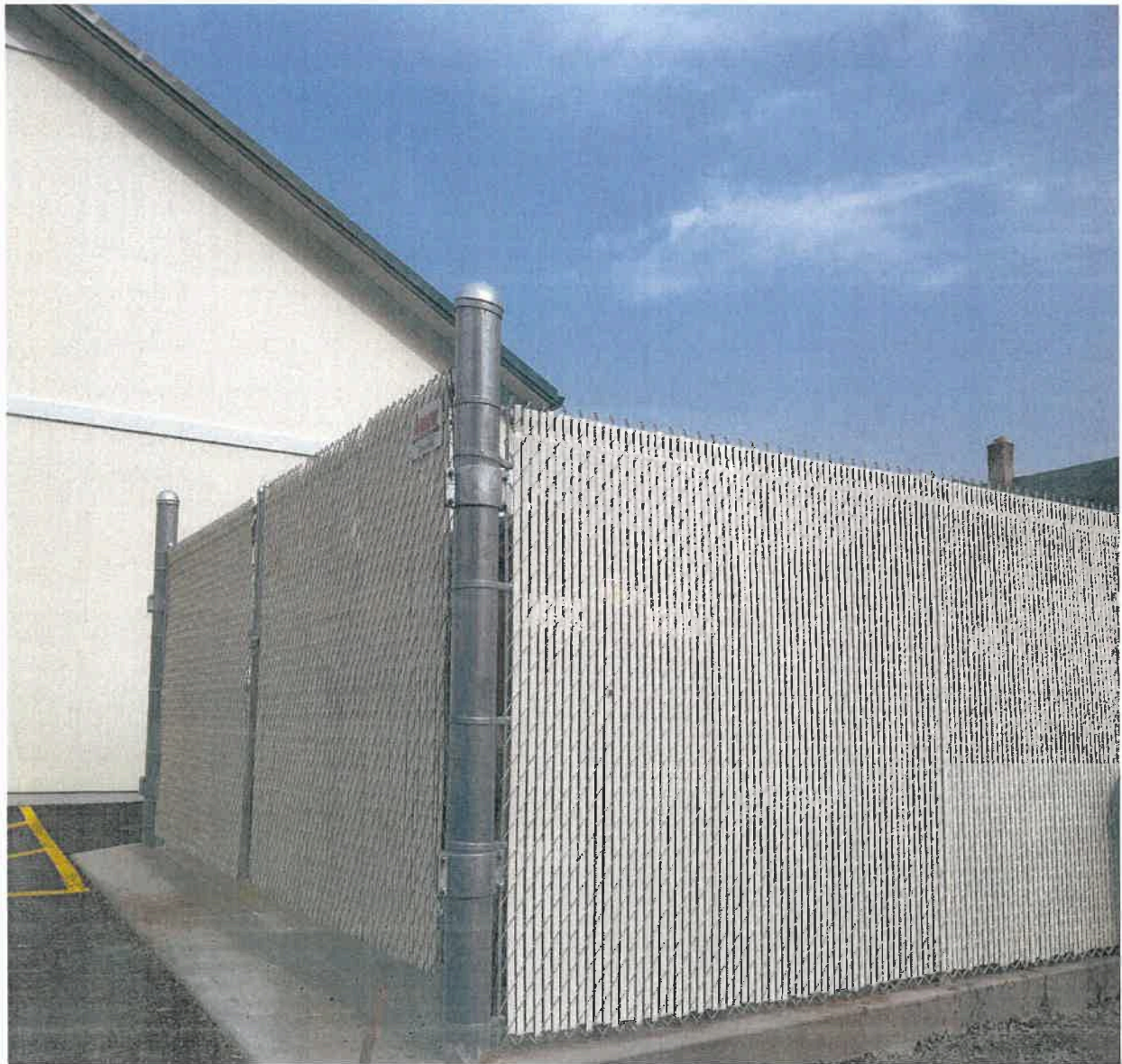

Livonia Byrne Dairy Signage Package

#1

Monument Sign:

Size 48 sq ft

Height: 5'

Internally Illuminated

#2 & #3

Wall/Facade Sign:

3'6"x 14'

Size 49 sq ft

Internally Illuminated

#4

Canopy Graphic

16 sq ft

Vinyl (Non-Illuminated)

Location: South & West side of Canopy

Sign #1

Monument Sign
Internally Illuminated
Size: 48 sq ft Height: 5'



*Not to scale—subject to change

Sign #2 & 3

Building Signs on Retail Store

3'6"x 14' = 49 sq ft.

Internally Illuminated

Location: South & West sides of
Building



Sign #4

Canopy Graphics Awning Sign

2' x 8' = 16 sq. ft.

16" Lettering

Vinyl -Non-Illuminated

Location: South & West sides of Canopy

Long side 104 feet (X2)



Long side 104 feet (left side)



Long side 104 feet (center)



Long side 104 feet (right side)



Short side 24 feet



Short side 24 feet



16 sq ft

Livonia Byrne Dairy Lighting Package

1. Yard Lights - TBD' Pole Mount
Lithonia Lighting LED Fixture
IDA Approved "Dark Sky Friendly"
2. Wall Lights - 9' Mounting Height
Lithonia Lighting LED Fixture
IDA Approved "Dark Sky Friendly"
3. Fuel & Diesel Canopy Lights— Recessed
Lithonia Lighting LED Fixture
IDA Approved "Dark Sky Friendly"

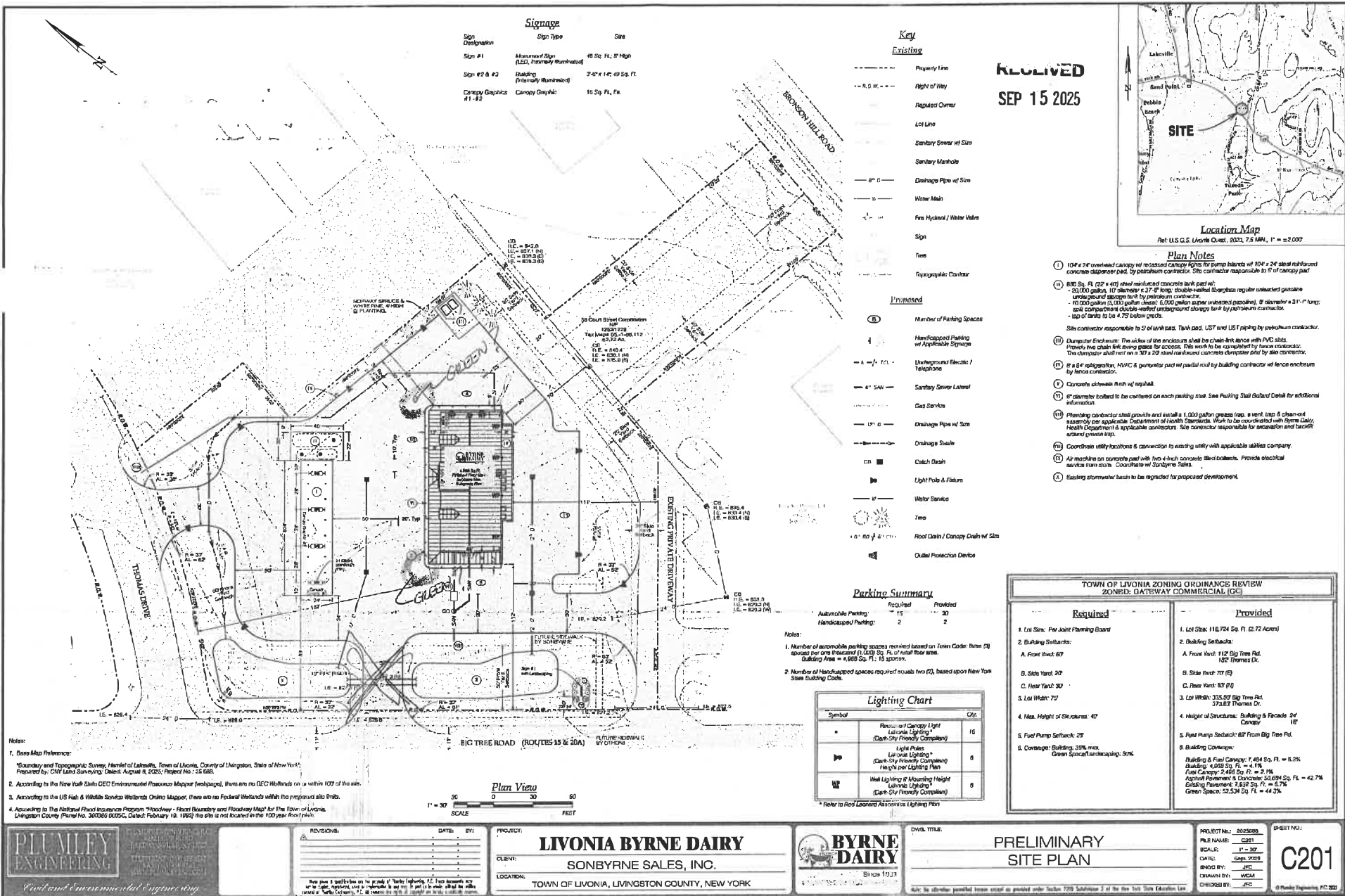

Signage

Sign Designation	Sign Type	Size
Sign #1	Monument Sign (LED, Intensely Illuminated)	48 Sq. Ft., 8' High
Sign #2 & #3	Building (Intensely Illuminated)	2'-0" x 1'-0" 49 Sq. Ft.
Canopy Graphics #1 - #2	Canopy Graphic	16 Sq. Ft. Ea.

Key

Existing

- Property Line
- R.O.W.
- Right of Way
- Regulated Owner
- Lot Line
- Sanitary Sewer w/ Slope
- Sanitary Manhole
- Drainage Pipe w/ Slope
- Water Main
- Fire Hydrant / Water Valve
- Sign
- Fence
- Topographic Contour

Proposed

- Number of Parking Spaces
- Handicapped Parking w/ Applicable Signage
- Background Electric / Telephone
- Sanitary Sewer Lateral
- Gas Service
- Drainage Pipe w/ Slope
- Drainage Sheds
- Catch Basin
- Light Pole & Fixture
- Water Service
- Tree
- Road Drain / Canopy Drain w/ Slope
- Outlet Protection Device

REVOLVED
SEP 15 2025

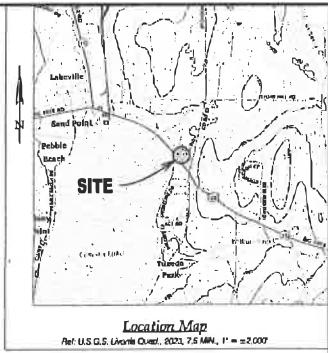

- Plan Notes**
- 10' x 2' overhead canopy w/ recessed canopy lights for pump islands w/ 10' x 2' steel reinforced concrete dispenser pad, by petroleum contractor. Site contractor responsible to 5' of canopy pad.
 - 880 Sq. Ft. (20' x 40') steel reinforced concrete tank pad w/ 50,000 gallon, 10' diameter x 27' 8" long, double-walled boron regular unmarked gasoline underground storage tank by petroleum contractor.
 - 10,000 gallon (3,000 gallon diesel, 6,000 gallon gasoline unmarked gasoline), 8' diameter x 21'-1" long, split compartment double-walled underground storage tank by petroleum contractor.
 - Top of tanks to be 4.75' below grade.
 - Site contractor responsible to 5' of work pad. Tank pad, UST and UST piping by petroleum contractor.
 - Dumpster Enclosure: The sides of the enclosure shall be chain-link fence with PVC slats. Protect the chain-link fence for access. This work to be completed by fence contractor. The dumpster shall rest on a 30' x 20' steel reinforced concrete dispenser pad by site contractor.
 - 8' x 6' signposts, HVAC & petroleum pad w/ partial roof by building contractor w/ fence enclosure by fence contractor.
 - Concrete sidewalk flush w/ topsoil.
 - 8' diameter bollard to be centered on each parking stall. See Parking Stall Bordered Detail for additional information.
 - Planting contractor shall provide and install a 1,000 gallon grass tree, a vent cap & clean-out assembly per applicable Department of Health Standards. Work to be coordinated with Byrre Dairy, Health Department & applicable contractors. Site contractor responsible for excavation and backfill around grass tree.
 - Coordinate utility locations & connection to existing utility with applicable utility company.
 - Air machine on concrete pad with two 4-inch concrete steel bollards. Provide electrical service from site. Coordinate w/ Sonbyrne Sales.
 - Existing stormwater basin to be replaced for proposed development.

Parking Summary

	Required	Provided
Automobile Parking	15	30
Handicapped Parking	2	2

- Notes**
1. Number of automobile parking spaces provided based on Town Code: three (3) spaces per one thousand (1,000) Sq. Ft. of initial floor area. Building Area = 4,669 Sq. Ft. 15 spaces.
 2. Number of Handicapped spaces required equals two (2), based upon New York State Building Code.

Lighting Chart

Symbol	Qty.
Revolved Canopy Light (Dark-Sky Friendly Compliance)	15
Light Pole (Dark-Sky Friendly Compliance) Height per Lighting Plan	6
Wall Lighting & Mounting Height (Dark-Sky Friendly Compliance)	6

* Refer to Red Leaned Associates Lighting Plan

TOWN OF LIVONIA ZONING ORDINANCE REVIEW
ZONED: GATEWAY COMMERCIAL (GC)

Required	Provided
1. Lot Size: Per Joint Planning Board	1. Lot Size: 118,754 Sq. Ft. (2.72 Acres)
2. Building Setbacks: A. Front Yard: 60' B. Side Yard: 20' C. Rear Yard: 30' D. Lot Width: 75'	2. Building Setbacks: A. Front Yard: 112' Big Tree Rd. 125' Thomas Rd. B. Side Yard: 70' (5) C. Rear Yard: 87' (0) 3. Lot Width: 315.92' Big Tree Rd. 373.87' Thomas Rd.
4. Max. Height of Structures: 40'	4. Height of Structures: Building & Paved 30' Canopy 18'
5. Fuel Pump Setback: 25'	5. Fuel Pump Setback: 60' From Big Tree Rd.
6. Coverage: Building: 33% max. Green Space/Landscaping: 50%	6. Building Coverage: Building & Fuel Canopy: 1,454 Sq. Ft. = 8.3% Building: 4,089 Sq. Ft. = 4.1% Fuel Canopy: 2,469 Sq. Ft. = 2.1% Agri Horticulture & Concrete: 52,094 Sq. Ft. = 42.7% Grass: 7,632 Sq. Ft. = 6.7% Green Space: 52,534 Sq. Ft. = 44.3%

- Notes:**
1. Base Map Reference:
"Secondary and Topographic Survey, Hamlet of Lehigh Valley, Town of Lehigh, County of Lehigh, State of New York," Prepared by CH2M Hill Surveying, dated August 18, 2023; Project No.: 25 088.
 2. According to the New York State DEC Environmental Resource Mapper (webpage), there are no DEC Wetlands on or within 100' of this site.
 3. According to the US Fish & Wildlife Service Wetlands Online Mapper, there are no Federal Wetlands within the proposed site limits.
 4. According to the National Flood Insurance Program "Floodway - Flood Boundary and Floodway Map" for The Town of Lehigh, Livingston County (Panel No. 300265 00050, dated February 19, 1992) the site is not located in the 100 year flood plain.



PLUMLEY ENGINEERING
Civil and Environmental Engineering

REVISIONS:

DATE	BY

PROJECT: **LIVONIA BYRNE DAIRY**
SONBYRNE SALES, INC.
LOCATION: TOWN OF LIVONIA, LIVINGSTON COUNTY, NEW YORK

BYRNE DAIRY
Since 1913

DWG. TITLE: **PRELIMINARY SITE PLAN**

PROJECT NO.: 2025088
FILE NAME: C201
SCALE: 1" = 30'
DATE: Sept. 2025
DRAWN BY: JFC
CHECKED BY: JFC

IPSET NO.: **C201**
© Plumley Engineering, P.C. 2025

Full Environmental Assessment Form
Part 1 - Project and Setting

REVISED
OCT 06 2025

Instructions for Completing Part 1

Part 1 is to be completed by the applicant or project sponsor. Responses become part of the application for approval or funding, are subject to public review, and may be subject to further verification.

Complete Part 1 based on information currently available. If additional research or investigation would be needed to fully respond to any item, please answer as thoroughly as possible based on current information; indicate whether missing information does not exist, or is not reasonably available to the sponsor; and, when possible, generally describe work or studies which would be necessary to update or fully develop that information.

Applicants/sponsors must complete all items in Sections A & B. In Sections C, D & E, most items contain an initial question that must be answered either "Yes" or "No". If the answer to the initial question is "Yes", complete the sub-questions that follow. If the answer to the initial question is "No", proceed to the next question. Section F allows the project sponsor to identify and attach any additional information. Section G requires the name and signature of the applicant or project sponsor to verify that the information contained in Part 1 is accurate and complete.

A. Project and Applicant/Sponsor Information.

Name of Action or Project: Livonia Byrne Dairy: Town/Village of Livonia Joint Planning Board - Site Plan Approval/Conditional Permit		
Project Location (describe, and attach a general location map): Big Tree Road, Town of Livonia, [Tax Map #65.-1-66.112]		
Brief Description of Proposed Action (include purpose or need): This project involves the construction of a 4,968 square foot convenience store and gasoline fueling facilities (4 fueling dispensers) along with associated parking, utilities, landscaping, and stormwater management system/		
Name of Applicant/Sponsor: Sonbyrne Sales, Inc. Attn: Christian Brunelle	Telephone: (315) 214-6455 Ext. 502 E-Mail: christian.brunelle@byrnedairy.com	
Address: 171 Route 5 West		
City/PO: Weedsport	State: NY	Zip Code: 13166
Project Contact (if not same as sponsor; give name and title/role): Julian Clark, P.E. w/ Plumley Engineering, P.C.	Telephone: (315) 638-8587 E-Mail: jclark@plumleyeng.com	
Address: 8232 Loop Road		
City/PO: Baldwinsville	State: NY	Zip Code: 13027.
Property Owner (if not same as sponsor):	Telephone: E-Mail:	
Address:		
City/PO:	State:	Zip Code:

B. Government Approvals

B. Government Approvals, Funding, or Sponsorship. ("Funding" includes grants, loans, tax relief, and any other forms of financial assistance.)

Government Entity	If Yes: Identify Agency and Approval(s) Required	Application Date (Actual or projected)
a. City Counsel, Town Board, <input type="checkbox"/> Yes <input checked="" type="checkbox"/> No or Village Board of Trustees		
b. City, Town or Village <input checked="" type="checkbox"/> Yes <input type="checkbox"/> No Planning Board or Commission	Town/Village Joint Planning Board - Site Plan Approval & Conditional Permit	Sept. 2025
c. City, Town or <input type="checkbox"/> Yes <input checked="" type="checkbox"/> No Village Zoning Board of Appeals		
d. Other local agencies <input type="checkbox"/> Yes <input checked="" type="checkbox"/> No		
e. County agencies <input checked="" type="checkbox"/> Yes <input type="checkbox"/> No	Livingston County Water and Sewage Authority - Backflow Prevention Program	
f. Regional agencies <input type="checkbox"/> Yes <input checked="" type="checkbox"/> No		
g. State agencies <input checked="" type="checkbox"/> Yes <input type="checkbox"/> No	NYSDEC SPDES Stormwater Discharge & PBS Registration	
h. Federal agencies <input type="checkbox"/> Yes <input checked="" type="checkbox"/> No		
i. Coastal Resources.		
i. Is the project site within a Coastal Area, or the waterfront area of a Designated Inland Waterway?		<input type="checkbox"/> Yes <input checked="" type="checkbox"/> No
ii. Is the project site located in a community with an approved Local Waterfront Revitalization Program?		<input type="checkbox"/> Yes <input checked="" type="checkbox"/> No
iii. Is the project site within a Coastal Erosion Hazard Area?		<input type="checkbox"/> Yes <input checked="" type="checkbox"/> No

C. Planning and Zoning

C.1. Planning and zoning actions.

Will administrative or legislative adoption, or amendment of a plan, local law, ordinance, rule or regulation be the only approval(s) which must be granted to enable the proposed action to proceed? ☐ Yes ☒ No

- If Yes, complete sections C, F and G.
- If No, proceed to question C.2 and complete all remaining sections and questions in Part I

C.2. Adopted land use plans.

a. Do any municipally- adopted (city, town, village or county) comprehensive land use plan(s) include the site where the proposed action would be located? ☐ Yes ☒ No

If Yes, does the comprehensive plan include specific recommendations for the site where the proposed action would be located? ☐ Yes ☒ No

b. Is the site of the proposed action within any local or regional special planning district (for example: Greenway; Brownfield Opportunity Area (BOA); designated State or Federal heritage area; watershed management plan; or other?) ☐ Yes ☒ No

If Yes, identify the plan(s):

c. Is the proposed action located wholly or partially within an area listed in an adopted municipal open space plan, or an adopted municipal farmland protection plan? ☐ Yes ☒ No

If Yes, identify the plan(s):

C.3. Zoning

a. Is the site of the proposed action located in a municipality with an adopted zoning law or ordinance. ☒ Yes ☐ No

If Yes, what is the zoning classification(s) including any applicable overlay district?

Gateway Commercial - GC

b. Is the use permitted or allowed by a special or conditional use permit? ☒ Yes ☐ No

c. Is a zoning change requested as part of the proposed action? ☐ Yes ☒ No

If Yes,

i. What is the proposed new zoning for the site? _____

C.4. Existing community services.

a. In what school district is the project site located? Livonia School District

b. What police or other public protection forces serve the project site?

Livingston Co. Sheriff

c. Which fire protection and emergency medical services serve the project site?

Livonia Fire Dept.

d. What parks serve the project site?

Vitale Park

D. Project Details

D.1. Proposed and Potential Development

a. What is the general nature of the proposed action (e.g., residential, industrial, commercial, recreational; if mixed, include all components)? Commercial

b. a. Total acreage of the site of the proposed action? ±2.72 acres

b. Total acreage to be physically disturbed? ±2.25 acres

c. Total acreage (project site and any contiguous properties) owned or controlled by the applicant or project sponsor? ±2.72 acres

c. Is the proposed action an expansion of an existing project or use? ☐ Yes ☒ No

i. If Yes, what is the approximate percentage of the proposed expansion and identify the units (e.g., acres, miles, housing units, square feet)? % _____ Units: _____

d. Is the proposed action a subdivision, or does it include a subdivision? ☐ Yes ☒ No

If Yes,

i. Purpose or type of subdivision? (e.g., residential, industrial, commercial; if mixed, specify types) _____

ii. Is a cluster/conservation layout proposed? ☐ Yes ☒ No

iii. Number of lots proposed? _____

iv. Minimum and maximum proposed lot sizes? Minimum _____ Maximum _____

e. Will the proposed action be constructed in multiple phases? ☐ Yes ☒ No

i. If No, anticipated period of construction: 4 months

ii. If Yes:

- Total number of phases anticipated _____
- Anticipated commencement date of phase 1 (including demolition) _____ month _____ year
- Anticipated completion date of final phase _____ month _____ year
- Generally describe connections or relationships among phases, including any contingencies where progress of one phase may determine timing or duration of future phases: _____

f. Does the project include new residential uses? <input type="checkbox"/> Yes <input checked="" type="checkbox"/> No If Yes, show numbers of units proposed.				
	<u>One Family</u>	<u>Two Family</u>	<u>Three Family</u>	<u>Multiple Family (four or more)</u>
Initial Phase	_____	_____	_____	_____
At completion	_____	_____	_____	_____
of all phases	_____	_____	_____	_____

g. Does the proposed action include new non-residential construction (including expansions)? <input checked="" type="checkbox"/> Yes <input type="checkbox"/> No If Yes,	
i. Total number of structures <u>1</u> ii. Dimensions (in feet) of largest proposed structure: <u>±24'</u> height; <u>55'</u> width; and <u>132'</u> length [Includes Porch on Store] iii. Approximate extent of building space to be heated or cooled: <u>4,968</u> square feet	

h. Does the proposed action include construction or other activities that will result in the impoundment of any liquids, such as creation of a water supply, reservoir, pond, lake, waste lagoon or other storage? <input checked="" type="checkbox"/> Yes <input type="checkbox"/> No If Yes,	
i. Purpose of the impoundment: <u>Stormwater management</u> ii. If a water impoundment, the principal source of the water: <input type="checkbox"/> Ground water <input type="checkbox"/> Surface water streams <input checked="" type="checkbox"/> Other specify: <u>Stormwater runoff</u> iii. If other than water, identify the type of impounded/contained liquids and their source. _____ iv. Approximate size of the proposed impoundment. Volume: <u>TBD</u> million gallons; surface area: _____ acres v. Dimensions of the proposed dam or impounding structure: <u>TBD</u> height; <u>TBD</u> length vi. Construction method/materials for the proposed dam or impounding structure (e.g., earth fill, rock, wood, concrete): <u>Earth Fill</u>	

D.2. Project Operations

a. Does the proposed action include any excavation, mining, or dredging, during construction, operations, or both? (Not including general site preparation, grading or installation of utilities or foundations where all excavated materials will remain onsite) <input type="checkbox"/> Yes <input checked="" type="checkbox"/> No If Yes:	
i. What is the purpose of the excavation or dredging? _____ ii. How much material (including rock, earth, sediments, etc.) is proposed to be removed from the site? • Volume (specify tons or cubic yards): _____ • Over what duration of time? _____ iii. Describe nature and characteristics of materials to be excavated or dredged, and plans to use, manage or dispose of them. _____ _____ iv. Will there be onsite dewatering or processing of excavated materials? <input type="checkbox"/> Yes <input type="checkbox"/> No If yes, describe. _____ _____ v. What is the total area to be dredged or excavated? _____ acres vi. What is the maximum area to be worked at any one time? _____ acres vii. What would be the maximum depth of excavation or dredging? _____ feet viii. Will the excavation require blasting? <input type="checkbox"/> Yes <input type="checkbox"/> No ix. Summarize site reclamation goals and plan: _____ _____ _____	

b. Would the proposed action cause or result in alteration of, increase or decrease in size of, or encroachment into any existing wetland, waterbody, shoreline, beach or adjacent area? <input type="checkbox"/> Yes <input checked="" type="checkbox"/> No If Yes:	
i. Identify the wetland or waterbody which would be affected (by name, water index number, wetland map number or geographic description): _____ _____ _____	

ii. Describe how the proposed action would affect that waterbody or wetland, e.g. excavation, fill, placement of structures, or alteration of channels, banks and shorelines. Indicate extent of activities, alterations and additions in square feet or acres:

iii. Will the proposed action cause or result in disturbance to bottom sediments? ☐ Yes ☐ No
If Yes, describe: _____

iv. Will the proposed action cause or result in the destruction or removal of aquatic vegetation? ☐ Yes ☐ No
If Yes:

- acres of aquatic vegetation proposed to be removed: _____
- expected acreage of aquatic vegetation remaining after project completion: _____
- purpose of proposed removal (e.g. beach clearing, invasive species control, boat access): _____
- proposed method of plant removal: _____
- if chemical/herbicide treatment will be used, specify product(s): _____

v. Describe any proposed reclamation/mitigation following disturbance: _____

c. Will the proposed action use, or create a new demand for water? ☒ Yes ☐ No
If Yes:

i. Total anticipated water usage/demand per day: _____ 1,500 gallons/day

ii. Will the proposed action obtain water from an existing public water supply? ☒ Yes ☐ No
If Yes:

- Name of district or service area: Livingston County Water and Sewer Authority
- Does the existing public water supply have capacity to serve the proposal? ☒ Yes ☐ No
- Is the project site in the existing district? ☒ Yes ☐ No
- Is expansion of the district needed? ☐ Yes ☒ No
- Do existing lines serve the project site? ☒ Yes ☐ No

iii. Will line extension within an existing district be necessary to supply the project? ☐ Yes ☒ No
If Yes:

- Describe extensions or capacity expansions proposed to serve this project: _____
- Source(s) of supply for the district: _____

iv. Is a new water supply district or service area proposed to be formed to serve the project site? ☐ Yes ☒ No
If, Yes:

- Applicant/sponsor for new district: _____
- Date application submitted or anticipated: _____
- Proposed source(s) of supply for new district: _____

v. If a public water supply will not be used, describe plans to provide water supply for the project: _____

vi. If water supply will be from wells (public or private), what is the maximum pumping capacity: _____ gallons/minute.

d. Will the proposed action generate liquid wastes? ☒ Yes ☐ No
If Yes:

i. Total anticipated liquid waste generation per day: _____ 1,500 gallons/day

ii. Nature of liquid wastes to be generated (e.g., sanitary wastewater, industrial; if combination, describe all components and approximate volumes or proportions of each): _____
Sanitary Wastewater

iii. Will the proposed action use any existing public wastewater treatment facilities? ☒ Yes ☐ No
If Yes:

- Name of wastewater treatment plant to be used: _____
- Name of district: County Sewer
- Does the existing wastewater treatment plant have capacity to serve the project? ☒ Yes ☐ No
- Is the project site in the existing district? ☒ Yes ☐ No
- Is expansion of the district needed? ☐ Yes ☒ No

<ul style="list-style-type: none"> • Do existing sewer lines serve the project site? • Will a line extension within an existing district be necessary to serve the project? <p>If Yes:</p> <ul style="list-style-type: none"> • Describe extensions or capacity expansions proposed to serve this project: _____ 	<input checked="" type="checkbox"/> Yes <input type="checkbox"/> No <input type="checkbox"/> Yes <input checked="" type="checkbox"/> No
<p>iv. Will a new wastewater (sewage) treatment district be formed to serve the project site?</p> <p>If Yes:</p> <ul style="list-style-type: none"> • Applicant/sponsor for new district: _____ • Date application submitted or anticipated: _____ • What is the receiving water for the wastewater discharge? _____ 	<input type="checkbox"/> Yes <input checked="" type="checkbox"/> No
<p>v. If public facilities will not be used, describe plans to provide wastewater treatment for the project, including specifying proposed receiving water (name and classification if surface discharge or describe subsurface disposal plans):</p> <p>_____</p> <p>_____</p>	
<p>vi. Describe any plans or designs to capture, recycle or reuse liquid waste: _____</p> <p>_____</p> <p>_____</p>	
<p>e. Will the proposed action disturb more than one acre and create stormwater runoff, either from new point sources (i.e. ditches, pipes, swales, curbs, gutters or other concentrated flows of stormwater) or non-point source (i.e. sheet flow) during construction or post construction?</p> <p>If Yes:</p> <p>i. How much impervious surface will the project create in relation to total size of project parcel?</p> <p style="margin-left: 40px;">_____ Square feet or <u>±1.47</u> acres (impervious surface)</p> <p style="margin-left: 40px;">_____ Square feet or <u>2.723</u> acres (parcel size)</p> <p>ii. Describe types of new point sources. <u>storm sewer system</u></p>	<input checked="" type="checkbox"/> Yes <input type="checkbox"/> No
<p>iii. Where will the stormwater runoff be directed (i.e. on-site stormwater management facility/structures, adjacent properties, groundwater, on-site surface water or off-site surface waters)?</p> <p><u>street drainage system</u></p> <p>_____</p> <ul style="list-style-type: none"> • If to surface waters, identify receiving water bodies or wetlands: _____ <p>_____</p> <ul style="list-style-type: none"> • Will stormwater runoff flow to adjacent properties? <input type="checkbox"/> Yes <input checked="" type="checkbox"/> No 	
<p>iv. Does the proposed plan minimize impervious surfaces, use pervious materials or collect and re-use stormwater? <input checked="" type="checkbox"/> Yes <input type="checkbox"/> No</p>	
<p>f. Does the proposed action include, or will it use on-site, one or more sources of air emissions, including fuel combustion, waste incineration, or other processes or operations?</p> <p>If Yes, identify:</p> <p>i. Mobile sources during project operations (e.g., heavy equipment, fleet or delivery vehicles)</p> <p>_____</p> <p>ii. Stationary sources during construction (e.g., power generation, structural heating, batch plant, crushers)</p> <p>_____</p> <p>iii. Stationary sources during operations (e.g., process emissions, large boilers, electric generation)</p> <p>_____</p>	<input type="checkbox"/> Yes <input checked="" type="checkbox"/> No
<p>g. Will any air emission sources named in D.2.f (above), require a NY State Air Registration, Air Facility Permit, or Federal Clean Air Act Title IV or Title V Permit? <input type="checkbox"/> Yes <input checked="" type="checkbox"/> No</p> <p>If Yes:</p> <p>i. Is the project site located in an Air quality non-attainment area? (Area routinely or periodically fails to meet ambient air quality standards for all or some parts of the year) <input type="checkbox"/> Yes <input type="checkbox"/> No</p> <p>ii. In addition to emissions as calculated in the application, the project will generate:</p> <ul style="list-style-type: none"> • _____ Tons/year (short tons) of Carbon Dioxide (CO₂) • _____ Tons/year (short tons) of Nitrous Oxide (N₂O) • _____ Tons/year (short tons) of Perfluorocarbons (PFCs) • _____ Tons/year (short tons) of Sulfur Hexafluoride (SF₆) • _____ Tons/year (short tons) of Carbon Dioxide equivalent of Hydrofluorocarbons (HFCs) • _____ Tons/year (short tons) of Hazardous Air Pollutants (HAPs) 	

h. Will the proposed action generate or emit methane (including, but not limited to, sewage treatment plants, landfills, composting facilities)? ☐ Yes ☒ No

If Yes:

i. Estimate methane generation in tons/year (metric): _____

ii. Describe any methane capture, control or elimination measures included in project design (e.g., combustion to generate heat or electricity, flaring): _____

i. Will the proposed action result in the release of air pollutants from open-air operations or processes, such as quarry or landfill operations? ☐ Yes ☒ No

If Yes: Describe operations and nature of emissions (e.g., diesel exhaust, rock particulates/dust): _____

j. Will the proposed action result in a substantial increase in traffic above present levels or generate substantial new demand for transportation facilities or services? ☐ Yes ☒ No

If Yes:

i. When is the peak traffic expected (Check all that apply): ☐ Morning ☐ Evening ☐ Weekend
☐ Randomly between hours of _____ to _____.

ii. For commercial activities only, projected number of truck trips/day and type (e.g., semi trailers and dump trucks): _____

iii. Parking spaces: Existing _____ Proposed _____ Net increase/decrease _____

iv. Does the proposed action include any shared use parking? ☐ Yes ☐ No

v. If the proposed action includes any modification of existing roads, creation of new roads or change in existing access, describe: _____

vi. Are public/private transportation service(s) or facilities available within ½ mile of the proposed site? ☐ Yes ☐ No

vii. Will the proposed action include access to public transportation or accommodations for use of hybrid, electric or other alternative fueled vehicles? ☐ Yes ☐ No

viii. Will the proposed action include plans for pedestrian or bicycle accommodations for connections to existing pedestrian or bicycle routes? ☐ Yes ☐ No

k. Will the proposed action (for commercial or industrial projects only) generate new or additional demand for energy? ☒ Yes ☐ No

If Yes:

i. Estimate annual electricity demand during operation of the proposed action: _____
300,000 KWH

ii. Anticipated sources/suppliers of electricity for the project (e.g., on-site combustion, on-site renewable, via grid/local utility, or other):
National Grid

iii. Will the proposed action require a new, or an upgrade, to an existing substation? ☐ Yes ☒ No

l. Hours of operation. Answer all items which apply.

i. During Construction:	ii. During Operations:
• Monday - Friday: _____ 7 to 6	• Monday - Friday: _____ 24 hours
• Saturday: _____ 8 to 4	• Saturday: _____ 24 hours
• Sunday: _____ n/a	• Sunday: _____ 24 hours
• Holidays: _____ n/a	• Holidays: _____ 24 hours

<p>m. Will the proposed action produce noise that will exceed existing ambient noise levels during construction, operation, or both? <input type="checkbox"/> Yes <input checked="" type="checkbox"/> No</p> <p>If yes:</p> <p>i. Provide details including sources, time of day and duration:</p> <p>_____</p>	
<p>ii. Will the proposed action remove existing natural barriers that could act as a noise barrier or screen? <input type="checkbox"/> Yes <input type="checkbox"/> No</p> <p>Describe: _____</p> <p>_____</p>	
<p>n. Will the proposed action have outdoor lighting? <input checked="" type="checkbox"/> Yes <input type="checkbox"/> No</p> <p>If yes:</p> <p>i. Describe source(s), location(s), height of fixture(s), direction/aim, and proximity to nearest occupied structures:</p> <p>_____</p>	
<p>ii. Will proposed action remove existing natural barriers that could act as a light barrier or screen? <input type="checkbox"/> Yes <input checked="" type="checkbox"/> No</p> <p>Describe: _____</p> <p>_____</p>	
<p>o. Does the proposed action have the potential to produce odors for more than one hour per day? <input type="checkbox"/> Yes <input checked="" type="checkbox"/> No</p> <p>If Yes, describe possible sources, potential frequency and duration of odor emissions, and proximity to nearest occupied structures:</p> <p>_____</p> <p>_____</p>	
<p>p. Will the proposed action include any bulk storage of petroleum (combined capacity of over 1,100 gallons) or chemical products 185 gallons in above ground storage or any amount in underground storage? <input checked="" type="checkbox"/> Yes <input type="checkbox"/> No</p> <p>If Yes:</p> <p>i. Product(s) to be stored <u>Petroleum Fuel</u></p> <p>ii. Volume(s) <u>30,000 gal per unit time</u> <u>Week</u> (e.g., month, year)</p> <p>iii. Generally, describe the proposed storage facilities:</p> <p><u>Double-Walled Underground Fiberglass Storage Tanks Compliant with State Standards</u></p>	
<p>q. Will the proposed action (commercial, industrial and recreational projects only) use pesticides (i.e., herbicides, insecticides) during construction or operation? <input type="checkbox"/> Yes <input checked="" type="checkbox"/> No</p> <p>If Yes:</p> <p>i. Describe proposed treatment(s):</p> <p>_____</p> <p>_____</p>	
<p>ii. Will the proposed action use Integrated Pest Management Practices? <input type="checkbox"/> Yes <input type="checkbox"/> No</p>	
<p>r. Will the proposed action (commercial or industrial projects only) involve or require the management or disposal of solid waste (excluding hazardous materials)? <input type="checkbox"/> Yes <input checked="" type="checkbox"/> No</p> <p>If Yes:</p> <p>i. Describe any solid waste(s) to be generated during construction or operation of the facility:</p> <ul style="list-style-type: none"> • Construction: _____ < 0.25 tons per _____ month (unit of time) • Operation : _____ < 2 tons per _____ month (unit of time) <p>ii. Describe any proposals for on-site minimization, recycling or reuse of materials to avoid disposal as solid waste:</p> <ul style="list-style-type: none"> • Construction: <u>Recommendations/requirements of CLEAN Recycling Center</u> _____ • Operation: <u>Recommendations/requirements of CLEAN Recycling Center</u> _____ <p>iii. Proposed disposal methods/facilities for solid waste generated on-site:</p> <ul style="list-style-type: none"> • Construction: <u>Livingston Co Solid Waste Dept.</u> _____ • Operation: <u>Livingston Co Solid Waste Dept.</u> _____ 	

s. Does the proposed action include construction or modification of a solid waste management facility? ☐ Yes ☒ No

If Yes:

i. Type of management or handling of waste proposed for the site (e.g., recycling or transfer station, composting, landfill, or other disposal activities): _____

ii. Anticipated rate of disposal/processing:

- _____ Tons/month, if transfer or other non-combustion/thermal treatment, or
- _____ Tons/hour, if combustion or thermal treatment

iii. If landfill, anticipated site life: _____ years

t. Will the proposed action at the site involve the commercial generation, treatment, storage, or disposal of hazardous waste? ☐ Yes ☒ No

If Yes:

i. Name(s) of all hazardous wastes or constituents to be generated, handled or managed at facility: _____

ii. Generally describe processes or activities involving hazardous wastes or constituents: _____

iii. Specify amount to be handled or generated _____ tons/month

iv. Describe any proposals for on-site minimization, recycling or reuse of hazardous constituents: _____

v. Will any hazardous wastes be disposed at an existing offsite hazardous waste facility? ☐ Yes ☐ No

If Yes: provide name and location of facility: _____

If No: describe proposed management of any hazardous wastes which will not be sent to a hazardous waste facility: _____

E. Site and Setting of Proposed Action

E.1. Land uses on and surrounding the project site

a. Existing land uses.

i. Check all uses that occur on, adjoining and near the project site.

- ☐ Urban ☐ Industrial ☒ Commercial ☒ Residential (suburban) ☐ Rural (non-farm)
- ☐ Forest ☐ Agriculture ☐ Aquatic ☐ Other (specify): _____

ii. If mix of uses, generally describe:

b. Land uses and covertypes on the project site.

Land use or Covertype	Current Acreage	Acreage After Project Completion	Change (Acres +/-)
• Roads, buildings, and other paved or impervious surfaces	±0.23	±1.47	+1.24
• Forested	±0.057	±0.057	0
• Meadows, grasslands or brushlands (non-agricultural, including abandoned agricultural)	±2.44	±1.14	-1.27
• Agricultural (includes active orchards, field, greenhouse etc.)	0	0	0
• Surface water features (lakes, ponds, streams, rivers, etc.)	0	0	0
• Wetlands (freshwater or tidal)	0	0	0
• Non-vegetated (bare rock, earth or fill)	0	0	0
• Other Describe: _____			

c. Is the project site presently used by members of the community for public recreation? ☐ Yes ☒ No
i. If Yes: explain: _____

d. Are there any facilities serving children, the elderly, people with disabilities (e.g., schools, hospitals, licensed day care centers, or group homes) within 1500 feet of the project site? ☒ Yes ☐ No
If Yes,
i. Identify Facilities:
Livonia Veterinary Hospital to the northeast. Lakeview Dental Care to northeast

e. Does the project site contain an existing dam? ☐ Yes ☒ No
If Yes:
i. Dimensions of the dam and impoundment:
• Dam height: _____ feet
• Dam length: _____ feet
• Surface area: _____ acres
• Volume impounded: _____ gallons OR acre-feet
ii. Dam's existing hazard classification: _____
iii. Provide date and summarize results of last inspection: _____

f. Has the project site ever been used as a municipal, commercial or industrial solid waste management facility, or does the project site adjoin property which is now, or was at one time, used as a solid waste management facility? ☐ Yes ☒ No
If Yes:
i. Has the facility been formally closed? ☐ Yes ☐ No
• If yes, cite sources/documentation: _____
ii. Describe the location of the project site relative to the boundaries of the solid waste management facility: _____
iii. Describe any development constraints due to the prior solid waste activities: _____

g. Have hazardous wastes been generated, treated and/or disposed of at the site, or does the project site adjoin property which is now or was at one time used to commercially treat, store and/or dispose of hazardous waste? ☐ Yes ☒ No
If Yes:
i. Describe waste(s) handled and waste management activities, including approximate time when activities occurred: _____

h. Potential contamination history. Has there been a reported spill at the proposed project site, or have any remedial actions been conducted at or adjacent to the proposed site? ☐ Yes ☒ No
If Yes:
i. Is any portion of the site listed on the NYSDEC Spills Incidents database or Environmental Site Remediation database? Check all that apply: ☐ Yes ☐ No
☐ Yes – Spills Incidents database Provide DEC ID number(s): _____
☐ Yes – Environmental Site Remediation database Provide DEC ID number(s): _____
☐ Neither database
ii. If site has been subject of RCRA corrective activities, describe control measures: _____
iii. Is the project within 2000 feet of any site in the NYSDEC Environmental Site Remediation database? ☐ Yes ☒ No
If yes, provide DEC ID number(s): _____
iv. If yes to (i), (ii) or (iii) above, describe current status of site(s): _____

v. Is the project site subject to an institutional control limiting property uses? ☐ Yes ☐ No

- If yes, DEC site ID number: _____
- Describe the type of institutional control (e.g., deed restriction or easement): _____
- Describe any use limitations: _____
- Describe any engineering controls: _____
- Will the project affect the institutional or engineering controls in place? ☐ Yes ☐ No
- Explain: _____

E.2. Natural Resources On or Near Project Site

a. What is the average depth to bedrock on the project site? _____ >8 feet

b. Are there bedrock outcroppings on the project site? ☐ Yes ☒ No
If Yes, what proportion of the site is comprised of bedrock outcroppings? _____ %

c. Predominant soil type(s) present on project site:

Udorthents, loamy skeletal	89.9 %
Ontario Loam, 8 to 15%	9.2 %
Odessa silt Loam	0.9 %

d. What is the average depth to the water table on the project site? Average: _____ >4 feet

e. Drainage status of project site soils: ☒ Well Drained: _____ 99.1 % of site
☐ Moderately Well Drained: _____ % of site
☒ Poorly Drained: _____ 0.9 % of site

f. Approximate proportion of proposed action site with slopes: ☒ 0-10%: _____ 100 % of site
☐ 10-15%: _____ % of site
☐ 15% or greater: _____ % of site

g. Are there any unique geologic features on the project site? ☐ Yes ☒ No
If Yes, describe: _____

h. Surface water features.

i. Does any portion of the project site contain wetlands or other waterbodies (including streams, rivers, ponds or lakes)? ☐ Yes ☒ No

ii. Do any wetlands or other waterbodies adjoin the project site? ☒ Yes ☐ No

If Yes to either i or ii, continue. If No, skip to E.2.i.

iii. Are any of the wetlands or waterbodies within or adjoining the project site regulated by any federal, state or local agency? ☒ Yes ☐ No

iv. For each identified regulated wetland and waterbody on the project site, provide the following information:

• Streams:	Name _____	Classification _____
• Lakes or Ponds:	Name _____	Classification _____
• Wetlands:	Name _____	Approximate Size _____
• Wetland No. (if regulated by DEC)	_____	

v. Are any of the above water bodies listed in the most recent compilation of NYS water quality-impaired waterbodies? ☐ Yes ☒ No
If yes, name of impaired water body/bodies and basis for listing as impaired: _____

i. Is the project site in a designated Floodway? ☐ Yes ☒ No

j. Is the project site in the 100-year Floodplain? ☐ Yes ☒ No

k. Is the project site in the 500-year Floodplain? ☐ Yes ☒ No

l. Is the project site located over, or immediately adjoining, a primary, principal or sole source aquifer? ☐ Yes ☒ No
If Yes:
i. Name of aquifer: _____

<p>m. Identify the predominant wildlife species that occupy or use the project site: _____</p> <p>_____</p> <p>_____</p>	
<p>n. Does the project site contain a designated significant natural community? <input type="checkbox"/> Yes <input checked="" type="checkbox"/> No</p> <p>If Yes:</p> <p style="margin-left: 20px;">i. Describe the habitat/community (composition, function, and basis for designation): _____</p> <p style="margin-left: 20px;">ii. Source(s) of description or evaluation: _____</p> <p style="margin-left: 20px;">iii. Extent of community/habitat:</p> <ul style="list-style-type: none"> • Currently: _____ acres • Following completion of project as proposed: _____ acres • Gain or loss (indicate + or -): _____ acres 	
<p>o. Does project site contain any species of plant or animal that is listed by the federal government or NYS as endangered or threatened, or does it contain any areas identified as habitat for an endangered or threatened species? <input type="checkbox"/> Yes <input checked="" type="checkbox"/> No</p> <p>If Yes:</p> <p style="margin-left: 20px;">i. Species and listing (endangered or threatened): _____</p> <p>_____</p> <p>_____</p>	
<p>p. Does the project site contain any species of plant or animal that is listed by NYS as rare, or as a species of special concern? <input type="checkbox"/> Yes <input checked="" type="checkbox"/> No</p> <p>If Yes:</p> <p style="margin-left: 20px;">i. Species and listing: _____</p> <p>_____</p> <p>_____</p>	
<p>q. Is the project site or adjoining area currently used for hunting, trapping, fishing or shell fishing? <input type="checkbox"/> Yes <input checked="" type="checkbox"/> No</p> <p>If yes, give a brief description of how the proposed action may affect that use: _____</p> <p>_____</p>	
<p>E.3. Designated Public Resources On or Near Project Site</p>	
<p>a. Is the project site, or any portion of it, located in a designated agricultural district certified pursuant to Agriculture and Markets Law, Article 25-AA, Section 303 and 304? <input type="checkbox"/> Yes <input checked="" type="checkbox"/> No</p> <p>If Yes, provide county plus district name/number: _____</p>	
<p>b. Are agricultural lands consisting of highly productive soils present? <input type="checkbox"/> Yes <input checked="" type="checkbox"/> No</p> <p style="margin-left: 20px;">i. If Yes: acreage(s) on project site? _____</p> <p style="margin-left: 20px;">ii. Source(s) of soil rating(s): _____</p>	
<p>c. Does the project site contain all or part of, or is it substantially contiguous to, a registered National Natural Landmark? <input type="checkbox"/> Yes <input checked="" type="checkbox"/> No</p> <p>If Yes:</p> <p style="margin-left: 20px;">i. Nature of the natural landmark: <input type="checkbox"/> Biological Community <input type="checkbox"/> Geological Feature</p> <p style="margin-left: 20px;">ii. Provide brief description of landmark, including values behind designation and approximate size/extent: _____</p> <p>_____</p> <p>_____</p>	
<p>d. Is the project site located in or does it adjoin a state listed Critical Environmental Area? <input type="checkbox"/> Yes <input checked="" type="checkbox"/> No</p> <p>If Yes:</p> <p style="margin-left: 20px;">i. CEA name: _____</p> <p style="margin-left: 20px;">ii. Basis for designation: _____</p> <p style="margin-left: 20px;">iii. Designating agency and date: _____</p>	

EAF Mapper Summary Report

Monday, September 29, 2025 10:55 AM

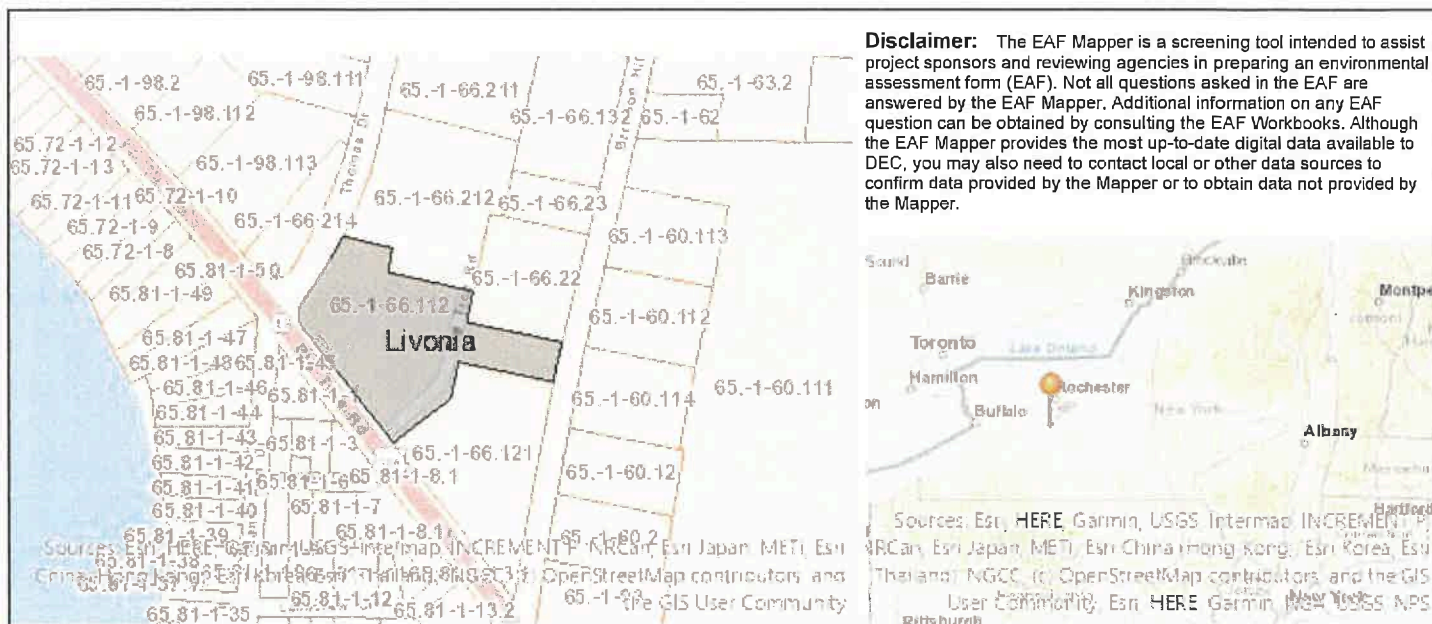

B.i.i [Coastal or Waterfront Area]	No
B.i.ii [Local Waterfront Revitalization Area]	No
C.2.b. [Special Planning District]	Digital mapping data are not available or are incomplete. Refer to EAF Workbook.
E.1.h [DEC Spills or Remediation Site - Potential Contamination History]	Digital mapping data are not available or are incomplete. Refer to EAF Workbook.
E.1.h.i [DEC Spills or Remediation Site - Listed]	Digital mapping data are not available or are incomplete. Refer to EAF Workbook.
E.1.h.i [DEC Spills or Remediation Site - Environmental Site Remediation Database]	Digital mapping data are not available or are incomplete. Refer to EAF Workbook.
E.1.h.iii [Within 2,000' of DEC Remediation Site]	No
E.2.g [Unique Geologic Features]	No
E.2.h.i [Surface Water Features]	Digital mapping data are not available or are incomplete. Refer to EAF Workbook.
E.2.h.ii [Surface Water Features]	Yes - Digital mapping information on local, New York State, and federal wetlands and waterbodies is known to be incomplete. Refer to the EAF Workbook.
E.2.h.iii [Surface Water Features]	Yes - Digital mapping information on local, New York State, and federal wetlands and waterbodies is known to be incomplete. Refer to the EAF Workbook.
E.2.h.v [Impaired Water Bodies]	No
E.2.i. [Floodway]	Digital mapping data are not available or are incomplete. Refer to EAF Workbook.
E.2.j. [100 Year Floodplain]	Digital mapping data are not available or are incomplete. Refer to EAF Workbook.
E.2.k. [500 Year Floodplain]	Digital mapping data are not available or are incomplete. Refer to EAF Workbook.

E.2.l. [Aquifers]	No
E.2.n. [Natural Communities]	No
E.2.o. [Endangered or Threatened Species]	No
E.2.p. [Rare Plants or Animals]	No
E.3.a. [Agricultural District]	No
E.3.c. [National Natural Landmark]	No
E.3.d [Critical Environmental Area]	No
E.3.e. [National or State Register of Historic Places or State Eligible Sites]	Digital mapping data are not available or are incomplete. Refer to EAF Workbook.
E.3.f. [Archeological Sites]	Yes
E.3.i. [Designated River Corridor]	No

Full Environmental Assessment Form
Part 2 - Identification of Potential Project Impacts

Agency Use Only [If applicable]

Project :

Date :

Part 2 is to be completed by the lead agency. Part 2 is designed to help the lead agency inventory all potential resources that could be affected by a proposed project or action. We recognize that the lead agency's reviewer(s) will not necessarily be environmental professionals. So, the questions are designed to walk a reviewer through the assessment process by providing a series of questions that can be answered using the information found in Part 1. To further assist the lead agency in completing Part 2, the form identifies the most relevant questions in Part 1 that will provide the information needed to answer the Part 2 question. When Part 2 is completed, the lead agency will have identified the relevant environmental areas that may be impacted by the proposed activity.

If the lead agency is a state agency **and** the action is in any Coastal Area, complete the Coastal Assessment Form before proceeding with this assessment.

Tips for completing Part 2:

- Review all of the information provided in Part 1.
- Review any application, maps, supporting materials and the Full EAF Workbook.
- Answer each of the 18 questions in Part 2.
- If you answer "Yes" to a numbered question, please complete all the questions that follow in that section.
- If you answer "No" to a numbered question, move on to the next numbered question.
- Check appropriate column to indicate the anticipated size of the impact.
- Proposed projects that would exceed a numeric threshold contained in a question should result in the reviewing agency checking the box "Moderate to large impact may occur."
- The reviewer is not expected to be an expert in environmental analysis.
- If you are not sure or undecided about the size of an impact, it may help to review the sub-questions for the general question and consult the workbook.
- When answering a question consider all components of the proposed activity, that is, the "whole action".
- Consider the possibility for long-term and cumulative impacts as well as direct impacts.
- Answer the question in a reasonable manner considering the scale and context of the project.

1. Impact on Land Proposed action may involve construction on, or physical alteration of, the land surface of the proposed site. (See Part 1. D.1) <i>If "Yes", answer questions a - j. If "No", move on to Section 2.</i>			
		<input type="checkbox"/> NO	<input type="checkbox"/> YES
	Relevant Part I Question(s)	No, or small impact may occur	Moderate to large impact may occur
a. The proposed action may involve construction on land where depth to water table is less than 3 feet.	E2d	<input type="checkbox"/>	<input type="checkbox"/>
b. The proposed action may involve construction on slopes of 15% or greater.	E2f	<input type="checkbox"/>	<input type="checkbox"/>
c. The proposed action may involve construction on land where bedrock is exposed, or generally within 5 feet of existing ground surface.	E2a	<input type="checkbox"/>	<input type="checkbox"/>
d. The proposed action may involve the excavation and removal of more than 1,000 tons of natural material.	D2a	<input type="checkbox"/>	<input type="checkbox"/>
e. The proposed action may involve construction that continues for more than one year or in multiple phases.	D1e	<input type="checkbox"/>	<input type="checkbox"/>
f. The proposed action may result in increased erosion, whether from physical disturbance or vegetation removal (including from treatment by herbicides).	D2e, D2q	<input type="checkbox"/>	<input type="checkbox"/>
g. The proposed action is, or may be, located within a Coastal Erosion hazard area.	B1i	<input type="checkbox"/>	<input type="checkbox"/>
h. Other impacts: _____		<input type="checkbox"/>	<input type="checkbox"/>

2. Impact on Geological Features

The proposed action may result in the modification or destruction of, or inhibit access to, any unique or unusual land forms on the site (e.g., cliffs, dunes, minerals, fossils, caves). (See Part 1. E.2.g)

☐ NO☐ YES

If "Yes", answer questions a - c. If "No", move on to Section 3.

	Relevant Part I Question(s)	No, or small impact may occur	Moderate to large impact may occur
a. Identify the specific land form(s) attached: _____	E2g	<input type="checkbox"/>	<input type="checkbox"/>
b. The proposed action may affect or is adjacent to a geological feature listed as a registered National Natural Landmark. Specific feature: _____	E3c	<input type="checkbox"/>	<input type="checkbox"/>
c. Other impacts: _____		<input type="checkbox"/>	<input type="checkbox"/>

3. Impacts on Surface Water

The proposed action may affect one or more wetlands or other surface water bodies (e.g., streams, rivers, ponds or lakes). (See Part 1. D.2, E.2.h)

☐ NO☐ YES

If "Yes", answer questions a - l. If "No", move on to Section 4.

	Relevant Part I Question(s)	No, or small impact may occur	Moderate to large impact may occur
a. The proposed action may create a new water body.	D2b, D1h	<input type="checkbox"/>	<input type="checkbox"/>
b. The proposed action may result in an increase or decrease of over 10% or more than a 10 acre increase or decrease in the surface area of any body of water.	D2b	<input type="checkbox"/>	<input type="checkbox"/>
c. The proposed action may involve dredging more than 100 cubic yards of material from a wetland or water body.	D2a	<input type="checkbox"/>	<input type="checkbox"/>
d. The proposed action may involve construction within or adjoining a freshwater or tidal wetland, or in the bed or banks of any other water body.	E2h	<input type="checkbox"/>	<input type="checkbox"/>
e. The proposed action may create turbidity in a waterbody, either from upland erosion, runoff or by disturbing bottom sediments.	D2a, D2h	<input type="checkbox"/>	<input type="checkbox"/>
f. The proposed action may include construction of one or more intake(s) for withdrawal of water from surface water.	D2c	<input type="checkbox"/>	<input type="checkbox"/>
g. The proposed action may include construction of one or more outfall(s) for discharge of wastewater to surface water(s).	D2d	<input type="checkbox"/>	<input type="checkbox"/>
h. The proposed action may cause soil erosion, or otherwise create a source of stormwater discharge that may lead to siltation or other degradation of receiving water bodies.	D2e	<input type="checkbox"/>	<input type="checkbox"/>
i. The proposed action may affect the water quality of any water bodies within or downstream of the site of the proposed action.	E2h	<input type="checkbox"/>	<input type="checkbox"/>
j. The proposed action may involve the application of pesticides or herbicides in or around any water body.	D2q, E2h	<input type="checkbox"/>	<input type="checkbox"/>
k. The proposed action may require the construction of new, or expansion of existing, wastewater treatment facilities.	D1a, D2d	<input type="checkbox"/>	<input type="checkbox"/>

I. Other impacts: _____ _____		<input type="checkbox"/>	<input type="checkbox"/>
----------------------------------	--	--------------------------	--------------------------

4. Impact on groundwater The proposed action may result in new or additional use of ground water, or may have the potential to introduce contaminants to ground water or an aquifer. <input type="checkbox"/> NO <input type="checkbox"/> YES (See Part 1. D.2.a, D.2.c, D.2.d, D.2.p, D.2.q, D.2.t) <i>If "Yes", answer questions a - h. If "No", move on to Section 5.</i>			
	Relevant Part I Question(s)	No, or small impact may occur	Moderate to large impact may occur
a. The proposed action may require new water supply wells, or create additional demand on supplies from existing water supply wells.	D2c	<input type="checkbox"/>	<input type="checkbox"/>
b. Water supply demand from the proposed action may exceed safe and sustainable withdrawal capacity rate of the local supply or aquifer. Cite Source: _____	D2c	<input type="checkbox"/>	<input type="checkbox"/>
c. The proposed action may allow or result in residential uses in areas without water and sewer services.	D1a, D2c	<input type="checkbox"/>	<input type="checkbox"/>
d. The proposed action may include or require wastewater discharged to groundwater.	D2d, E2l	<input type="checkbox"/>	<input type="checkbox"/>
e. The proposed action may result in the construction of water supply wells in locations where groundwater is, or is suspected to be, contaminated.	D2c, E1f, E1g, E1h	<input type="checkbox"/>	<input type="checkbox"/>
f. The proposed action may require the bulk storage of petroleum or chemical products over ground water or an aquifer.	D2p, E2l	<input type="checkbox"/>	<input type="checkbox"/>
g. The proposed action may involve the commercial application of pesticides within 100 feet of potable drinking water or irrigation sources.	E2h, D2q, E2l, D2c	<input type="checkbox"/>	<input type="checkbox"/>
h. Other impacts: _____ _____		<input type="checkbox"/>	<input type="checkbox"/>

5. Impact on Flooding The proposed action may result in development on lands subject to flooding. <input type="checkbox"/> NO <input type="checkbox"/> YES (See Part 1. E.2) <i>If "Yes", answer questions a - g. If "No", move on to Section 6.</i>			
	Relevant Part I Question(s)	No, or small impact may occur	Moderate to large impact may occur
a. The proposed action may result in development in a designated floodway.	E2i	<input type="checkbox"/>	<input type="checkbox"/>
b. The proposed action may result in development within a 100 year floodplain.	E2j	<input type="checkbox"/>	<input type="checkbox"/>
c. The proposed action may result in development within a 500 year floodplain.	E2k	<input type="checkbox"/>	<input type="checkbox"/>
d. The proposed action may result in, or require, modification of existing drainage patterns.	D2b, D2e	<input type="checkbox"/>	<input type="checkbox"/>
e. The proposed action may change flood water flows that contribute to flooding.	D2b, E2i, E2j, E2k	<input type="checkbox"/>	<input type="checkbox"/>
f. If there is a dam located on the site of the proposed action, is the dam in need of repair, or upgrade?	E1e	<input type="checkbox"/>	<input type="checkbox"/>

g. Other impacts: _____ _____		<input type="checkbox"/>	<input type="checkbox"/>
----------------------------------	--	--------------------------	--------------------------

6. Impacts on Air The proposed action may include a state regulated air emission source. <input type="checkbox"/> NO <input type="checkbox"/> YES (See Part 1. D.2.f., D.2.h, D.2.g) <i>If "Yes", answer questions a - f. If "No", move on to Section 7.</i>			
	Relevant Part I Question(s)	No, or small impact may occur	Moderate to large impact may occur
a. If the proposed action requires federal or state air emission permits, the action may also emit one or more greenhouse gases at or above the following levels: i. More than 1000 tons/year of carbon dioxide (CO ₂) ii. More than 3.5 tons/year of nitrous oxide (N ₂ O) iii. More than 1000 tons/year of carbon equivalent of perfluorocarbons (PFCs) iv. More than .045 tons/year of sulfur hexafluoride (SF ₆) v. More than 1000 tons/year of carbon dioxide equivalent of hydrochloroflourocarbons (HFCs) emissions vi. 43 tons/year or more of methane	D2g D2g D2g D2g D2g D2h	<input type="checkbox"/> <input type="checkbox"/> <input type="checkbox"/> <input type="checkbox"/> <input type="checkbox"/> <input type="checkbox"/>	<input type="checkbox"/> <input type="checkbox"/> <input type="checkbox"/> <input type="checkbox"/> <input type="checkbox"/> <input type="checkbox"/>
b. The proposed action may generate 10 tons/year or more of any one designated hazardous air pollutant, or 25 tons/year or more of any combination of such hazardous air pollutants.	D2g	<input type="checkbox"/>	<input type="checkbox"/>
c. The proposed action may require a state air registration, or may produce an emissions rate of total contaminants that may exceed 5 lbs. per hour, or may include a heat source capable of producing more than 10 million BTU's per hour.	D2f, D2g	<input type="checkbox"/>	<input type="checkbox"/>
d. The proposed action may reach 50% of any of the thresholds in "a" through "c", above.	D2g	<input type="checkbox"/>	<input type="checkbox"/>
e. The proposed action may result in the combustion or thermal treatment of more than 1 ton of refuse per hour.	D2s	<input type="checkbox"/>	<input type="checkbox"/>
f. Other impacts: _____ _____		<input type="checkbox"/>	<input type="checkbox"/>

7. Impact on Plants and Animals The proposed action may result in a loss of flora or fauna. (See Part 1. E.2. m.-q.) <input type="checkbox"/> NO <input type="checkbox"/> YES <i>If "Yes", answer questions a - j. If "No", move on to Section 8.</i>			
	Relevant Part I Question(s)	No, or small impact may occur	Moderate to large impact may occur
a. The proposed action may cause reduction in population or loss of individuals of any threatened or endangered species, as listed by New York State or the Federal government, that use the site, or are found on, over, or near the site.	E2o	<input type="checkbox"/>	<input type="checkbox"/>
b. The proposed action may result in a reduction or degradation of any habitat used by any rare, threatened or endangered species, as listed by New York State or the federal government.	E2o	<input type="checkbox"/>	<input type="checkbox"/>
c. The proposed action may cause reduction in population, or loss of individuals, of any species of special concern or conservation need, as listed by New York State or the Federal government, that use the site, or are found on, over, or near the site.	E2p	<input type="checkbox"/>	<input type="checkbox"/>
d. The proposed action may result in a reduction or degradation of any habitat used by any species of special concern and conservation need, as listed by New York State or the Federal government.	E2p	<input type="checkbox"/>	<input type="checkbox"/>

e. The proposed action may diminish the capacity of a registered National Natural Landmark to support the biological community it was established to protect.	E3c	<input type="checkbox"/>	<input type="checkbox"/>
f. The proposed action may result in the removal of, or ground disturbance in, any portion of a designated significant natural community. Source: _____	E2n	<input type="checkbox"/>	<input type="checkbox"/>
g. The proposed action may substantially interfere with nesting/breeding, foraging, or over-wintering habitat for the predominant species that occupy or use the project site.	E2m	<input type="checkbox"/>	<input type="checkbox"/>
h. The proposed action requires the conversion of more than 10 acres of forest, grassland or any other regionally or locally important habitat. Habitat type & information source: _____	E1b	<input type="checkbox"/>	<input type="checkbox"/>
i. Proposed action (commercial, industrial or recreational projects, only) involves use of herbicides or pesticides.	D2q	<input type="checkbox"/>	<input type="checkbox"/>
j. Other impacts: _____		<input type="checkbox"/>	<input type="checkbox"/>

8. Impact on Agricultural Resources The proposed action may impact agricultural resources. (See Part 1. E.3.a. and b.) <input type="checkbox"/> NO <input type="checkbox"/> YES <i>If "Yes", answer questions a - h. If "No", move on to Section 9.</i>			
	Relevant Part I Question(s)	No, or small impact may occur	Moderate to large impact may occur
a. The proposed action may impact soil classified within soil group 1 through 4 of the NYS Land Classification System.	E2c, E3b	<input type="checkbox"/>	<input type="checkbox"/>
b. The proposed action may sever, cross or otherwise limit access to agricultural land (includes cropland, hayfields, pasture, vineyard, orchard, etc).	E1a, E1b	<input type="checkbox"/>	<input type="checkbox"/>
c. The proposed action may result in the excavation or compaction of the soil profile of active agricultural land.	E3b	<input type="checkbox"/>	<input type="checkbox"/>
d. The proposed action may irreversibly convert agricultural land to non-agricultural uses, either more than 2.5 acres if located in an Agricultural District, or more than 10 acres if not within an Agricultural District.	E1b, E3a	<input type="checkbox"/>	<input type="checkbox"/>
e. The proposed action may disrupt or prevent installation of an agricultural land management system.	E1 a, E1b	<input type="checkbox"/>	<input type="checkbox"/>
f. The proposed action may result, directly or indirectly, in increased development potential or pressure on farmland.	C2c, C3, D2c, D2d	<input type="checkbox"/>	<input type="checkbox"/>
g. The proposed project is not consistent with the adopted municipal Farmland Protection Plan.	C2c	<input type="checkbox"/>	<input type="checkbox"/>
h. Other impacts: _____		<input type="checkbox"/>	<input type="checkbox"/>

9. Impact on Aesthetic Resources The land use of the proposed action are obviously different from, or are in sharp contrast to, current land use patterns between the proposed project and a scenic or aesthetic resource. (Part 1. E.1.a, E.1.b, E.3.h.) <i>If "Yes", answer questions a - g. If "No", go to Section 10.</i>			
		<input type="checkbox"/> NO	<input type="checkbox"/> YES
	Relevant Part I Question(s)	No, or small impact may occur	Moderate to large impact may occur
a. Proposed action may be visible from any officially designated federal, state, or local scenic or aesthetic resource.	E3h	<input type="checkbox"/>	<input type="checkbox"/>
b. The proposed action may result in the obstruction, elimination or significant screening of one or more officially designated scenic views.	E3h, C2b	<input type="checkbox"/>	<input type="checkbox"/>
c. The proposed action may be visible from publicly accessible vantage points: i. Seasonally (e.g., screened by summer foliage, but visible during other seasons) ii. Year round	E3h	<input type="checkbox"/> <input type="checkbox"/>	<input type="checkbox"/> <input type="checkbox"/>
d. The situation or activity in which viewers are engaged while viewing the proposed action is: i. Routine travel by residents, including travel to and from work ii. Recreational or tourism based activities	E3h E2q, E1c	<input type="checkbox"/> <input type="checkbox"/>	<input type="checkbox"/> <input type="checkbox"/>
e. The proposed action may cause a diminishment of the public enjoyment and appreciation of the designated aesthetic resource.	E3h	<input type="checkbox"/>	<input type="checkbox"/>
f. There are similar projects visible within the following distance of the proposed project: 0-1/2 mile 1/2 -3 mile 3-5 mile 5+ mile	D1a, E1a, D1f, D1g	<input type="checkbox"/>	<input type="checkbox"/>
g. Other impacts: _____ _____		<input type="checkbox"/>	<input type="checkbox"/>

10. Impact on Historic and Archeological Resources The proposed action may occur in or adjacent to a historic or archaeological resource. (Part 1. E.3.e, f. and g.) <i>If "Yes", answer questions a - e. If "No", go to Section 11.</i>			
		<input type="checkbox"/> NO	<input type="checkbox"/> YES
	Relevant Part I Question(s)	No, or small impact may occur	Moderate to large impact may occur
a. The proposed action may occur wholly or partially within, or substantially contiguous to, any buildings, archaeological site or district which is listed on the National or State Register of Historical Places, or that has been determined by the Commissioner of the NYS Office of Parks, Recreation and Historic Preservation to be eligible for listing on the State Register of Historic Places.	E3e	<input type="checkbox"/>	<input type="checkbox"/>
b. The proposed action may occur wholly or partially within, or substantially contiguous to, an area designated as sensitive for archaeological sites on the NY State Historic Preservation Office (SHPO) archaeological site inventory.	E3f	<input type="checkbox"/>	<input type="checkbox"/>
c. The proposed action may occur wholly or partially within, or substantially contiguous to, an archaeological site not included on the NY SHPO inventory. Source: _____	E3g	<input type="checkbox"/>	<input type="checkbox"/>

d. Other impacts: _____		<input type="checkbox"/>	<input type="checkbox"/>
If any of the above (a-d) are answered "Moderate to large impact may occur", continue with the following questions to help support conclusions in Part 3:			
i. The proposed action may result in the destruction or alteration of all or part of the site or property.	E3e, E3g, E3f	<input type="checkbox"/>	<input type="checkbox"/>
ii. The proposed action may result in the alteration of the property's setting or integrity.	E3e, E3f, E3g, E1a, E1b	<input type="checkbox"/>	<input type="checkbox"/>
iii. The proposed action may result in the introduction of visual elements which are out of character with the site or property, or may alter its setting.	E3e, E3f, E3g, E3h, C2, C3	<input type="checkbox"/>	<input type="checkbox"/>

11. Impact on Open Space and Recreation The proposed action may result in a loss of recreational opportunities or a reduction of an open space resource as designated in any adopted municipal open space plan. (See Part 1. C.2.c, E.1.c., E.2.q.) If "Yes", answer questions a - e. If "No", go to Section 12.			
		<input type="checkbox"/> NO	<input type="checkbox"/> YES
	Relevant Part I Question(s)	No, or small impact may occur	Moderate to large impact may occur
a. The proposed action may result in an impairment of natural functions, or "ecosystem services", provided by an undeveloped area, including but not limited to stormwater storage, nutrient cycling, wildlife habitat.	D2e, E1b E2h, E2m, E2o, E2n, E2p	<input type="checkbox"/>	<input type="checkbox"/>
b. The proposed action may result in the loss of a current or future recreational resource.	C2a, E1c, C2c, E2q	<input type="checkbox"/>	<input type="checkbox"/>
c. The proposed action may eliminate open space or recreational resource in an area with few such resources.	C2a, C2c E1c, E2q	<input type="checkbox"/>	<input type="checkbox"/>
d. The proposed action may result in loss of an area now used informally by the community as an open space resource.	C2c, E1c	<input type="checkbox"/>	<input type="checkbox"/>
e. Other impacts: _____		<input type="checkbox"/>	<input type="checkbox"/>

12. Impact on Critical Environmental Areas The proposed action may be located within or adjacent to a critical environmental area (CEA). (See Part 1. E.3.d) If "Yes", answer questions a - c. If "No", go to Section 13.			
		<input type="checkbox"/> NO	<input type="checkbox"/> YES
	Relevant Part I Question(s)	No, or small impact may occur	Moderate to large impact may occur
a. The proposed action may result in a reduction in the quantity of the resource or characteristic which was the basis for designation of the CEA.	E3d	<input type="checkbox"/>	<input type="checkbox"/>
b. The proposed action may result in a reduction in the quality of the resource or characteristic which was the basis for designation of the CEA.	E3d	<input type="checkbox"/>	<input type="checkbox"/>
c. Other impacts: _____		<input type="checkbox"/>	<input type="checkbox"/>

13. Impact on Transportation The proposed action may result in a change to existing transportation systems. <input type="checkbox"/> NO <input type="checkbox"/> YES (See Part 1. D.2.j) <i>If "Yes", answer questions a - f. If "No", go to Section 14.</i>			
	Relevant Part I Question(s)	No, or small impact may occur	Moderate to large impact may occur
a. Projected traffic increase may exceed capacity of existing road network.	D2j	<input type="checkbox"/>	<input type="checkbox"/>
b. The proposed action may result in the construction of paved parking area for 500 or more vehicles.	D2j	<input type="checkbox"/>	<input type="checkbox"/>
c. The proposed action will degrade existing transit access.	D2j	<input type="checkbox"/>	<input type="checkbox"/>
d. The proposed action will degrade existing pedestrian or bicycle accommodations.	D2j	<input type="checkbox"/>	<input type="checkbox"/>
e. The proposed action may alter the present pattern of movement of people or goods.	D2j	<input type="checkbox"/>	<input type="checkbox"/>
f. Other impacts: _____		<input type="checkbox"/>	<input type="checkbox"/>

14. Impact on Energy The proposed action may cause an increase in the use of any form of energy. <input type="checkbox"/> NO <input type="checkbox"/> YES (See Part 1. D.2.k) <i>If "Yes", answer questions a - e. If "No", go to Section 15.</i>			
	Relevant Part I Question(s)	No, or small impact may occur	Moderate to large impact may occur
a. The proposed action will require a new, or an upgrade to an existing, substation.	D2k	<input type="checkbox"/>	<input type="checkbox"/>
b. The proposed action will require the creation or extension of an energy transmission or supply system to serve more than 50 single or two-family residences or to serve a commercial or industrial use.	D1f, D1q, D2k	<input type="checkbox"/>	<input type="checkbox"/>
c. The proposed action may utilize more than 2,500 MWhrs per year of electricity.	D2k	<input type="checkbox"/>	<input type="checkbox"/>
d. The proposed action may involve heating and/or cooling of more than 100,000 square feet of building area when completed.	D1g	<input type="checkbox"/>	<input type="checkbox"/>
e. Other Impacts: _____		<input type="checkbox"/>	<input type="checkbox"/>

15. Impact on Noise, Odor, and Light The proposed action may result in an increase in noise, odors, or outdoor lighting. <input type="checkbox"/> NO <input type="checkbox"/> YES (See Part 1. D.2.m., n., and o.) <i>If "Yes", answer questions a - f. If "No", go to Section 16.</i>			
	Relevant Part I Question(s)	No, or small impact may occur	Moderate to large impact may occur
a. The proposed action may produce sound above noise levels established by local regulation.	D2m	<input type="checkbox"/>	<input type="checkbox"/>
b. The proposed action may result in blasting within 1,500 feet of any residence, hospital, school, licensed day care center, or nursing home.	D2m, E1d	<input type="checkbox"/>	<input type="checkbox"/>
c. The proposed action may result in routine odors for more than one hour per day.	D2o	<input type="checkbox"/>	<input type="checkbox"/>

d. The proposed action may result in light shining onto adjoining properties.	D2n	<input type="checkbox"/>	<input type="checkbox"/>
e. The proposed action may result in lighting creating sky-glow brighter than existing area conditions.	D2n, E1a	<input type="checkbox"/>	<input type="checkbox"/>
f. Other impacts: _____		<input type="checkbox"/>	<input type="checkbox"/>

16. Impact on Human Health

The proposed action may have an impact on human health from exposure to new or existing sources of contaminants. (See Part 1.D.2.q., E.1. d. f. g. and h.)

☐ NO

☐ YES

If "Yes", answer questions a - m. If "No", go to Section 17.

	Relevant Part I Question(s)	No, or small impact may occur	Moderate to large impact may occur
a. The proposed action is located within 1500 feet of a school, hospital, licensed day care center, group home, nursing home or retirement community.	E1d	<input type="checkbox"/>	<input type="checkbox"/>
b. The site of the proposed action is currently undergoing remediation.	E1g, E1h	<input type="checkbox"/>	<input type="checkbox"/>
c. There is a completed emergency spill remediation, or a completed environmental site remediation on, or adjacent to, the site of the proposed action.	E1g, E1h	<input type="checkbox"/>	<input type="checkbox"/>
d. The site of the action is subject to an institutional control limiting the use of the property (e.g., easement or deed restriction).	E1g, E1h	<input type="checkbox"/>	<input type="checkbox"/>
e. The proposed action may affect institutional control measures that were put in place to ensure that the site remains protective of the environment and human health.	E1g, E1h	<input type="checkbox"/>	<input type="checkbox"/>
f. The proposed action has adequate control measures in place to ensure that future generation, treatment and/or disposal of hazardous wastes will be protective of the environment and human health.	D2t	<input type="checkbox"/>	<input type="checkbox"/>
g. The proposed action involves construction or modification of a solid waste management facility.	D2q, E1f	<input type="checkbox"/>	<input type="checkbox"/>
h. The proposed action may result in the unearthing of solid or hazardous waste.	D2q, E1f	<input type="checkbox"/>	<input type="checkbox"/>
i. The proposed action may result in an increase in the rate of disposal, or processing, of solid waste.	D2r, D2s	<input type="checkbox"/>	<input type="checkbox"/>
j. The proposed action may result in excavation or other disturbance within 2000 feet of a site used for the disposal of solid or hazardous waste.	E1f, E1g E1h	<input type="checkbox"/>	<input type="checkbox"/>
k. The proposed action may result in the migration of explosive gases from a landfill site to adjacent off site structures.	E1f, E1g	<input type="checkbox"/>	<input type="checkbox"/>
l. The proposed action may result in the release of contaminated leachate from the project site.	D2s, E1f, D2r	<input type="checkbox"/>	<input type="checkbox"/>
m. Other impacts: _____		<input type="checkbox"/>	<input type="checkbox"/>

17. Consistency with Community Plans The proposed action is not consistent with adopted land use plans. (See Part 1. C.1, C.2. and C.3.) <i>If "Yes", answer questions a - h. If "No", go to Section 18.</i>				<input type="checkbox"/> NO <input type="checkbox"/> YES
	Relevant Part I Question(s)	No, or small impact may occur	Moderate to large impact may occur	
a. The proposed action's land use components may be different from, or in sharp contrast to, current surrounding land use pattern(s).	C2, C3, D1a E1a, E1b	<input type="checkbox"/>	<input type="checkbox"/>	
b. The proposed action will cause the permanent population of the city, town or village in which the project is located to grow by more than 5%.	C2	<input type="checkbox"/>	<input type="checkbox"/>	
c. The proposed action is inconsistent with local land use plans or zoning regulations.	C2, C2, C3	<input type="checkbox"/>	<input type="checkbox"/>	
d. The proposed action is inconsistent with any County plans, or other regional land use plans.	C2, C2	<input type="checkbox"/>	<input type="checkbox"/>	
e. The proposed action may cause a change in the density of development that is not supported by existing infrastructure or is distant from existing infrastructure.	C3, D1c, D1d, D1f, D1d, E1b	<input type="checkbox"/>	<input type="checkbox"/>	
f. The proposed action is located in an area characterized by low density development that will require new or expanded public infrastructure.	C4, D2c, D2d D2j	<input type="checkbox"/>	<input type="checkbox"/>	
g. The proposed action may induce secondary development impacts (e.g., residential or commercial development not included in the proposed action)	C2a	<input type="checkbox"/>	<input type="checkbox"/>	
h. Other: _____ _____		<input type="checkbox"/>	<input type="checkbox"/>	

18. Consistency with Community Character The proposed project is inconsistent with the existing community character. (See Part 1. C.2, C.3, D.2, E.3) <i>If "Yes", answer questions a - g. If "No", proceed to Part 3.</i>				<input type="checkbox"/> NO <input type="checkbox"/> YES
	Relevant Part I Question(s)	No, or small impact may occur	Moderate to large impact may occur	
a. The proposed action may replace or eliminate existing facilities, structures, or areas of historic importance to the community.	E3e, E3f, E3g	<input type="checkbox"/>	<input type="checkbox"/>	
b. The proposed action may create a demand for additional community services (e.g. schools, police and fire)	C4	<input type="checkbox"/>	<input type="checkbox"/>	
c. The proposed action may displace affordable or low-income housing in an area where there is a shortage of such housing.	C2, C3, D1f D1g, E1a	<input type="checkbox"/>	<input type="checkbox"/>	
d. The proposed action may interfere with the use or enjoyment of officially recognized or designated public resources.	C2, E3	<input type="checkbox"/>	<input type="checkbox"/>	
e. The proposed action is inconsistent with the predominant architectural scale and character.	C2, C3	<input type="checkbox"/>	<input type="checkbox"/>	
f. Proposed action is inconsistent with the character of the existing natural landscape.	C2, C3 E1a, E1b E2g, E2h	<input type="checkbox"/>	<input type="checkbox"/>	
g. Other impacts: _____ _____		<input type="checkbox"/>	<input type="checkbox"/>	

Project :

Date :

Full Environmental Assessment Form
Part 3 - Evaluation of the Magnitude and Importance of Project Impacts
and
Determination of Significance

Part 3 provides the reasons in support of the determination of significance. The lead agency must complete Part 3 for every question in Part 2 where the impact has been identified as potentially moderate to large or where there is a need to explain why a particular element of the proposed action will not, or may, result in a significant adverse environmental impact.

Based on the analysis in Part 3, the lead agency must decide whether to require an environmental impact statement to further assess the proposed action or whether available information is sufficient for the lead agency to conclude that the proposed action will not have a significant adverse environmental impact. By completing the certification on the next page, the lead agency can complete its determination of significance.

Reasons Supporting This Determination:

To complete this section:

- Identify the impact based on the Part 2 responses and describe its magnitude. Magnitude considers factors such as severity, size or extent of an impact.
- Assess the importance of the impact. Importance relates to the geographic scope, duration, probability of the impact occurring, number of people affected by the impact and any additional environmental consequences if the impact were to occur.
- The assessment should take into consideration any design element or project changes.
- Repeat this process for each Part 2 question where the impact has been identified as potentially moderate to large or where there is a need to explain why a particular element of the proposed action will not, or may, result in a significant adverse environmental impact.
- Provide the reason(s) why the impact may, or will not, result in a significant adverse environmental impact
- For Conditional Negative Declarations identify the specific condition(s) imposed that will modify the proposed action so that no significant adverse environmental impacts will result.
- Attach additional sheets, as needed.

Determination of Significance - Type 1 and Unlisted Actions

SEQR Status: ☐ Type 1 ☐ Unlisted

Identify portions of EAF completed for this Project: ☐ Part 1 ☐ Part 2 ☐ Part 3

Upon review of the information recorded on this EAF, as noted, plus this additional support information

and considering both the magnitude and importance of each identified potential impact, it is the conclusion of the _____ as lead agency that:

☐ A. This project will result in no significant adverse impacts on the environment, and, therefore, an environmental impact statement need not be prepared. Accordingly, this negative declaration is issued.

☐ B. Although this project could have a significant adverse impact on the environment, that impact will be avoided or substantially mitigated because of the following conditions which will be required by the lead agency:

There will, therefore, be no significant adverse impacts from the project as conditioned, and, therefore, this conditioned negative declaration is issued. A conditioned negative declaration may be used only for UNLISTED actions (see 6 NYCRR 617.7(d)).

☐ C. This Project may result in one or more significant adverse impacts on the environment, and an environmental impact statement must be prepared to further assess the impact(s) and possible mitigation and to explore alternatives to avoid or reduce those impacts. Accordingly, this positive declaration is issued.

Name of Action:

Name of Lead Agency:

Name of Responsible Officer in Lead Agency:

Title of Responsible Officer:

Signature of Responsible Officer in Lead Agency:

Date:

Signature of Preparer (if different from Responsible Officer)

Date:

For Further Information:

Contact Person:

Address:

Telephone Number:

E-mail:

For Type 1 Actions and Conditioned Negative Declarations, a copy of this Notice is sent to:

Chief Executive Officer of the political subdivision in which the action will be principally located (e.g., Town / City / Village of)

Other involved agencies (if any)

Applicant (if any)

Environmental Notice Bulletin: <http://www.dec.ny.gov/enb/enb.html>