



National Historic Districts Revitalization Master Plan 2020



Recipient of the
National Trust for Historic Preservation Grant









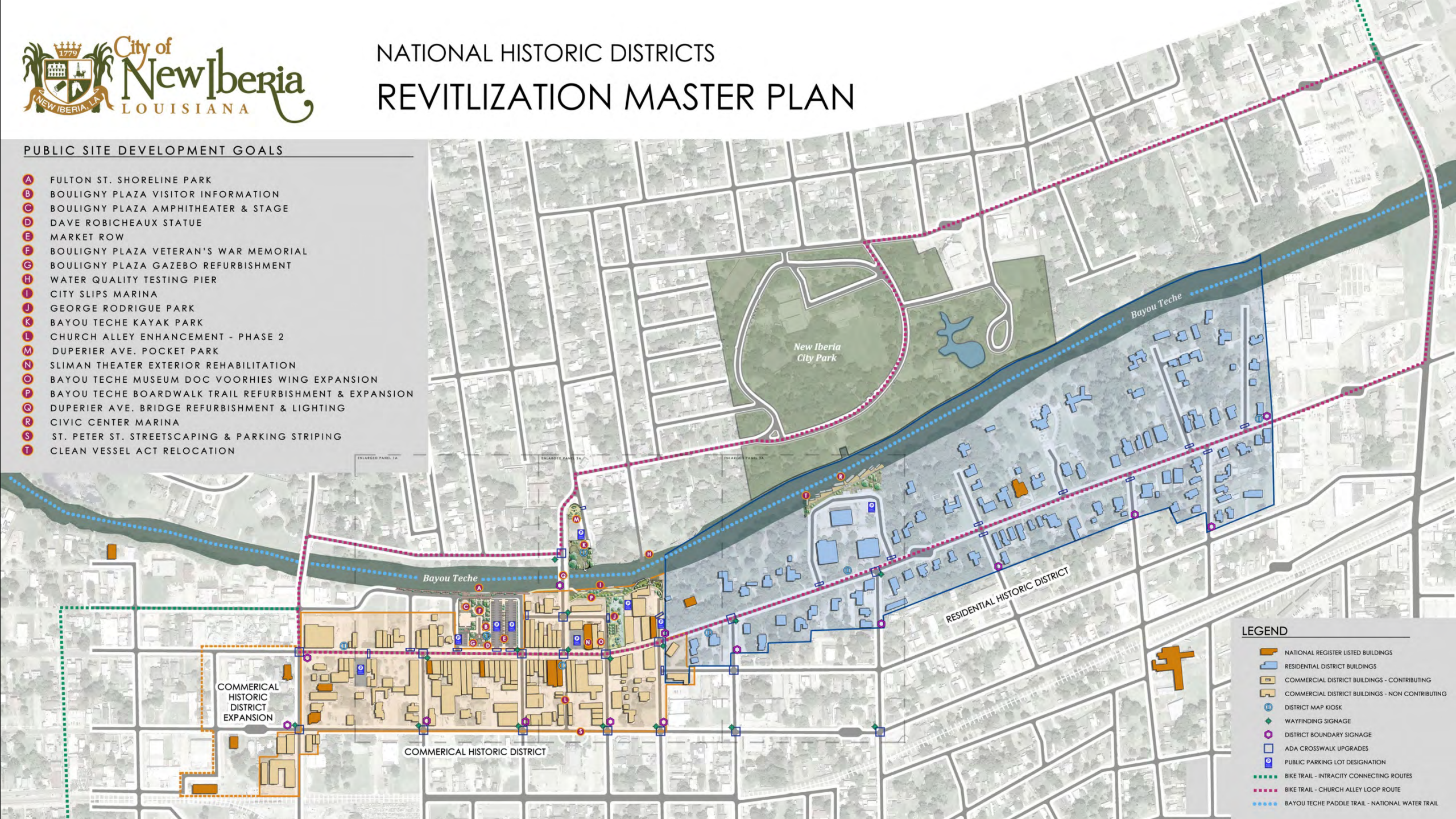

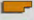

NATIONAL HISTORIC DISTRICTS REVITALIZATION MASTER PLAN

PUBLIC SITE DEVELOPMENT GOALS

- A** FULTON ST. SHORELINE PARK
- B** BOULIGNY PLAZA VISITOR INFORMATION
- C** BOULIGNY PLAZA AMPHITHEATER & STAGE
- D** DAVE ROBICHEAUX STATUE
- E** MARKET ROW
- F** BOULIGNY PLAZA VETERAN'S WAR MEMORIAL
- G** BOULIGNY PLAZA GAZEBO REFURBISHMENT
- H** WATER QUALITY TESTING PIER
- I** CITY SLIPS MARINA
- J** GEORGE RODRIGUE PARK
- K** BAYOU TECHE KAYAK PARK
- L** CHURCH ALLEY ENHANCEMENT - PHASE 2
- M** DUPERIER AVE. POCKET PARK
- N** SLIMAN THEATER EXTERIOR REHABILITATION
- O** BAYOU TECHE MUSEUM DOC VOORHIES WING EXPANSION
- P** BAYOU TECHE BOARDWALK TRAIL REFURBISHMENT & EXPANSION
- Q** DUPERIER AVE. BRIDGE REFURBISHMENT & LIGHTING
- R** CIVIC CENTER MARINA
- S** ST. PETER ST. STREETSCAPING & PARKING STRIPING
- T** CLEAN VESSEL ACT RELOCATION

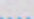

LEGEND

-  NATIONAL REGISTER LISTED BUILDINGS
-  RESIDENTIAL DISTRICT BUILDINGS
-  COMMERCIAL DISTRICT BUILDINGS - CONTRIBUTING
-  COMMERCIAL DISTRICT BUILDINGS - NON CONTRIBUTING
-  DISTRICT MAP KIOSK
-  WAYFINDING SIGNAGE
-  DISTRICT BOUNDARY SIGNAGE
-  ADA CROSSWALK UPGRADES
-  PUBLIC PARKING LOT DESIGNATION
-  BIKE TRAIL - INTRACITY CONNECTING ROUTES
-  BIKE TRAIL - CHURCH ALLEY LOOP ROUTE
-  BAYOU TECHE PADDLE TRAIL - NATIONAL WATER TRAIL

Boulogny Plaza

Property Enhancement Overview



Fulton Street Shoreline Park

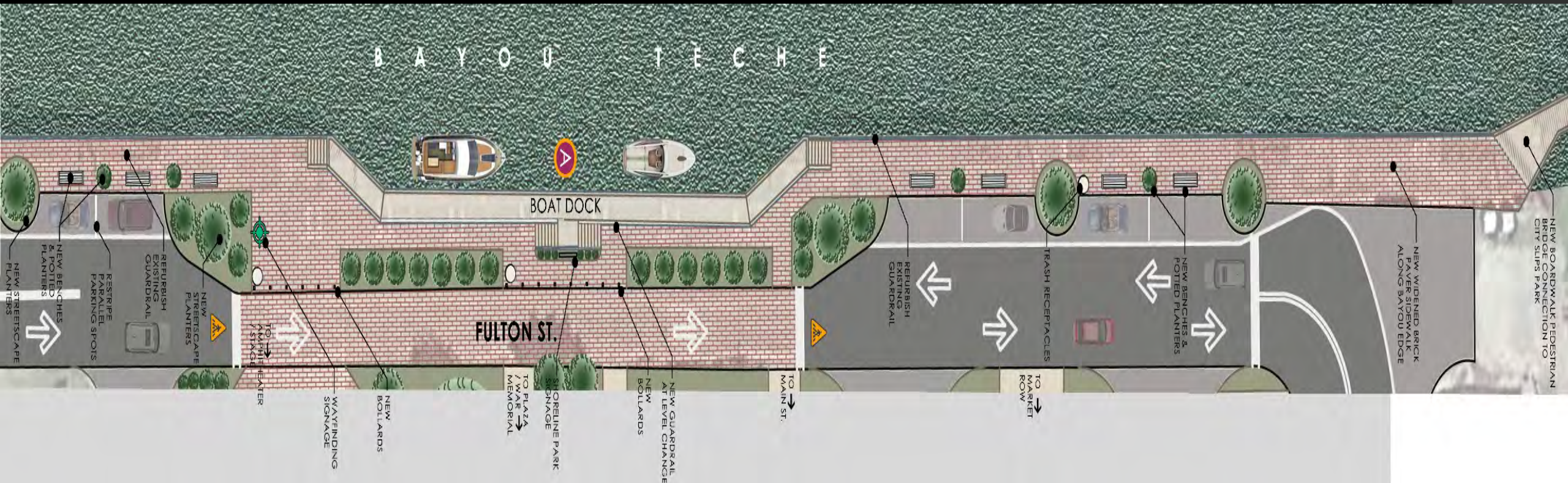

- DOWNTOWN CONNECTION TO BAYOU TECHE,
- PROMOTES OFFICIAL DESIGNATION AS A NATIONAL WATERWAY
- GIVES BOATING TRAFFIC DIRECT ACCESS TO DOWNTOWN
- PROMOTES TOURISM WITH EMPHASIS ON BOATING ACTIVITIES
- SHORELINE PARK TO BE CATALYST FOR POSSIBLE BOAT TOUR EVENTS, RICKSHAW RACES, LITTLE BOAT RACES, ETC.

Fulton Street Shoreline Park

PRECEDENT IMAGES:



Tourist Information Panels

- CONVERT EXISTING UNDERUTILIZED BUILDING INTO OPEN AIR PAVILION TO HOUSE DOWNTOWN DISTRICT MAP, HISTORICAL TIMELINE PANELS, AND CULTURAL INFORMATION PANELS
- SHOWCASE USEFUL AND FUN INFORMATION RELEVANT TO TOURISTS IN MUSEUM LIKE ATMOSPHERE TO KEEP VISITORS IN DOWNTOWN LONGER AND SPARK
- INTEREST IN SURROUNDING DESTINATIONS
- REPURPOSE PERIMETER BRICK ARCHWAY WALLS & ROOF OF EXISTING BUILDING AND DEMO INTERIOR WALLS TO CREATE AN OPEN GATEWAY FEEL BETWEEN PARKING LOT & BOULIGNY PLAZA

PLAN:

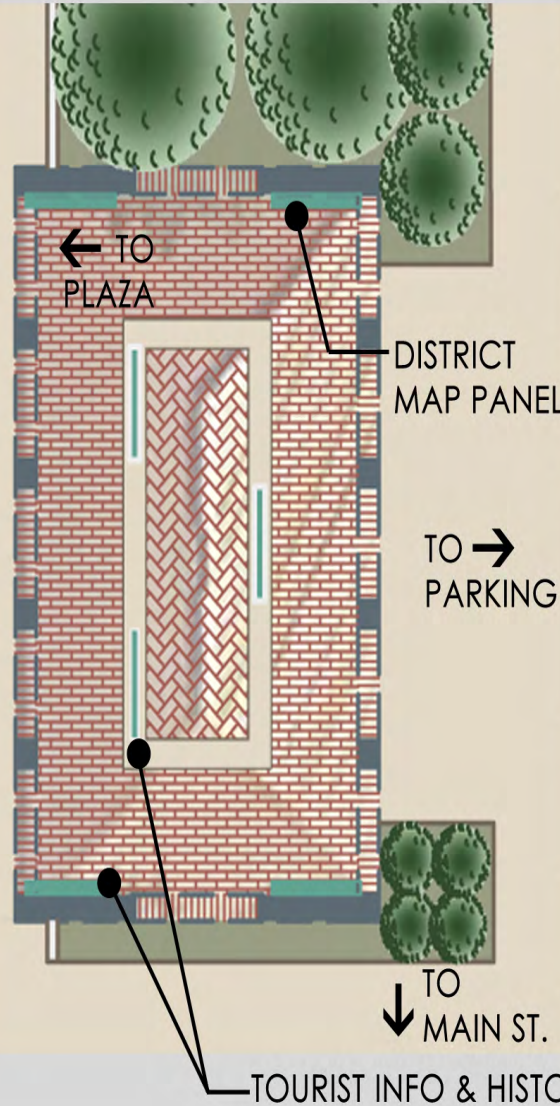

PROPOSED RENDER:



DISTRICT MAP:



INFO PANEL PRECEDENT IMAGES:



TOURIST INFO & HISTORICAL TIMELINE PANELS

Amphitheater & Stage @ Boulogny Plaza

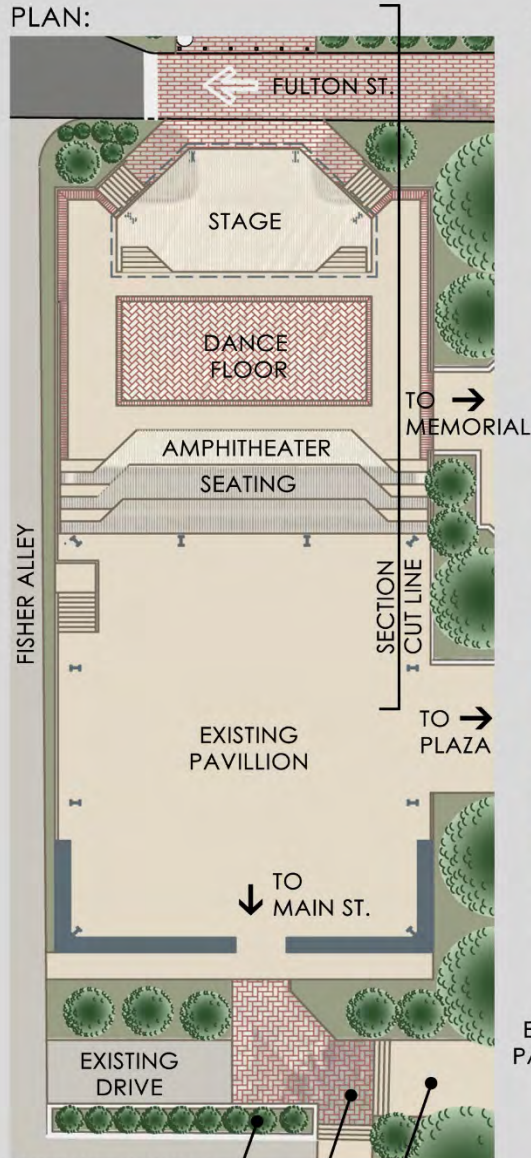

PRECEDENT IMAGES:



SECTION

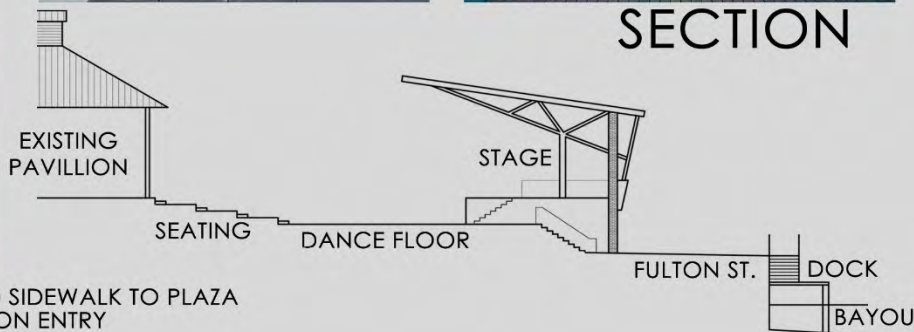

- REAR ADDITION TO THE EXISTING BOULIGNY PLAZA PAVILION
- CREATES A PERMANENT STAGE / SEATING STRUCTURE
- REDUCES COSTS TO EVENT ORGANIZERS FOR TEMPORARY STAGE RENTAL FEES
- ENCOURAGES NEW OUTDOOR ENTERTAINMENT OPTIONS
- EXAMPLES: SEASONAL CONCERT SERIES, OUTDOOR FILM SCREENINGS, THEATRICAL PERFORMANCES, COMMUNITY SPEECHES, AWARD CEREMONIES, ETC.
- CELEBRATES LOCAL PERFORMANCE ARTISTS
- PROMOTES TOURISM & COMMUNITY GATHERINGS
- PEDESTRIAN CONNECTION TO FULTON STREET SHORELINE PARK

NEW DIVIDING PLANTER FROM PARKING LOT

EXTEND SIDEWALK TO PLAZA
PAVE PAVILION ENTRY

Market Row

PLAN:

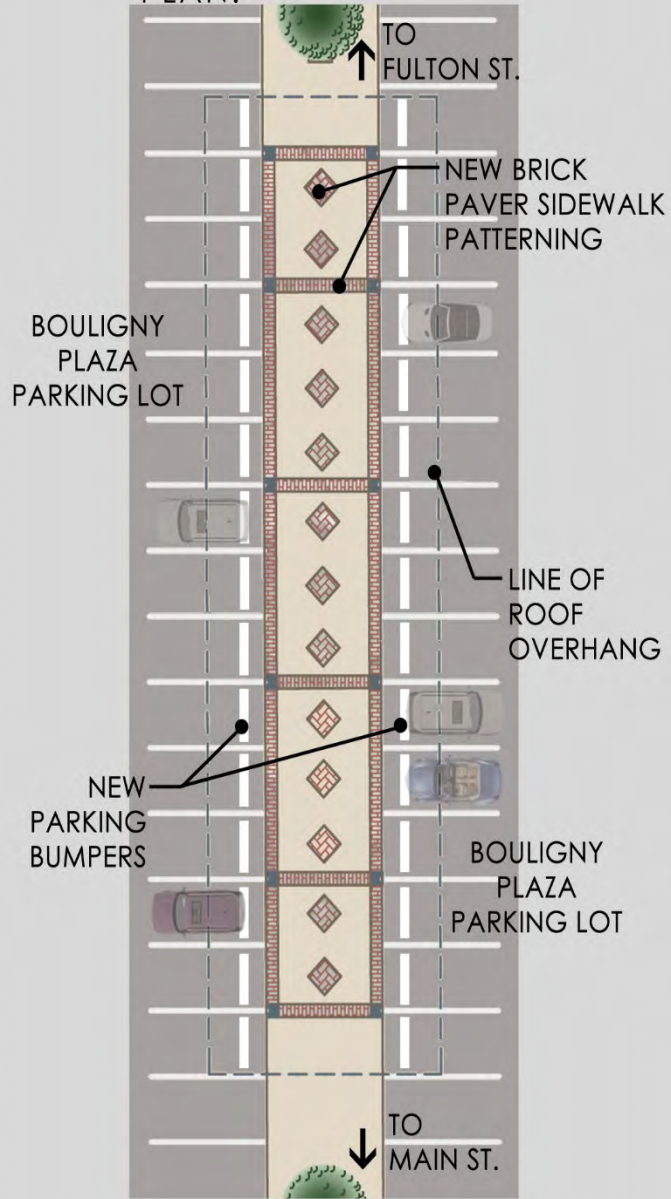

PRECEDENT IMAGE:



PRECEDENT IMAGES:



- STRUCTURE TO HOST VARIOUS COMMUNITY MARKET EVENTS EXAMPLS: FARMER'S MARKETS, CHRISTMAS MARKETS, ART & CRAFTS MARKETS, ETC.
- CREATES ENHANCED ATMOSPHERE TO DRAW MORE CUSTOMERS TO MARKET EVENTS
- PROVIDES ECONOMIC BOOST TO LOCAL VENDORS PARTICIPATING IN MARKET EVENTS
- FLEXIBLE SPACE THAT COULD BE USED AS A SHADE STRUCTURE FOR PEDESTRIANS VISITING DOWNTOWN, FESTIVAL EVENTS, OR SPARK FUTURE COMMUNITY ACTIVITIES

Veteran's War Memorial @ Bouligny

Plaza

PLAN:

PRECEDENT IMAGES:

← TO
AMPHITHEATER

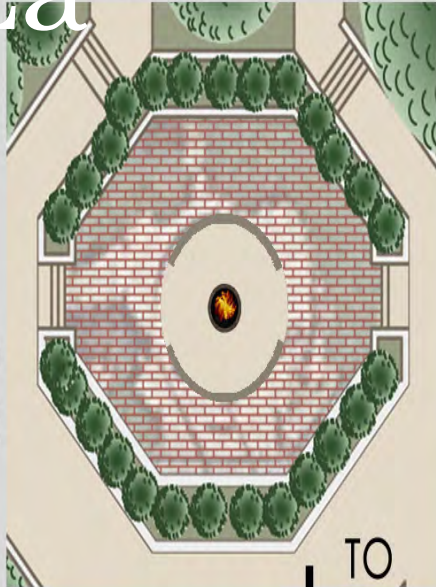

↓ TO
MAIN ST.



- ERECT MONUMENT TO HONOR NEW IBERIA'S VETERANS THAT HAVE SERVED OUR COUNTRY
- UTILIZE CIRCULAR DESIGN IN PLAZA TO SHOWCASE PLAQUE WALL AND CENTRAL ETERNAL FLAME

Boulogny Plaza Gazebo Refurbishments

RENDER OF GAZEBO:



EXISTING GAZEBO:



PRECEDENT IMAGE:



ADD NEW METAL ROOF TO GAZEBO TO FIX EXISTING LEAKS & RESTABILIZE STRUCTURE BY REPAIRING ROTTEN WOOD

PRESERVES A HIGHLY UTILIZED STRUCTURE IN THE PLAZA & ENCOURAGES FUTURE ENJOYMENT AMONG RESIDENTS AND VISITORS ALIKE

Main Street Parallel Parking Additions

DRAWING PRODUCED BY ASSOCIATED ENGINEERS & ARCHITECTS, INC.

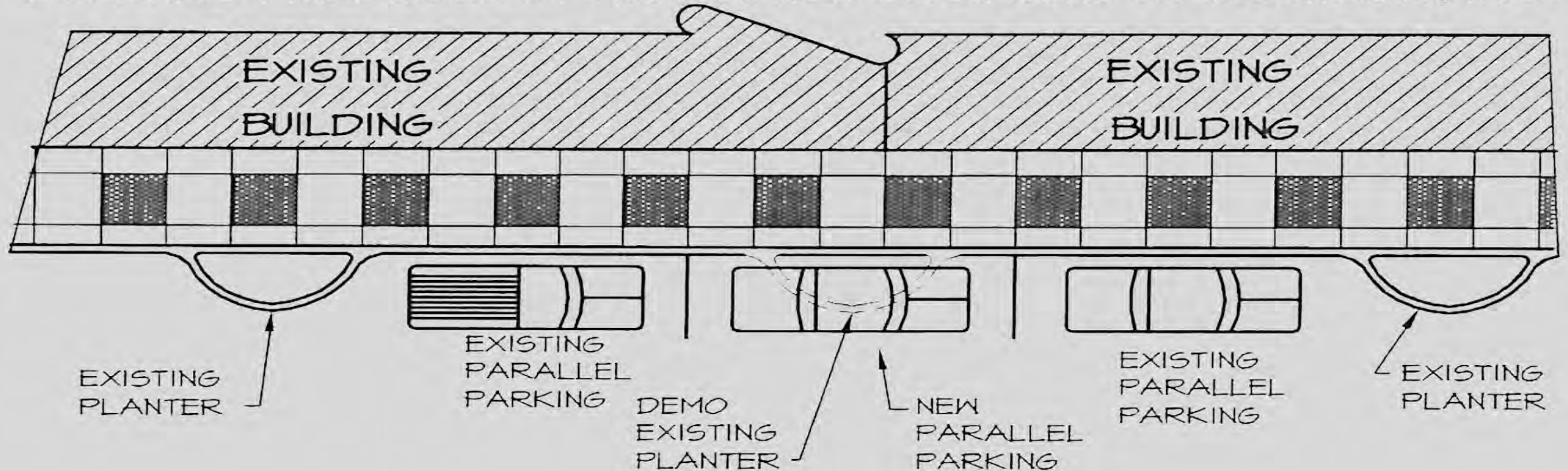

TYPICAL PARALLEL PARKING ON MAIN ST.

REMOVE AND PAVE OVER 12 EXISTING PLANTERS ALONG MAIN STREET TO CREATE
13 NEW PARALLEL PARKING LOCATIONS

ADDITIONAL CURB SIDE PARKING ALLOWS FOR EASIER PARKING AND ACCESS
TO DOWNTOWN BUSINESSES

ADA Crosswalk Upgrades

ENLARGED PLAN:

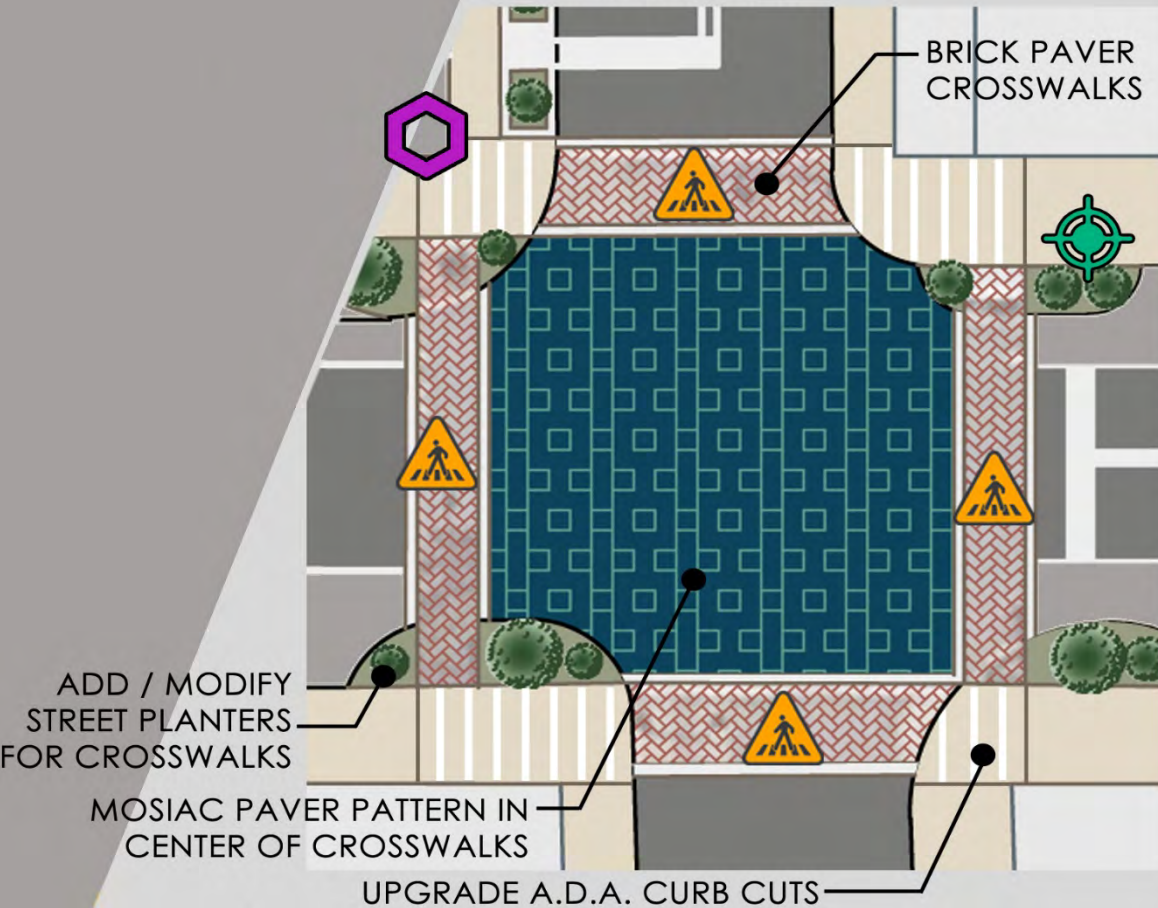

PRECEDENT IMAGES:



- IMPROVED CROSSWALK DESIGN AT EVERY DOWNTOWN STREET INTERSECTION
- EASE OF TRAVEL FOR HANDICAPPED RESIDENTS

- ADA COMPLIANT
- SLOWS TRAFFIC AT INTERSECTIONS
- INCREASED SAFETY DOWNTOWN
- NO JAY-WALKING THROUGH TRAFFIC

St. Peter Streetscape & Parking

ENLARGED PLAN & RENDER:

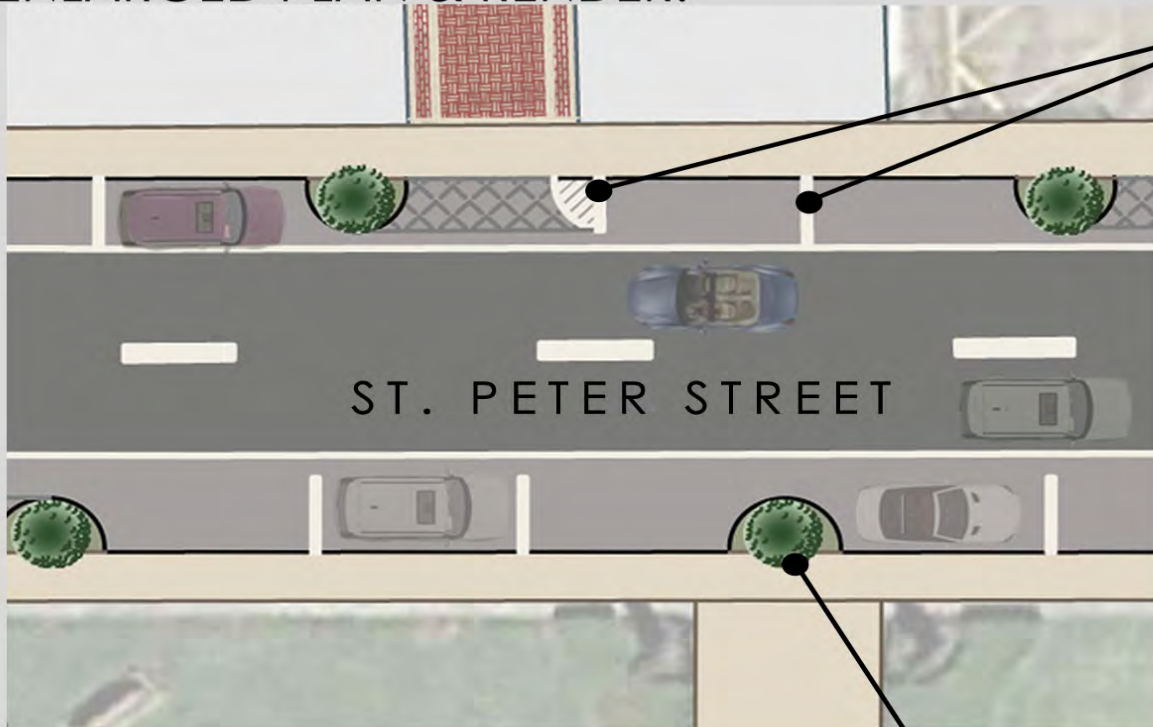

NEW STREETSCAPE PLANTERS

NEW BANNERS

- NEW STREET PLANTERS & PARALLEL PARKING STRIPES ON ST. PETER ST. FROM JEFFERSON ST. TO CENTER ST.
- EXPANDS SUCCESS OF MAIN ST. STREETSCAPING TO ANOTHER MAJOR CORRIDOR WITH THE HISTORIC DISTRICT
- BEAUTIFIES THE ST. PETER STREET ATMOSPHERE & INCENTIVIZES NEW BUSINESSES AND ACTIVITIES ALONG ST. PETER ST.

District Boundary Signage

RENDERS OF SIGNAGE:

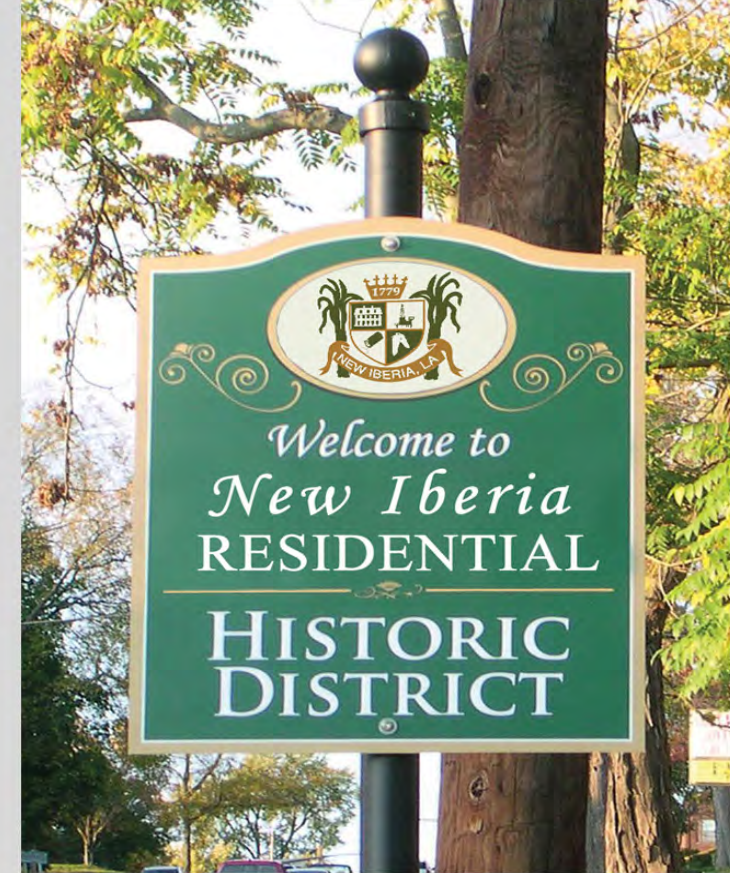
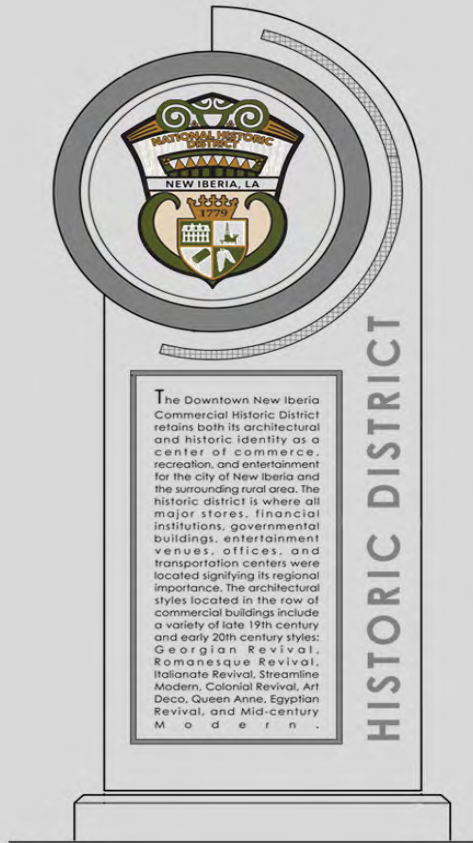

- ROAD SIDE SIGNAGE LOCATED AT ALL BOUNDARIES OF HISTORIC DISTRICTS
- LOCATIONS INCLUDE ALL SIDE STREETS AND MAIN ROUTES
- IDENTIFIES THE IMPORTANCE OF THE AREA VISITED
- CONSISTENT WITH HISTORIC DISTRICT BRANDING STRATEGIES

District Map Kiosk & Wayfinding Signage

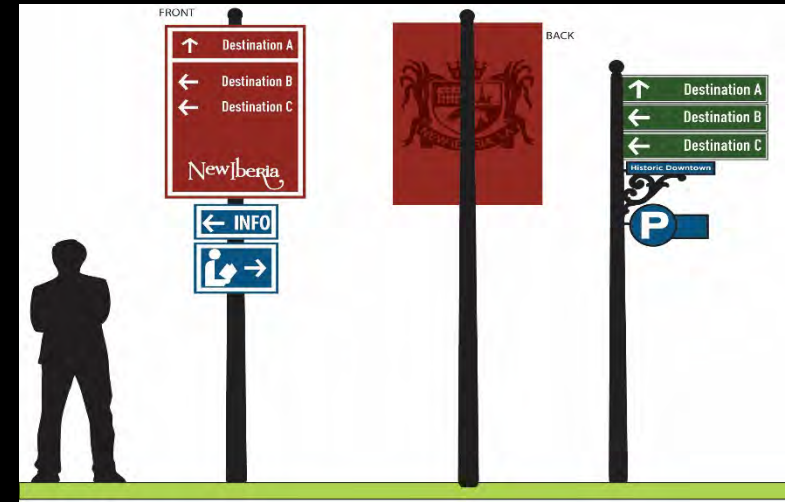

- DISTRICT MAP PANEL WITH CORRESPONDING INFORMATIONAL BROCHURES TO SHOWCASE HISTORIC DISTRICTS, BUILDING HISTORY, AND RECREATIONAL TRAILS.
- PROMOTES TOURISM AND VISITOR CIRCULATION AROUND DOWNTOWN

Commercial District

Property Enhancement Overview



Duperier Ave. Pocket Park

ENLARGED SITE PLAN:

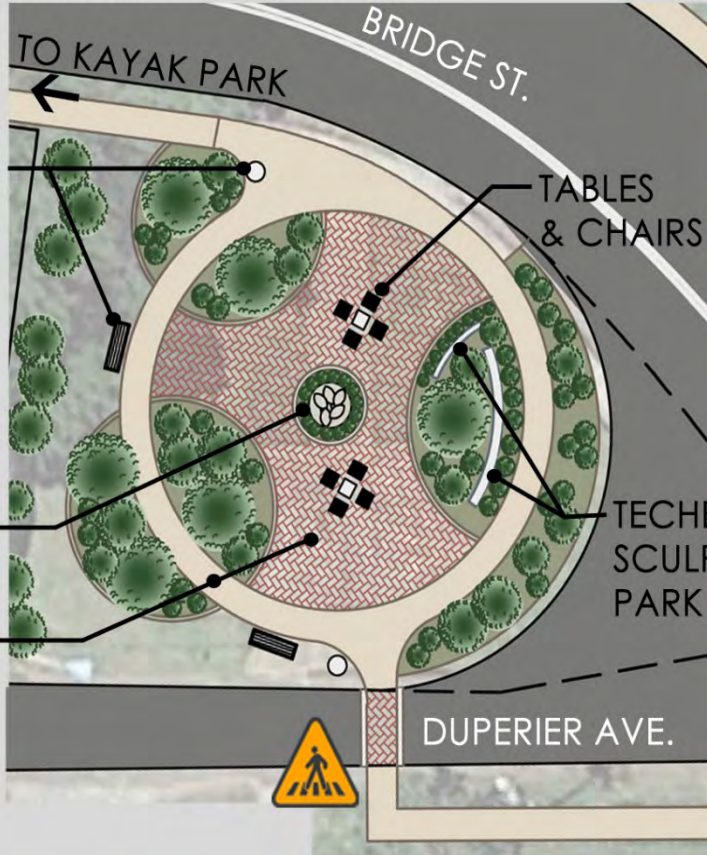

PRECEDENT IMAGES:



- NEW POCKET PARK FOR RESIDENTS & VISITORS
- UNIQUE VANTAGE POINT DOWN DUPERIER AVE. & OLD MOUNT CARMEL SCHOOL
 - GATEWAY ACCESS POINT TO THE ADJACENT KAYAK LAUNCH PARK,
 - SCULPTURES AND ART INSPIRED BY THE BAYOU TECHE
 - CANOE / KAYAK SCULPTURE, TECHE 'SNAKE' SCULPTURE, ETC.

Bayou Teche

Canoe/Kayak Park

ENLARGED SITE PLAN:

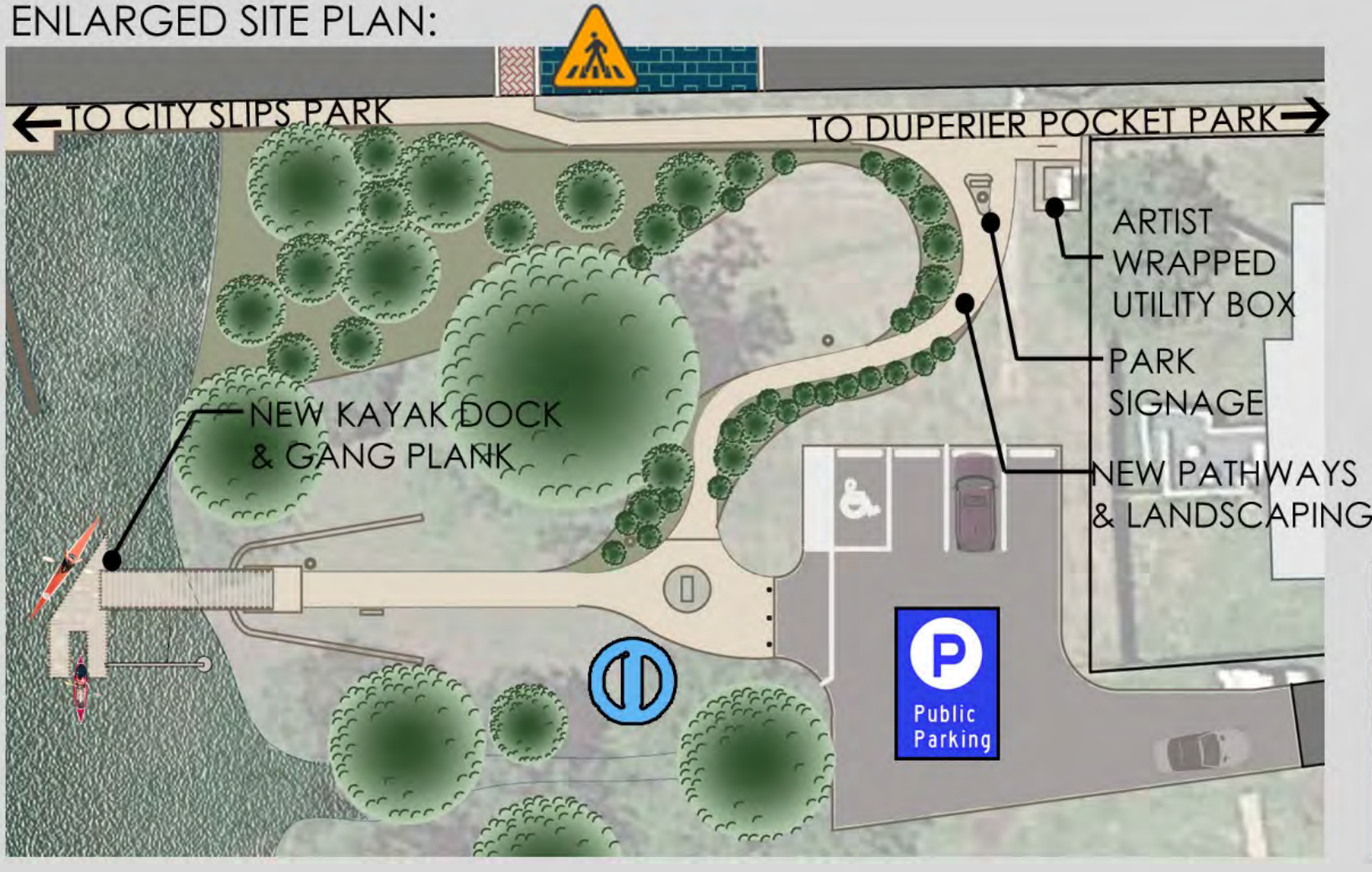

- UTILIZE SITE FOR ADDITION OF NEW FLOATING A.D.A. ACCESSIBLE KAYAK LAUNCH PAD
- PROMOTES ECOTOURISM ALONG THE BAYOU TECHE AND ENCOURAGES USE OF A NATIONAL WATER TRAIL
- INVITES PADDLERS THAT PASS THROUGH NEW IBERIA TO STOP AND ENJOY HISTORIC DOWNTOWN
- PROMOTES OUTDOOR PADDLING ACTIVITIES
- COMPLEMENTS LOCAL EVENTS AND ORGANIZATIONS, EX.: TOUR DE TECHE RACE, TRASH BASH AND BOOGIE, TECHE PROJECT, ETC.

Bayou Teche Canoe/Kayak Park

PRECEDENT IMAGES:



Duperier Ave.

Bridge Refurbishment & Lighting

PROPOSED RENDER



- REFURBISH HISTORIC BRIDGE, CIRCA 1944, WITH FRESH PAINT, CLEANED SURFACES, AND NEW VINTAGE LIGHT POLE FIXTURES
- ADD ARTISTICALLY RENDERED LETTERS SPELLING 'NEW IBERIA, LOUISIANA' TO EXISTING PANELS OF METAL ARCH TO GIVE A PRIDE OF PLACE & WELCOMING SIGN TO BOTH BOATING TRAFFIC & PEDESTRIANS

City Slips Park



DOWNTOWN CONNECTION TO BAYOU TECHE, AN OFFICIALLY DESIGNATED NATIONAL WATERWAY GIVES BOATING TRAFFIC ACCESS TO DOWNTOWN

PROMOTES TOURISM WITH EMPHASIS ON BOATING ACTIVITIES AND POSSIBLE BOAT TOUR EVENTS

City Slips Park

PRECEDENT IMAGES:

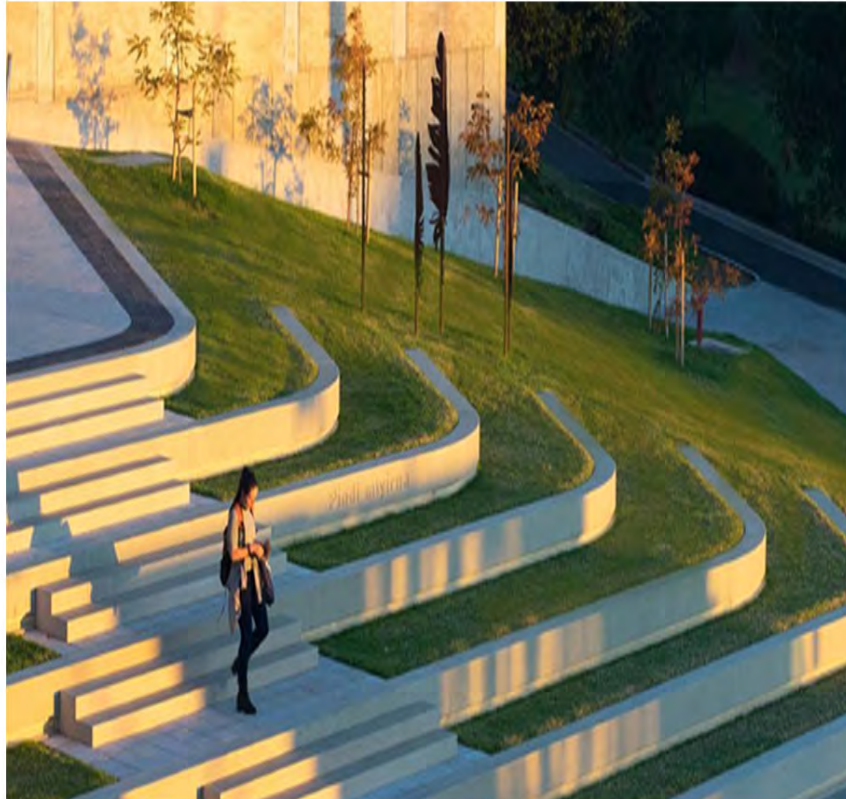

Bayou Teche

Boardwalk Trail Refurbish & Expansion

PRECEDENT IMAGES:



EXISTING WOOD BOARDWALK TO BE REPLACED WITH ON GRADE CONCRETE PATHWAY LINED WITH LIGHTING, LANDSCAPING, AND BENCH SEATING

EXPANSION OF EXISTING PATH TO CONNECT TO MAIN STREET ALONG WEEKS STREET.

George Rodrigue Park & Rear Parking Lot

ENLARGED SITE PLAN:

PROPOSED RENDERS:



CONSTRUCTION OF POCKET PARK CELEBRATING THE LIFE AND WORK OF PROMINENT LOCAL ARTIST, GEORGE RODRIGUE, INCLUDING AN ORIGINAL BLUE DOG SCULPTURE, BIOGRAPHY INFORMATION, A LIVE OAK TREE, AS WELL AS LANDSCAPING, BENCHES AND 7 ADDITIONAL ANGLED PARKING SPOTS

REAR PARKING LOT ADDITION TO ADD 41 ADDITIONAL PARKING SPOTS TO DOWNTOWN WHILE INCLUDING INTEGRATED LANDSCAPING AND ACCESS TO ADJACENT PARKS AND WALKING TRAILS

Bayou Teche Museum

Doc Voorhies Wing Expansion

- RESTORATION & CONVERSION OF 5,000 SQ. FT. HISTORIC DOWNTOWN BUILDING INTO ADDITIONAL GALLERY AND SUPPORT SPACE FOR MUSEUM
- NEW 6,000 SQ. FT. REAR ADDITION TO BE BUILT ADJOINING HISTORIC BUILDING AND WILL BE USED TO FOR CLASSROOMS, ARCHIVING, AND MUSEUM PROGRAM SUPPORT
- DESIGN AND CONSTRUCTION WILL BE DONE TO MEET DEPARTMENT OF INTERIOR STANDARDS FOR HISTORIC REHABILITATION



Bayou Teche Museum

Doc Voorhies Wing Expansion

PROPOSED 1ST FLOOR PLAN:

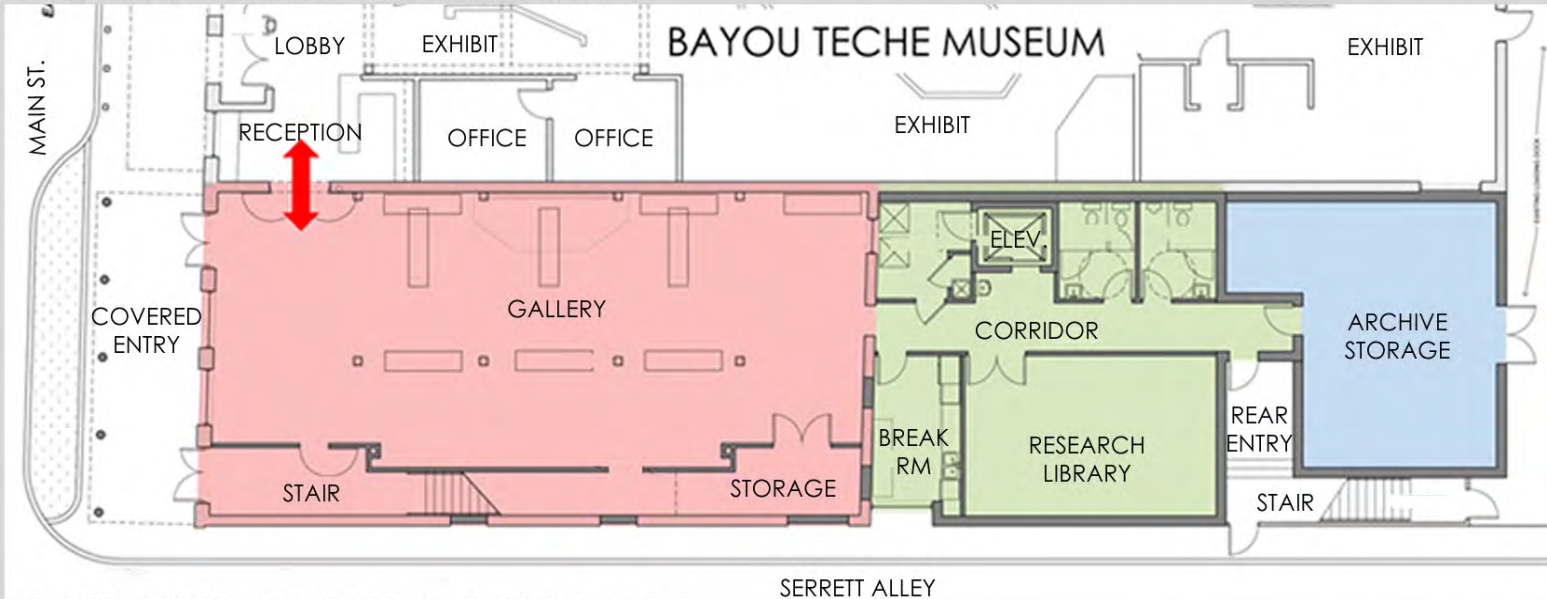

PROPOSED RENDERS:



PROPOSED 2ND FLOOR PLAN:

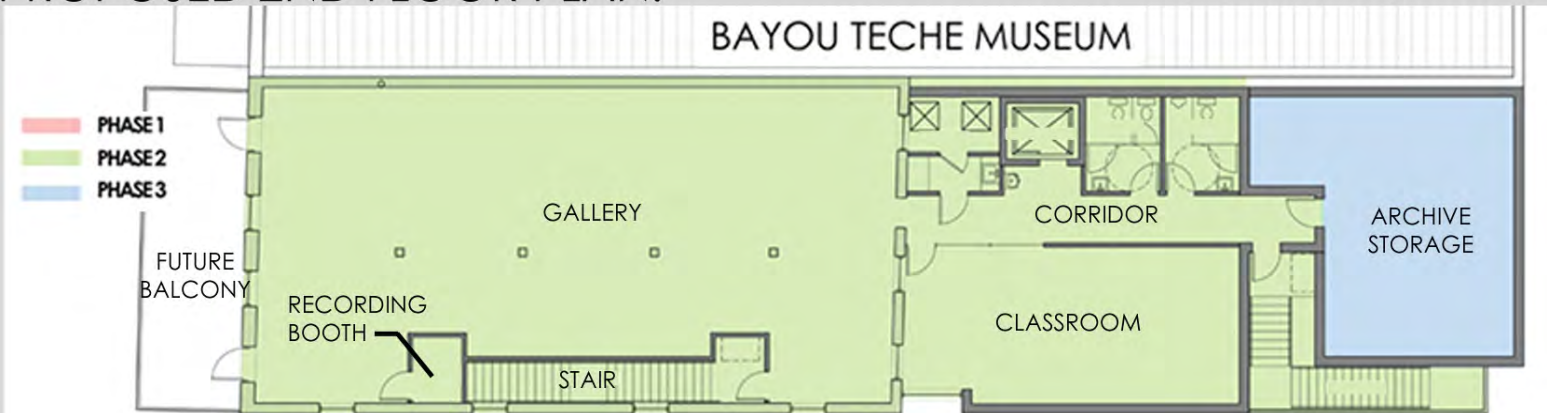

Sliman Theater Marquee Refurbishment

ARCHITECT SKETCH:

PAST PHOTOS:

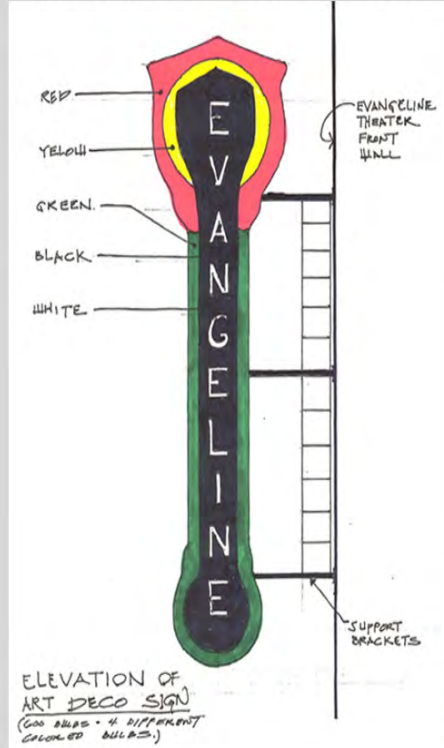

RESTORE THE ICONIC 'EVANGELINE' SIGN AND MARQUEE WITH WORKING NEON BULBS, FLASHING PERIMETER INCANDESCENT BULBS, FRESH PAINT AND REPLACEMENT OF DAMAGED SIGNAGE PANELS

LIVENS UP DOWNTOWN AT NIGHT WHEN LIGHTS ARE ON AND CREATES A CAPTIVATING VIBRANCY THAT LEAVES AN IMPACT ON ITS VIEWERS

Church Alley Enhancement – Phase 2

ENLARGED SITE PLAN:

PROPOSED RENDER:

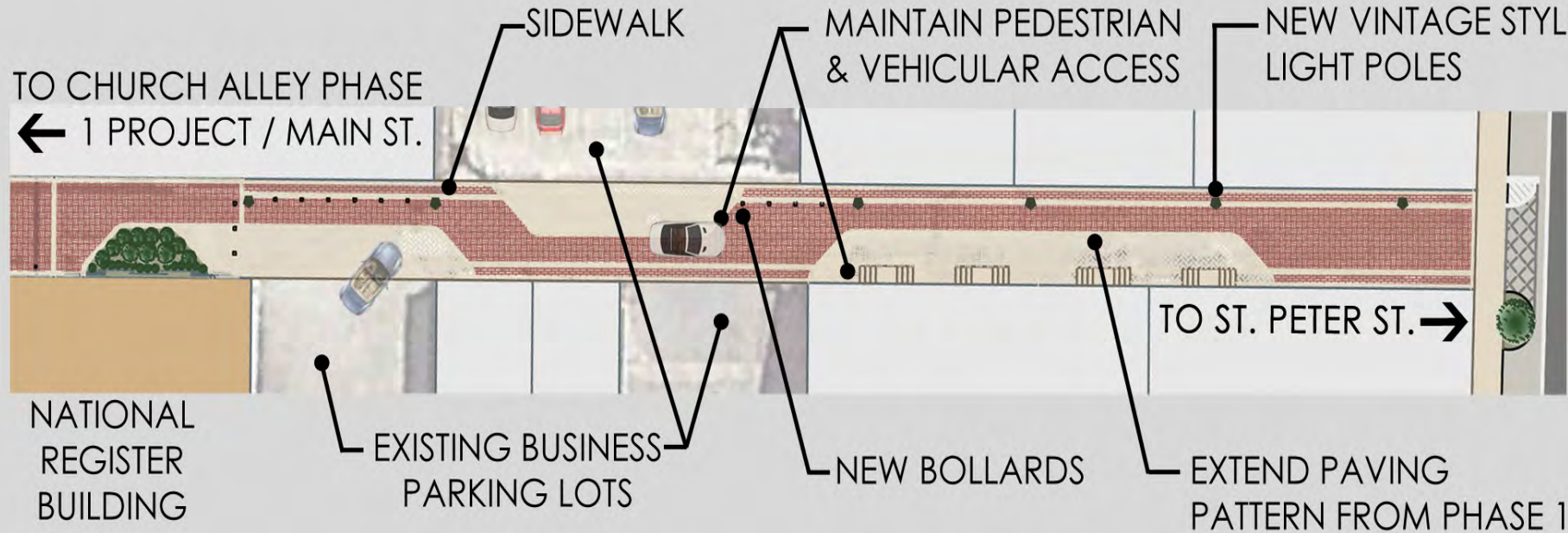

EXPAND PAVER STONE PATTERN FROM PHASE 1 OF CHURCH ALLEY POCKET PARK TO ST. PETER ST.; ADD LIGHTING, & LANDSCAPING, AND EMPHASIS ON PEDESTRIAN ATMOSPHERE WHILE DEFINING THE SEPARATION OF VEHICULAR USE

CREATES AN INTRIGUING & UNIQUE ATMOSPHERE THAT ENCOURAGES LOCALS / VISITORS TO VENTURE FROM MAIN ST. TO OTHER AREAS WITHIN THE DISTRICT AND PROMOTES BUSINESSES ADJACENT TO THE ALLEY

Civic Center

Property Enhancement Overview



Civic Center Marina & Pocket Park



- **LARGE VESSEL DOCKING FACILITY FOR TRANSIENT BOATERS**
- **PROMOTES TOURISM & INCREASES BOATING ACCESS / CIRCULATION AROUND THE HISTORIC DISTRICTS**
- **ENCOURAGES NEW BOATING FOCUSED EVENTS AND FESTIVALS**
- **POCKET PARK TO INCLUDE SMALL LOOP WALKING TRAIL, PICNIC TABLES, BENCHES, AND LIGHTING; FUTURE EXPANSION OF THE PARK COULD INCLUDE LOCAL ARTIST'S SCULPTURES AS A PUBLIC SCULPTURE GARDEN AMENITY**
- **16 NEW PARKING SPACES TO BE ADDED IN PARKING LOT EXPANSION TO ACCOMMODATE ACCESS TO MARINA AND POCKET PARK**

Civic Center Marina & Pocket Park

PRECEDENT IMAGES:



Clean Vessel Act Relocation & Water Quality Testing Pier

EXISTING C.V.A. TO BE RELOCATED:



WATER QUALITY MONITOR:

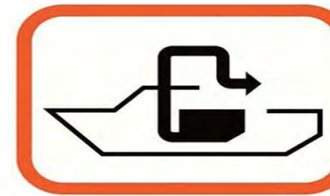

**KEEP OUR
WATER CLEAN-
USE PUMPOUTS**

PIER PRECEDENT:



- EXISTING FLOATING RESTROOMS AND SANITARY PUMP OUT SYSTEM TO BE MOVED BEHIND CITY HALL
- BOATERS WITH SEPTIC SYSTEM WILL BE ABLE TO PROPERLY EMPTY SEPTIC SYSTEMS INTO CITY SEWER SYSTEM AND NOT INTO THE BAYOU TECHE
- WATER QUALITY MONITORING SYSTEM INSTALLED AT NEW PIER TO TEST WATER QUALITY; ENCOURAGES AWARENESS TO PUBLIC OF THE CONDITIONS OF THE BAYOU TECHE; PIER COULD ALSO DOUBLE AS AN PEDESTRIAN ACCESSIBLE FISHING PIER







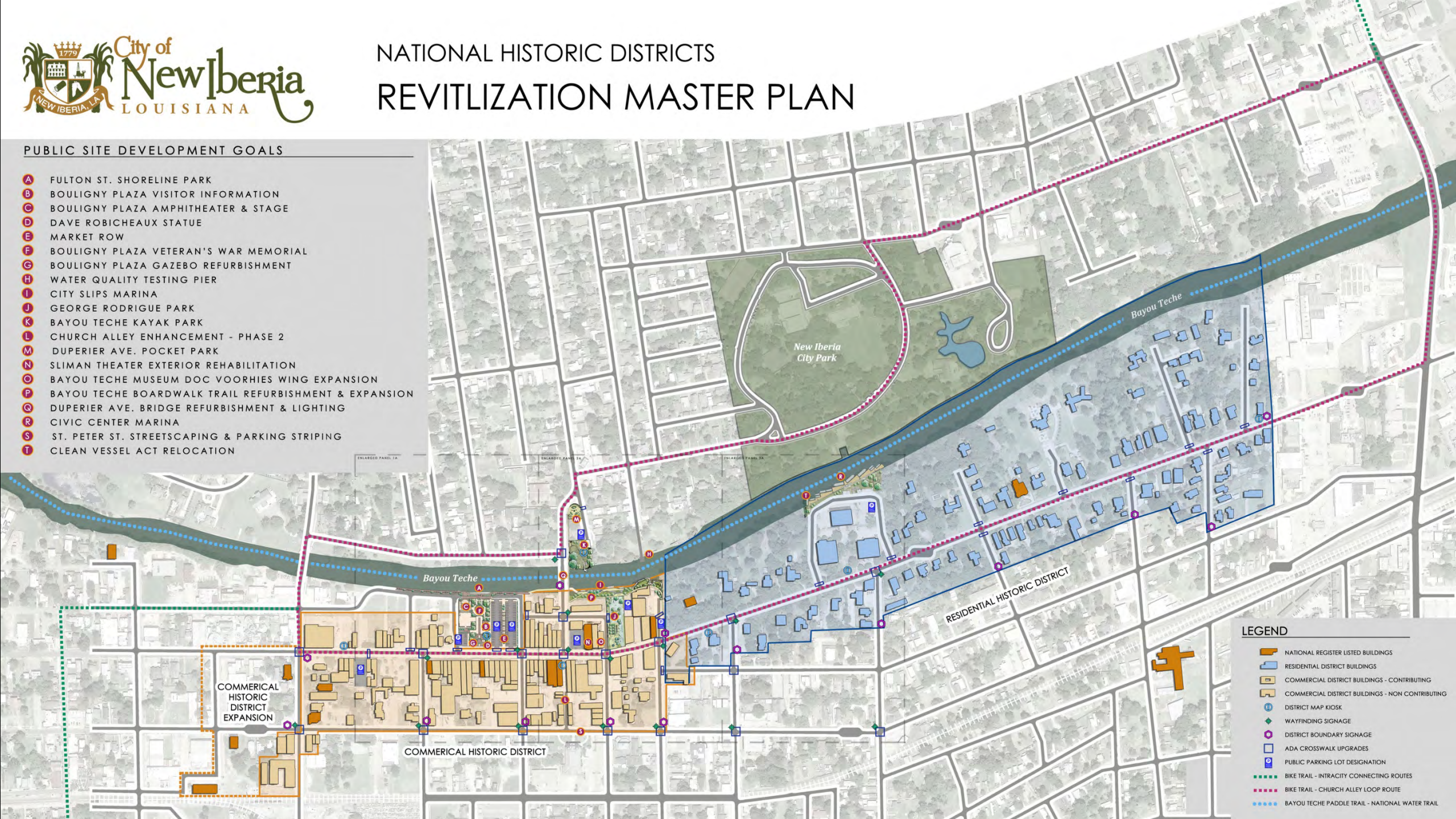

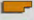

NATIONAL HISTORIC DISTRICTS REVITALIZATION MASTER PLAN

PUBLIC SITE DEVELOPMENT GOALS

- A** FULTON ST. SHORELINE PARK
- B** BOULIGNY PLAZA VISITOR INFORMATION
- C** BOULIGNY PLAZA AMPHITHEATER & STAGE
- D** DAVE ROBICHEAUX STATUE
- E** MARKET ROW
- F** BOULIGNY PLAZA VETERAN'S WAR MEMORIAL
- G** BOULIGNY PLAZA GAZEBO REFURBISHMENT
- H** WATER QUALITY TESTING PIER
- I** CITY SLIPS MARINA
- J** GEORGE RODRIGUE PARK
- K** BAYOU TECHE KAYAK PARK
- L** CHURCH ALLEY ENHANCEMENT - PHASE 2
- M** DUPERIER AVE. POCKET PARK
- N** SLIMAN THEATER EXTERIOR REHABILITATION
- O** BAYOU TECHE MUSEUM DOC VOORHIES WING EXPANSION
- P** BAYOU TECHE BOARDWALK TRAIL REFURBISHMENT & EXPANSION
- Q** DUPERIER AVE. BRIDGE REFURBISHMENT & LIGHTING
- R** CIVIC CENTER MARINA
- S** ST. PETER ST. STREETSCAPING & PARKING STRIPING
- T** CLEAN VESSEL ACT RELOCATION

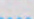

LEGEND

-  NATIONAL REGISTER LISTED BUILDINGS
-  RESIDENTIAL DISTRICT BUILDINGS
-  COMMERCIAL DISTRICT BUILDINGS - CONTRIBUTING
-  COMMERCIAL DISTRICT BUILDINGS - NON CONTRIBUTING
-  DISTRICT MAP KIOSK
-  WAYFINDING SIGNAGE
-  DISTRICT BOUNDARY SIGNAGE
-  ADA CROSSWALK UPGRADES
-  PUBLIC PARKING LOT DESIGNATION
-  BIKE TRAIL - INTRACITY CONNECTING ROUTES
-  BIKE TRAIL - CHURCH ALLEY LOOP ROUTE
-  BAYOU TECHE PADDLE TRAIL - NATIONAL WATER TRAIL

City of New Iberia

City of New Iberia has created a comprehensive 'urban redevelopment master plan' for the downtown districts. The purpose of the plan is to carry the community into an active future and expand off the positive growth that exists; creating smart growth.

The plan focuses on the city's economic development, enhancing tourism; and foremost the plan focuses on preserving downtown New Iberia's history. With keeping this focus in mind, the plan maps out future public developments in downtown New Iberia.

Plan Designers:



Jane Braud



Freddie DeCourt, Mayor

Grant funds for this project was
provided by:



National Trust *for*
Historic Preservation™

Working together to save places for the
next generation.