

More to Explore

Government.....	2-3
Emergency Services	3
Howe	4
LaGrange.....	4
Shipshewana	5
Topeka	5
Wolcottville	6
Lakeland School Corporation	7
Prairie Heights Community School Corporation	7
Westview School Corporation	7
Community Services	8
Events.....	9
Parks & Recreation	10
Health & Human Services	11-12
Community Groups	13
Churches	14-18

To update information or
get your organization event added
to the next community guide,
email mgetts@kpcmedia.com



Jenny Ernsberger
jernsberger@kpcmedia.com
General Manager

Ann Saggars
asaggars@kpcmedia.com
Print & Design Manager

Stevie Lockridge
slockridge@kpcmedia.com
Special Sections Graphic Designer

Sue Carpenter
scarpenter@kpcmedia.com
Special Sections Editor

ACCOUNT EXECUTIVES
Mitch Anderson
Lisa Burnett
Michele Trowbridge
Machele Waid

LaGrange County Community Guide is
a special supplement to The News Sun,
which is a publication of KPC Media.
©2025 All rights reserved

Contents

4-6

Communities

Information pertaining to each town in the county, including government, education, utilities, post office and library information.

7

Education

Information about each of the school corporations with districts in LaGrange County including contact information and district boundaries.

9

Events

Events and festivals throughout the county.

14-18

Churches

Many churches throughout the county.

A Real Community Bank That Works Hard For You Every Day.

At Farmers State Bank, all decisions are locally made. We meet the needs of both individuals and businesses with our range of accounts and loan options. Drop by today to join our Farmers State Bank family and discover the true essence of Blue Button Banking.



888.492.7111
www.GoFSB.com



Government

Important County Government Addresses

LaGrange County Office Building
114 W. Michigan St., LaGrange

LaGrange County Courthouse
105 N. Detroit St., LaGrange

LaGrange County Annex Building
105 N. High St., LaGrange

LaGrange County Jail
875 S. S.R. 9, LaGrange

LaGrange County EMS
982 N. Townline Road, LaGrange

County Government Contact Information

Assessor
Pat Monroe
County Office Building
499-6318

Auditor
Kathy Hopper
County Office Building
499-6310

Clerk
Kimberley Johnson
Courthouse
499-6372

Board of Commissioners Members
Terry Martin, Peter Cook,
Kevin Myers
County Office Building

Circuit Court Judge
Bill Walz
LaGrange County Courthouse

Coroner
Jeremy Hoover
LaGrange County EMS
463-9493

County Council Members
Jeff Campos, Ryan Riegsecker,
Harold Gingerich, Jim Young, Jeff
Brill, Karen Eagleson and Mike
Strawser
County Office Building
463-6314

Prosecuting Attorney
Travis Glick
County Office Building
499-6326

Recorder
Sheila Getz
County Office Building
499-6320

Sheriff
Tracy Harker
LaGrange County Jail
463-7491

Superior Court Judge
Lisa Bowen-Slaven
Courthouse

Surveyor
Zachary Holsinger
499-6307

Treasurer
Connie Brower
County Office Building
499-6315

Township Trustees

Bloomfield Township
William L. Pipher
818 Sn. Detroit St., LaGrange
Home 463-3411
Work 463-3411
Email: trustee@bloomfieldtownship.org

Clay Township
Deb Muntz
1090 S. C.R. 00EW, LaGrange
463-2151
Email: trustee4claytpw@gmail.com

Clearspring Township
Melisa Eicheberger
2750 W 200S, LaGrange
(260)350-5839
Email: mecclearspringtrustee@gmail.com

#1 Commercial Credit Union Lender in the U.S.*

INcredible!

With the ability to loan up to \$20 million, from lines of credit and term loans to investment and rental property, Interra gives businesses competitive rates and attractive terms to help them take advantage of every opportunity.¹

See how Interra can help you succeed at interracu.com/business.

INterra
CREDIT UNION

*Callahan & Associates, 2023. ¹Not all who apply will be approved.

AMERICAN SHARE INSURANCE Your savings insured to \$250,000 per account. By members' choice, this institution is not federally insured.

Government

Eden Township

Staci Smith
8770 W650 S, Topeka
(260)593-2939
Email: edenstownship@yahoo.com

Greenfield Township

Peggy Whitlock
11775 E. C.R. 600N,
Orland
463-6511
Email: edentownship@yahoo.com

Johnson Township

Amy McKowen
4935 E 580S, Wolcottville
(260)463-6511
Email: greenfieldtownshiptrustee@yahoo.com

Lima Township

Terry Iannareli
303 Williams St., P.O. Box
73, Howe
585-9284
Email: tjianarelli@embarqmail.com

Milford Township

Bruce Bowman
4575 S 890E Wolcottville
351-9103
Email: bowman46795@yahoo.com

Newbury Township

Brandie Fitch
P.O. Box 184, 365 E. Main
St., Shipshewana
768-7330
Email: newburytownshiptrustee@gmail.com

Springfield Township

Sherri Johnston
9750 E 100N, LaGrange
367-2362
Email: sprtwplagco@gmail.com

VanBuren Township

Bruce Miller
7010 N. C.R. 900W,
Shipshewana
768-9181
Email: homedad5@hotmail.com

County Boards

- Alcoholic Beverage Board
- Board of Zoning Appeals

- Convention & Visitors Tax Commission
- Economic Development Commission
- Health Board
- Library Board
- Park & Recreation Board
- Plan Commission
- Plat Committee
- Property Tax Assessment Board of Appeals
- Public Defender Board
- Redevelopment Commission
- Sewer Board

State Government Contacts

State Sen. Sue Glick (R), District 13
(317) 232-9400 or
(800) 382-9467 during session
Email: Senator.Glick@iga.in.gov
Website: indianasenatepublicans.com/glick
Sen. Glick represents LaGrange and Noble counties, as well as eastern Kosciusko County, western Steuben County and northwest DeKalb County.

State Rep. Tony Isa (R), District 51
317-232-9736 or
(800) 382-9841 during session
Email: H51@iga.in.gov
Website: www.indianahousepublicans.com/members/general/tony-isa
Rep. Isa represents all of LaGrange County and part of Steuben County.

Federal Government Contacts

Senator Todd Young
(202) 224-5623
400 Russell Senate Office Building,, Washington, D.C., 20510
Website: young.senate.gov

Senator Jim Banks
(202) 224-4814
B85 Russell Senate Office Building, Washington D.C., 20510
Website: banks.senate.gov

Representative Marlin Stutzman
(202) 225-4436
1713 Longworth HOB Washington D.C., 20515
Website: stutzman.house.gov

Fort Wayne office
(260) 702-4750
1300 S. Harrison St., Fort Wayne, IN 46802

Emergency Services

For all emergencies call 911

LaGrange County Sheriff's Department Sheriff

Tracy Harker
County Jail
0875 S. S.R. 9
Department Business Line
463-7491

Indiana State Police Fort Wayne Post
(800) 552-0976

U.S. Marshals Service Northern District of Indiana headquarters
U.S. Courthouse and Federal Building, 5400 Federal Plaza, Hammond

(219) 852-6776/(574) 236-8291
Fort Wayne Office
Federal Building, 1300 S. Harrison St., Fort Wayne
423-4667/(574) 236-8291

Parkview LaGrange County Emergency Medical Service

EMS services in LaGrange County are provided through a partnership between Parkview LaGrange Hospital and LaGrange County to ensure residents have quick access to emergency medical services 24 hours a day, seven days a week. Call 911 for emergency medical assistance.



Howe

Howe At A Glance

Population
803 (2024)

Police
LaGrange County Sheriff's Dept.

Fire
Howe Volunteer Fire Dept.

Health
LaGrange Parkview Hospital

Utilities
Electric: NIPSCO & LaGrange County REMC
Natural Gas: NIPSCO
Phone: CenturyLink
Internet: CenturyLink

Education
Lakeland School Corporation

Parks
Town Square Park, Pine Knob Park

Attractions
Pigeon River Fish & Wildlife Area, Cedar Lake Golf Course

Events
Lions Club Ice Cream Social, Indian Summer Days

Important Numbers & Addresses

Police
0875 S. S.R. 9, LaGrange

463-7491

Fire
175 W. S.R. 120
562-2618
Fire Chief: Larry Watson

Hospital
207 N. Townline Road, LaGrange
463-9000

Post Office
(260) 562-2191
404 Defiance St.
Hours: M-F 8:30-10:30 a.m., noon-4 p.m., Sat 9-11 a.m.

Recycling:
State Department Building, Nursery Street, LaGrange



MATT GETTS

Members of the Dan Lawrence family pose Oct. 3 before turning over the first dirt for the new Lawrence Lodge to be constructed at Camp Potawatomi in LaGrange County. The camp is owned and operated by the YMCA of Greater Fort Wayne.

LaGrange

LaGrange At A Glance

Population
2,775 (2024)

Government
Town council, town manager, clerk-treasurer

Fire
LaGrange Fire Department

Police
LaGrange Police Department

Utilities
Water and sewer provided by the city
Natural Gas: NIPSCO
Electric: NIPSCO, LaGrange County REMC
Phone: CenturyLink, Internet: MediaCom, CenturyLink

Education
Lakeland School Corporation

Parks
Town park

Health
Parkview LaGrange Hospital

Attractions
Maple Wood Nature Center

Events
LaGrange County 4-H Fair, Gas & Steam Show, Corn School, Maple Syrup Days

Important Numbers & Addresses

Town Hall
1201 N. Townline Road

Police
1201 N. Townline Road
463-7031

Town Marshal:
Richard Snyder

Fire
1201 N. Townline Road
463-3139

Fire Chief:
Jeremy Edwards

Hospital
207 N. Townline Road
463-9000

Post Office
300 S. Detroit St.
463-2844
Hours: M-F 9 a.m.-4:30 p.m., Sat 9-11 a.m.

Library
LaGrange County Public Library
203 W. Spring St.
Hours: M-Th 9 a.m.-8 p.m., F-Sat 9 a.m.-5 p.m.
Website: www.lagrange.lib.in.us/

Recycling
LaGrange Street Department, Nursery Street, LaGrange

Meetings

Town Council
1st and 3rd Mondays of the month at 6 p.m. at Town Hall

Proud to be part of a great community.

Contact or visit us at our LaGrange office today.

Beers|Mallers
ATTORNEYS AT LAW

108 W. Michigan Street, LaGrange, IN 46761

beersmallers.com
260.463.4949



JAMIN B. BENTRUP - KURT R. BACHMAN - TONY B. MANNIS



CONTRIBUTED

Barb Mulholland, Adams Lake historian and long-time resident, was the grand marshal of the 2024 Boat Parade on July 6, sponsored by the Adams Lake Conservation Club, Wolcottville. Eighteen cottages participated, with many businesses providing prizes. Jodi Heeter chaired the event.

Shipshewana

Shipshewana At A Glance

Population
866 (2024)

Government
Town council, clerk-treasurer, town manager

Fire
Shipshewana Volunteer Fire Department

Police
Shipshewana Police Department

Health
Parkview LaGrange Hospital

Utilities
Water, storm drainage and wastewater services are provided by the town
Electric: NIPSCO & LaGrange County REMC
Natural Gas: NIPSCO, Internet: CenturyLink, Phone: CenturyLink

Education
Westview School Corporation

Parks
Wolfe Park, Shipshewana Community Park

Events
Mayfest, Shipshewana Quilt Festival, Antique Festival, Fall Crafters Fair, Ice Festival

Important Numbers & Addresses

Town Hall
345 N. Morton St.

Police
345 N. Morton St.
786-4310
Town Marshal:
Carlos Jasso

Fire
1100 N. Van Buren St.
768.4743
Fire Chief: Lyle Wingard

Hospital
207 N. Townline Road, LaGrange
463-9000

Post Office
355 Main St.
768-4172
Hours: M-F 8 a.m.-noon, Sat 8-10 a.m.

Library
LaGrange County Public Library-Shipshewana Branch
250 Depot St.
768-7444
Hours: M-F 11:30 a.m.-6 p.m., Sat 8:30 a.m.-3 p.m.

Recycling
LaGrange Street Department, Nursery Street, LaGrange

Meetings

Town Council
2nd and 4th Thursdays of the month at 6 p.m. at Town Hall



LISA ESQUIVEL LONG
Dutch Creek Farm Animal Park has been open May to October at 6255 N. C.R. 1000W, Shipshewana, featuring a wide variety of common and exotic animals. Some of the animals have been sold following USDA violations and a federal district court decree.

Topeka

Topeka At A Glance

Population
1,237 (2024)

Government
Town council, town manager, clerk-treasurer

Police
Topeka Police Department

Fire
Topeka Volunteer Fire Department

Health
Parkview LaGrange Hospital

Utilities
Water, storm drainage and wastewater services provided by the town
Electric: NIPSCO & LaGrange County REMC
Natural Gas: NIPSCO
Phone: CenturyLink
Internet: LigTel, CenturyLink

Education
Westview School Corporation

Parks
East Park, West Park

Important Numbers & Addresses

Town Hall
124 E. Lake St.
593-2300

Police
101 S. Main St.
593-2822
Town Marshal:
Stan Starter

Fire
120 Crossfire
593-2883
Fire Chief:
Stewart Bender

Hospital
207 N. Townline Road, LaGrange
463-9000

Post Office
129 E. Lake St.
593-2199
Hours: M-F 8:30 a.m.-12:30 p.m., 2-4 p.m., Sat 8:30-10:30 a.m.

Library
LaGrange County Public Library-Topeka Branch
133 N. Main St.
593-3030
Hours: M-F 11:30 a.m.-6 p.m., Sat 8:30 a.m.-3 p.m.

Recycling/Compost Center
Behind 302 W. Lake St.

Meetings

Town council
2nd and 4th Monday of the month at 4 p.m. at Town Hall

Find your favorite Miller Poultry or Katie’s Best products at a local store near you!



Learn more on our websites at
www.millerpoultry.com
www.katiesbestchicken.com

INDEPENDENCE FOR RESIDENTS.
PEACE OF MIND FOR THEIR FAMILIES.

Cameron Woods is the area’s only full-service not for profit senior living community.

Cameron Woods offers an ideal mix of privacy and support for seniors. Choose from furnished or unfurnished apartments for short- or long-term stays.

Understand, Cameron Woods is not a nursing home. We’re a residential community completely open to friends and family. And we offer a range of group and individual programs to keep residents active and engaged.

For more information or to schedule a private tour, visit cameronwoods.com or call 260-624-2197.





CAMERON WOODS
SENIOR LIVING COMMUNITY

Wolcottville

Wolcottville At A Glance

Population

1,030 (2024), split nearly evenly between LaGrange and Noble counties

Government

Town council, clerk-treasurer

Police

Wolcottville Police Department

Fire

Johnson Township Volunteer Fire Department

Health

Parkview LaGrange Hospital

Utilities

Water, sewer and garbage services are provided by the town, Electric: LaGrange County REMC Natural Gas: NIPSCO Phone: CenturyLink,

LigTel Internet: Mediacom, CenturyLink, LigTel

Education

Lakeland School Corporation, East Noble School Corporation

Parks

Taylor Park, Wolcott Park, Martin Park, Dallas Lake Park

Events

Wolcottville Mill Festival

Attractions

Indian Lakes chain

Important Numbers & Addresses

Town Hall

103 Myers St.
854-3151

Police

103 W. Myers St.
854-2930

Town Marshal:

Nate Sprunger

Fire

600 W. County Line Road
854-4545
Email: st50firechief@gmail.com

Hospital

207 N. Townline Road, LaGrange
463-9000

Post Office

105 N. Main St.
854-2314

Hours: M-F

8:30 a.m.-1 p.m., Sat
8:30-11:30 a.m.

Nearest Recycling/ Compost Center

Rome City

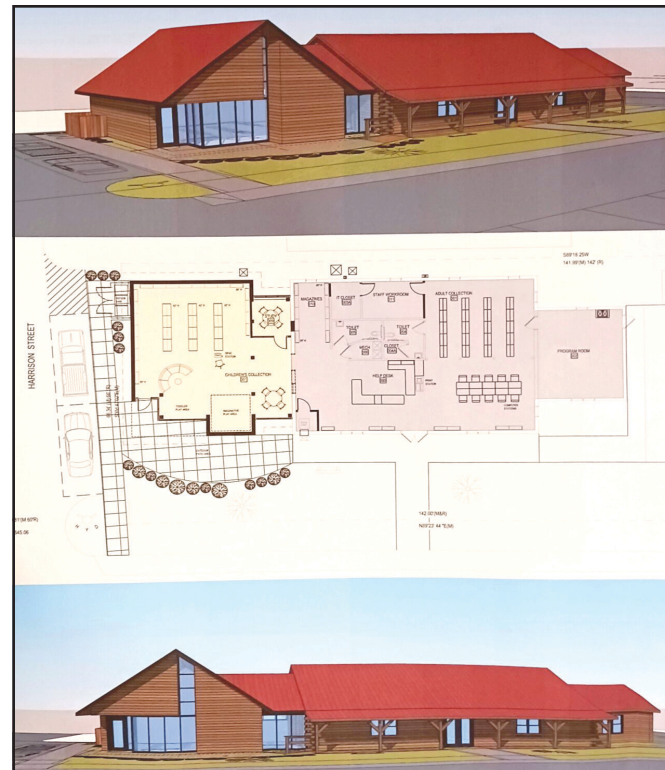

CONTRIBUTED

This architectural rendering shows plans for an addition to the Shipshewana branch of the LaGrange County Public Library. The area on the left side, shown in beige, will be a new youth wing.



The Leader in PVC Compounds and Quality Colorants for Plastics

*We are very proud to support
our local communities!*

800-643-3323 • www.color-master.com

**NORTHEASTERN
CENTER**
YOUR COMMUNITY COUNSELING CENTER

*Offering hope,
recovery and a
path forward*



LaGrange Outpatient
2155 North State Road 9
LaGrange, IN 46761



Local Appointments
260-463-7144



**Emergency Mental
Health Solutions**
1-800-790-0118



More Resources
www.nec.org

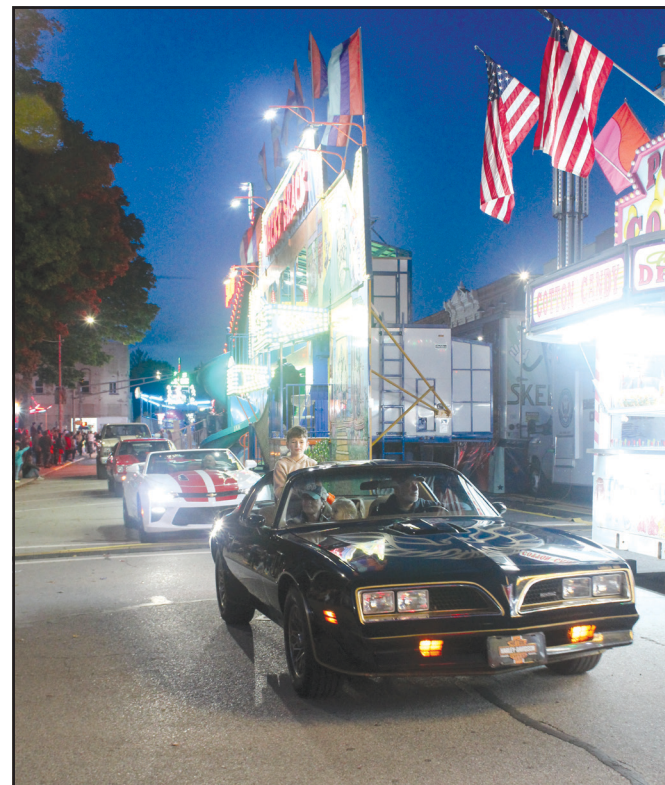

AMY OBERLIN

Hot rods, Scouts, civic groups and marching bands were featured in parades nightly during the 2024 Corn School in downtown LaGrange.

Lakeland School Corporation

Enrollment
1,682

Website
www.lakelandlakers.org

Superintendent
Traci Blaize

Board Members
Brett Bateman, Derrick Sherck, Robert West, Shelly Gould, Sue Keenan and Kara Howard

Lakeland Primary (K-5)
1 LeMaster Circle, LaGrange
499-2430

Principal: Kim Kabrich

Lakeland Intermediate School (5-7)
1055 E. C.R. 75N, LaGrange
499-2480

Principal: Brad Jones

Lakeland Jr./Sr. High School (9-12)
0805 E. C.R. 75N, LaGrange
499-2470

Principal: Jason Schackow

Westview School Corporation

Enrollment
2,107

Phone
768-4404

Website
westview.k12.in.us

Superintendent
Randy Miller

Board Members
Keith Lambright, Carrie Schrock, Chad Bender, Chuck Christner, Tobey Schwartz

Meadowview Elementary School (K-4)
7950 W. C.R. 050S, Shipshewana
768-7702

Principal: Juli Leeper

Shipshewana-Scott Elementary School (K-4)
325 W. Middlebury St., Shipshewana
768-4158

Principal: Amy Garber

Topeka Elementary School (K-4)
138 School St., Topeka
593-2897

Principal: Alissa McDonald

Westview Elementary School (5-6)
1715 S. C.R. 600W, Topeka

Principal: Alyssa McDonald

Westview Jr./Sr. High School (7-12)
1635 S. C.R. 600W, Topeka
768-4146

Senior High Principal: Tim Wilson

Junior High Principal: Elias Rojas

Prairie Heights Community School Corporation

Enrollment
1,306

Website
ph.k12.in.us

Superintendent
Jeff Reed

Board Members
Todd Perkins, Heather Culler, Jesslyn Senecal, Aaron Pfafman, Jamie Staton

Prairie Heights Elementary School (K-4)
455 S. C.R. 1150E, LaGrange

Principal: Brian Wesson

Prairie Heights Middle School (5-8)
395 S. C.R. 1150E, LaGrange
351-3214

Principal: Andy Arndt

Prairie Heights High School (9-12)
245 S. C.R. 1150E, LaGrange
351-3214

Principal: Jeremy Swander



QUINN MILLER

A student consults her clipboard to see what a customer ordered as they may their way through the parking areas of Pleasant Lake Elementary Montessori School. Students wanted to do something to help the homeless over the holidays and they chose a sale to raise funds for Turning Point Homeless Shelter in Angola.

NOBLE COUNTY DISPOSAL

RESIDENTIAL & COMMERCIAL

**3, 4 & 6 YARD
CLEAN-UP CONTAINERS**

**ELECTRONIC & FLUORESCENT
DROP OFF LOCATION**

www.NCDisposal.com

800-292-9098

Community services

Natural Resources

LaGrange County is predominantly an agricultural community, with more than 70 percent of its land used for crops, pasture or hay. Cropland use varies throughout the county. Because the county has a large number of dairy operations and a

large Amish population, much of the land is in hay or pasture. Corn, soybeans and wheat are the major crops. LaGrange County has a number of organic farms producing organic dairy products, chickens and eggs. LaGrange County also has more than 16,000 acres of woodlands and

15,000 acres of wetlands. The Pigeon River Fish and Wildlife Area, maintained by the Indiana Department of Natural Resources, provides more than 11,700 acres of land for fishing, hunting and other recreational activities. LaGrange County offers a robust park system featuring forests, rivers,

lakes and a restored fen.

Curtis Creek Trout Rearing Station
4250 E. C.R. 400N, Howe
562-3855

Farm Service Agency
910 S. Detroit St.,
LaGrange
463-3166

Farm Credit Mid-America
50 N. C.R. 250W,
LaGrange
463-3233

Fawn River State Fish Hatchery
6889 N. S.R. 327, Orland
829-6241

District 2 headquarters
1353 S. Governors Drive,
Columbia City
244.3720

Indiana Department of Natural Resources Division of Fish and Wildlife
517 N. Warren Road,
Huntington
244-6805. DNR customer service: (317) 232-4200

LaGrange County Parks and Recreation Department
505 E. 700S, Wolcottville
854-2225

LaGrange County Farm Bureau Inc.
919 S. Detroit St.,
LaGrange
463-7184
Website: infarmbureau.org

LaGrange County Purdue Extension Services
LaGrange County Annex Building, 114 W. Michigan St., Suite 10, LaGrange
499-6334

LaGrange County Regional Utility District
2575 SR 9, LaGrange
499-6349

LaGrange County Soil & Water Conservation District
910 S. Detroit St.,
LaGrange,
463-3471, ext. 3

Pigeon River State Fish And Wildlife Area — Mongo Headquarters
8310 E. C.R. 300N
367-2164

LaGrange County Convention and Visitors Bureau
350 S. Van Buren St.,
Suite H, Shipshewana
(800) 254-8090
Website: visitshipshewana.org

LaGrange County Chamber of Commerce
901 S. Detroit St.,
LaGrange
(260) 463-2443 Executive Director — Sara Patrick
Executive Assistant: Karen Kistner
Website: www.lagrangechamber.org

Lakes Council

The LaGrange County Lakes Council is a membership group for people interested in the present and future welfare of the lakes and watersheds in LaGrange County.

Board meetings are on the fourth Thursday of each month (except November and December) at 7 p.m. in the LaGrange County Annex Building, 114 W. Michigan St., LaGrange. The public is invited to attend. To contact the lakes council, go to lagrangelakes.org.

The council and its programs are governed by a board of directors made up of representatives of many of the populated lakes in the county.

L & L LEWIS & LAMBRIGHT
AUCTIONEERING & REAL ESTATE

112 N DETROIT ST LAGRANGE, IN 46761

260-463-2013

Your Local Full Service Realtors

HABLAMOS ESPANOL

Denise - Broker/Owner 463-1244
Virgen 479-5503
John 463-1850
Elvie 463-1396
Jarrad 260-585-4557
Khamron 260-350-2914
Tyler 260-625-2874



La-R FOOTWEAR & GIFTS



LOWA
simply more...

- Wolverine • Carolina • Muck
- Brooks • Justin Boots • Georgia Boot
- Tingley • Drew • LaCrosse
- Sketcher Shoes & Sandals • Nothinz
- Clogs • Nordic Kitchenware • Gift Items
- Homemade Clothes • Hats
- Frogg Toggs Outerwear & Rainwear
- Berne Apparel & Outerwear
- Under Armor • Gravity Defyer



Lloyd & Roseanna Bontrager
496 E. Lake St. Topeka, IN **260-593-3709**
Mon.-Fri. 8-5 • Sat. 8-12



Obōz FOOTWEAR

KICK OFF THE OLD - STEP INTO THE NEW

Events

May

Shipshewana Mayfest
May 2-3, downtown
Shipshewana
Shipshewana
MayFest kicks off with
entertainment and food
at the main tent all day
long. Saturday morning
features a benefit pancake
and sausage breakfast,
a 3-on-3 basketball
tournament and a 5K road
run. Then at 10 a.m. is
the Grand Parade. After
the parade, there will
be buggy races, puppet
shows, art awards, magic
shows, kids' games, a
cornhole tournament, a
garden tractor pull and, of
course, a full day of food
and entertainment in the
main tent. The evening
is capped off by concerts
by two bands, and it's
free! All activities will be in
downtown Shipshewana
unless noted otherwise.

June

**Howe Lions Club
Ice Cream Social and
Band Concert**
Howe Town Square

Stroh Days
Stroh
A town-wide celebration
that includes a parade.

July

**Topeka 4th of July
Celebration**
All day at East Park
Softball games, road
run, breakfast at the fire
station children's games,
fireworks at dusk.

Wolcottville
4th of July celebration
Pancake and sausage
breakfast, kids games,
vendors and food, car
show, live music, fireworks
after dark

**LaGrange County
4-H Fair**
1030 E. C.R. 075N,

LaGrange
Concerts, rides, games,
rodeo, motocross, truck
pulls, Little Miss & Mister,
talent show, petting
zoo, juggler, stingray
encounter, butterfly
encounter, parade, pony
races, all new kids zone
and 4-H exhibits. 1c4hf.
com.

Old Fashion Farm Day
Dates TBD
Demonstrations of
by-gone equipment
and activity all day plus
exhibits on display along
with old fashion fun for the
children.

August

Antique Festival
Aug. 1-2, Shipshewana
Trading Place Pavilion.
Shop an outdoor pavilion
full of antique dealers
selling a variety of
antiques, collectibles,
furniture, salvage, signs,
glassware, toys, vintage
items, jewelry and more!

**LaGrange County
Habitat for Humanity
Annual Benefit Auction,**
Shipshewana Misc. &
Auction Barn, 345 S. Van
Buren St., Shipshewana
This one-day event
includes an auction of
handmade furniture and
quilts, antiques, tools,
gift certificates, an Amish
buggy, and miscellaneous
items. Food items include
a haystack supper,
sandwich line, homemade
ice cream, bake sale, fried
pies and 4-H beef and
pork.

**Annual Antique
Farm Power Steam
& Gas Show**
LaGrange County 4-H
Fairgrounds, 1030 E.
C.R. 075N, LaGrange
This year's event will
feature lesser knowns and
doodlebugs tractors and
farm equipment. There will

be steam engines, antique
tractors, gas engines,
antique farm machinery,
sawmills, arts and crafts,
large flea market, trading
post, camping, food and
more.

September

Indian Summer Days
Howe Town Square
Howe's celebration of
the fall season, including
a parade of local civic
organizations Saturday
afternoon:

October

Corn School
Downtown LaGrange
Indiana's oldest street
festival, featuring nightly
parades, rides and

carnival games.

Fall Crafters Fair
Oct. 2-4, Michiana Event
Center, 455 E. Farver St.
The Fall Crafters Fair is
a tribute to the crafting
and old-fashioned culture
in the surrounding
Shipshewana countryside.
Located inside the
Michiana Event Center,
you'll find artisans, vintage
sellers, hand-made items,
personalized gifts, and
much more!

November

**Light Parade & Town
Christmas Tree Lighting**
Nov. 8, Holiday parade
through Shipshewana

**Shipshewana's Lights
of Joy Drive-Thru**
Nov. 21-Dec. 31 Every
Sunday, Thursday, Friday
and Saturday

January 2026

**Shipshewana
Ice Festival**
Includes an ice carving
competition and chili
cook-off. Visitors can
purchase a collector's pin,
designed each year by
a Westview High School
student, which entitles the
holder to free admission
to the chili cook-off and
discounts throughout town
for the entire month of
January.



AMY OBERLIN

Hannah Bower, right, talks to judge Jamie Buckland during the premiere showman portion of the dairy beef and started calf shows at the LaGrange County 4-H fair.

- Books
- Audiobooks
- DVDs
- Magazines
- Newspapers
- Internet Access
- Genealogy
- Programs



LaGrange
203 W. Spring St.
LaGrange, IN 46761
260.463.2841

Topeka
133 N. Main St.
Topeka, IN 46571
260.593.3030

Shipshewana
250 Depot St.
Shipshewana, IN 46565
260.768.7444

Bookmobile
Please call
260.463.2841 x1040
for a current schedule.
www.lagrangelib.in.us

Parks & Recreation

County Parks

Dallas Lake Park 0505 W. C.R. 700S, Wolcottville Admission is \$5 per car. Park office hours: M-F 8 a.m.-3:30 p.m. 854-2225 *The park takes in 145 acres on the south shore of Dallas Lake. The beach is staffed by lifeguards in the summer. Enjoy a wetland observation deck for wildlife and bird watching. A lodge is available for group rental.* **Amenities:** playground, picnic, hiking, swimming, wetland, grassy area

David Rogers Memorial Park 2355 W. C.R. 550S, Wolcottville davidrogersdays.org *Most notable for its authentic pioneer log homes relocated to the park, it also features four cabins and a barn. It is the gravesite and memorial for pioneer philanthropist Dr. David Rogers. The David Rogers Days Pioneer Living History Festival takes place on the fourth weekend of August, celebrating the work and play of 1845.* **Amenities:** picnic, grassy area

Delt Church Park 6455 S. C.R. 200W, Wolcottville *Bordered by the Little Elkhart River, this park contains 119 acres with three oak timber picnic pavilions available for group reservations. On one side of a grass playing field is the MegaTower Playground, a disabled-accessible facility with zones divided for children 2-5 years and 5-12 years. Throughout the park is a disc golf course. There are wooded hiking trails and a restored prairie. Picnic tables and grills are provided.* **Amenities:** playground, picnic, hiking, wetlands,

grassy area, disc golf

Duff Nature Preserve Bloomfield Township, near Cedar Lake area of Howe *25 acres of wildlife and natural woodland*

Maple Wood Nature Center 4550 E. C.R. 100S, LaGrange **Hours:** W 8 a.m.-4 p.m., Sat. 9 a.m.-5 p.m., and Sun. 1-5 p.m. (closed Sundays in July). *Northern hardwood forest, wooded swamp and wet prairie can be enjoyed on miles of hiking trails. Excellent habitat for wildflowers, birds and trees. Maple syrup season is celebrated on the third weekend of March with Maple Syrup Days.* **Amenities:** picnic, hiking, wetlands

Pine Knob Park 2825 E. S.R. 120, Howe 3-D archery trail fees are \$5. *The park has more than 200 acres of oaks, pines, soft maples, high quality marsh and Meteer Lake. Special facilities are provided for hunters and fishermen. There are field archery targets and a wooded 3-D archery trail with life-sized game targets. Trails and a fishing dock are accessible. Picnic tables and grills are provided. A program center is available for rental.* **Amenities:** picnic, hiking, wetlands

Scott Mill Park 6780 N. C.R. 675W, LaGrange *The site of the former grist mill for the town of Scott. Through a covered bridge, visitors can access a 100-acre wooded island along the Pigeon River. A timber picnic pavilion is available for group reservations.* **Amenities:** picnic, hiking, wetlands, fishing

County Beaches

Atwood Lake Beach C.R. 700S on the north side of Atwood Lake **Public access location:** southwest shore off C.R. 745S **Public access facilities:** No restroom, no disabled access, gravel parking, hitching post and concrete ramp **Fishing info:** Redear sunfish, bluegill, largemouth bass.

Cedar Lake Beach East of Howe at C.R. 325E and C.R. 600N and across from Cedar Lake Golf Course **Amenities:** Beach

Shipshewana Lake Beach East side of Shipshewana Lake **Amenities:** Picnic tables, playground

Wall Lake Beach North of S.R. 120 at C.R. 600N, Howe *Wall Lake's swimming area is part of the LaGrange County public parks system. It is open from 8 a.m. to sunset.* **Public access:** Southeast shore, C.R. 565N. **Amenities:** Boat ramp, disabled access, restroom **Fishing info:** Crappie, bluegill, redear, largemouth bass, perch and Northern pike.

Access Sites

LaGrange County is home to more than 70 public freshwater lakes, as classified by the Indiana Department of Natural Resources.

Opportunities to access the lakes for recreational activities, including fishing, are made available through public access sites operated by the DNR and through private access.

These lakes have DNR public access sites in LaGrange County:

- Adams Lake
- Aldrich Lake
- Appleman Lake
- Atwood Lake
- Beaver Dam Lake
- Big Long Lake
- Big Turkey Lake
- Cass Lake
- Cedar Lake
- Emma Lake
- Fish Lake
- Little Turkey Lake
- Messick Lake
- Meteer Lake
- Mongo Mill Pond
- Nasby Dam
- Oliver Lake
- Ontario Mill Pond
- Pigeon River (several sites along river, including dams)
- Pretty Lake
- Shipshewana Lake (2 locations)
- Stone Lake
- Troxel Lake
- Wall Lake
- Westler Lake
- Witmer Lake

Town Parks

Howe

Town Square Park In the center of the town **Features:** Playgrounds, basketball court, shelter, picnic tables

LaGrange

LaGrange Town Park On Factory Street on the northwest side of LaGrange **Features:** Playground, basketball courts, baseball diamonds, skateboard park, restrooms, shelter, picnic area and tables

Mongo

Mongo Town Park C.R. 780E, one block south of S.R. 3 **Features:** Shelter, playground, picnic tables

Ontario

Ontario Town Park In the center of town **Features:** Playground, baseball diamond

Shipshewana

Wolfe Park Morton Street, next to Wolfe Community Building **Features:** playground, baseball diamonds, restrooms

Shipshewana Community Soccer Fields 790 E. Middlebury St. **Features:** Soccer fields

Topeka

East Park 509 E. Lake St. **Features:** Softball and baseball diamonds, basketball court, tennis courts, playground, pavillion, restrooms

West Park 330 W. Lake St. **Features:** Walking trail, playground, restrooms

Wolcottville

Taylor Park South side of town on S.R. 9 **Features:** Shelter, picnic tables, horseshoe pits, a ball diamond, restrooms, basketball court and playground

Wolcott Park S.R. 9 on the north edge of Wolcottville **Features:** Swing set

Martin Park West side of town off South Main Street **Features:** Combination soccer-football field, several baseball fields, playground

Recreation

Mongo

Pigeon River State Fish and Wildlife Area Provides a place for fishing, hunting, trapping and wildlife viewing. It is an 11,500-acre site that includes three reservoirs and land along the Pigeon River. There are archery ranges and shooting ranges.

Health & Human Services

American Red Cross
484-9336 *The American Red Cross prevents and alleviates human suffering in the face of emergencies by mobilizing the power of volunteers and the generosity of donors. Assistance is provided to all in need because of a disaster. Blood services are provided through voluntary donations to meet requirements for whole blood and its components wherever the need exists. The program functions through a network of fixed centers and mobile collection sites. It also provides educational programs related to health and safety and disaster assistance.*

The Arc of LaGrange County
235 W. C.R. 300N, Howe 463-2653 *arcopportunities.org The Arc is a nonprofit organization that serves all developmentally disabled clients residing in LaGrange County at no cost. It provides all transportation to and from the program. The clients served include homebounders and adults who range in age from teenagers through 70 years of age and older. It offers employment for those with disabilities such as sheltered workshops and community-based sheltered employment.*

Ark Animal Rescue and Adoption
530 E. C.R. 300S, LaGrange 463-4142 *LaGrange County's animal shelter*

Ark Paws and Claws
309 Defiance St., Howe 562-2100 M-F 9 a.m.-5 p.m., Sat 9 a.m.-1 p.m. *arkanimalrescue.weebly.com Ark Paws and Claws*

Used Bookstore raises money for the Ark Animal Sanctuary, the LaGrange County animal shelter. The bookstore has thousands of fiction and nonfiction books, puzzles, CDs, VHS tapes, audio books, etc. Ark also operates a book booth at the Shippshewana Flea Market.

Clothes and Food Basket of LaGrange County
413 S. Railroad St., LaGrange 463-7974 M & Th 9 a.m.-2 p.m. *Clothes and Food Basket of LaGrange County is a nonprofit organization that offers emergency assistance of food and clothing to eligible residents of LaGrange County. It is run entirely by volunteers and is operated and maintained by donations.*

Brightpoint Main Office:
423-3546 or (800) 589-3506 *Brightpoint is a private, nonprofit organization dedicated to removing the causes and conditions of poverty in northeast Indiana. Brightpoint uses state, federal, local and private resources to improve the quality of life for low-income citizens. Brightpoint offers assistance with child care costs, education, family development, food, housing and utilities at no cost to clients.*

Compassion Pregnancy Center
830 N. Detroit St., LaGrange Monday and Thursday 10 a.m. — 4 p.m. 463-7377 *cpcni.org Compassion Pregnancy Center provides free and confidential services to women of all ages in LaGrange and Steuben counties. It provides pregnancy tests with*

consultations, abstinence support, prenatal classes and courses, adoption referrals and community referrals and resources. For immediate assistance, call the national hotline at (800) 395-4357.

Elijah Haven Crisis Intervention Center Inc.
2575 SR 9, LaGrange 463-8700 *elijahhaven.org Elijah Haven is a nonprofit organization dedicated to providing services for all people who have been affected by domestic violence and to advocate violence-free living. It offers a 24-hour crisis line, emergency safe shelter, crisis counseling, emergency transportation and domestic violence education. Safe Haven's emergency crisis line in LaGrange County is (866) 463-3400.*

First Steps
700 E. Beardsley Ave., #14A, Elkhart (574) 293-2813 **Northeast Indiana Central Office:** (866) 725-2398 *indianafirststeps.org First Steps is a family-centered, coordinated system that serves children from birth to age 3 who have disabilities and/or who are developmentally vulnerable. It supports families by connecting them with a variety*

of services and professionals.
Fremont Community School Head Start LaGrange Center
495-4775 *A federally funded program for preschoolers ages 3 1/2 to 5, it serves LaGrange families through the Fremont Community Schools division. The program director is Susan Swager.*

LaGrange County Council on Aging
410 E. Central Ave., LaGrange 463-4161 *lagrangecoa.org The LaGrange County Council on Aging is a nonprofit organization that provides services and resources to improve the quality of life for the senior citizens of LaGrange County. The agency provides a number of services designed to assist in keeping individuals independent. It is the home of LaGrange County public transportation. For more information, contact Cheri Perkins, director.*

LaGrange County Department of Child Services
2400 N. Ventura Way, LaGrange 463-3451 **Office hours:** M-F 8 a.m. to 4:30 p.m. *It provides child welfare assistance*

to residents in LaGrange County through adoptions, child protective services, foster homes and day care licensing. For more information, contact Paul Watson, director.

LaGrange County Division of Family Resources
826 N. Detroit St., LaGrange (800) 403-0864 *The LaGrange County Division of Family Resources is a county office of the state social service agency that provides temporary public assistance to needy families through food stamps, HIP, Medicaid, TANF and Hoosier Healthwise insurance. Assistance with employment services also is available.*

LaGrange County Habitat for Humanity
205 E. Wayne St., LaGrange 463-8519 *lagrangehabitat.org The mission of LaGrange County Habitat for Humanity is "building houses in partnership with God's people in need." Three types of partnerships are offered for families in LaGrange County: building new homes, remodeling previously owned homes and maintenance for existing homes. Families*

Your time is valuable.

Get the care you deserve with our same day services and consults.



LAGRANGE

FAMILY DENTISTRY

Family 🦷 Cosmetic 🦷 Implants 🦷 Orthodontics

LaGrangeFamilyDentistry.com | 260.463.2111

Mention code #LCCG0324 to save
\$25 off your new patient cleaning and exam!



Health & Human Services

who wish to qualify must fulfill three requirements: show housing need, meet income guidelines and be willing to participate by providing "sweat-equity" hours with the organization.

LaGrange County Health Department

304 N. Townline Road, LaGrange 499-4182 M-Th 7 a.m.-5:30 p.m. The LaGrange County Health Department was formed to protect, promote, maintain and improve the health and quality of life for LaGrange County citizens and visitors through a responsive, well-managed and organized community effort. A board of directors oversees the activities of the department, based at LaGrange County Health Officer Dr. Michael Conway M.D., may be reached at (812)525-2670. The LaGrange County Health Department employees offer a wide range of public health services through partnerships with

the county, state and federal agencies. The department's programs and services include health surveillance, health protection programs, preventive services and public records. The office is staffed by Dr. Alfredo Garcia, Ph.D., administrator and septic inspector; Jarod Nisley, food inspector; Kelly Bills, office manager, vital records and registrar; Alicia Milliman, public health nurse; Sue Bickley, WIC coordinator.

Life Care Center of LaGrange

770 N. C.R. 75E, LaGrange 463-7445 Life Care Center of LaGrange provides a number of assisted living, skilled care services for its clients, the citizens of LaGrange County. The facility is on old S.R. 9, across from Lakeland High School. For more information visit lifecarecenteroflagrange.com.

The Waters of LaGrange Skilled Nursing Facility

787 N. Detroit St., LaGrange 463-2172 formerly Miller's Merry Manor provides 24-hour assisted living, skilled care for citizens of LaGrange County. It provides a number of inpatient and outpatient care options.

Northeastern Center

2155 IN-9, LaGrange 463-7144 necmh.org The Northeastern Center is a private, nonprofit mental health office that serves all residents of LaGrange County and other surrounding counties. Its mission is to promote good health by providing education, consultation and participatory planning for the betterment of the community. It offers a number of programs in counseling for both inpatients and outpatients by psychiatrists, social workers and mental health workers. Fees for services depend on the type and length of services and the academic degree of

the person providing the services.

Parkview LaGrange County Emergency Medical Services

207 N. Townline Road, LaGrange 463-9000 EMS services in LaGrange County are provided through a partnership between Parkview LaGrange Hospital and LaGrange County. With ambulance stations in the city of LaGrange and in Shipshewana, LaGrange County residents have quick access to emergency medical services 24 hours a day, seven days a week. Call 911 for emergency medical assistance. Community Health Improvement Parkview LaGrange also offers a robust program of free and low-cost community health and wellness programs throughout the year. Programs include financial assistance, Community Health Improvement initiatives, primary health care and access, health

screening and prevention, and disease management.

Tobacco-Free Northeast Indiana

800-QUIT-NOW The mission of Tobacco-Free Northeast Indiana is to reduce tobacco use in LaGrange and Steuben counties through education, prevention and cessation. The organization also works in conjunction with the Indiana Tobacco Quitline, a free phone-based counseling service that helps Indiana smokers quit. For more information, contact Debbie Pontecorvo, regional program coordinator, at tobaccofreelgrstb@outlook.com.

Women, Infants and Children (WIC)

304 N. Townline Road, Suite 1, LaGrange 499-4182 Women, Infants and Children (WIC) is a supplementary food and education program directed to improve the health and nutrition of women and children.



PHOTO CONTRIBUTED

Beautiful Baby Pageant at LaGrange County Corn School had a sweet turnout in 2024. Baby Miss was Willow Summers, Baby Mister Messiah Millard, Wee Miss Vanessa Garcia, Wee Mister Christopher Garcia, Tiny Tot Miss Sofi Montoya and Tiny Tot Mister Lucas Santana.

Community Groups

- American Legion Post 215**
100 Industrial Parkway,
LaGrange, 463-4172

American Legion Auxiliary Post 215
463-4172

Sons of the American Legion Post 215
463-4172

American Legion Riders
463-4172

Bar Association of LaGrange County
499-6326, Travis Glick, president

Big Brothers Big Sisters of Northeast Indiana
Fort Wayne office: 456-1600

Crossroads United Way
Denise Landers, area director, 574-295-1650 give@crossroadsuw.org
- Daughters of the American Revolution**
463-3232

Friends of the LaGrange County Library
lagrange.fol@lagrange.lib.in.us

LaGrange County Arts
Mary Woodworth, president, 350-4598

LaGrange County Chamber of Commerce
513 W. Central Ave., LaGrange, 463-2443

LaGrange County Historical Society
Bryan McCoy, president 463-3763, cell 350-8561

LaGrange County Lakes Council
lagrangelakes.org

Main Street LaGrange
Jenny Landez, president, mainstreetlagrange.org
- Northeast Indiana Steam and Gas Association**
neisaga.com

Retired Senior Volunteer Program (RSVP)
925-0917

Topeka Area Historical Society
Harold Gingerich, president, 499-0126; topekahistoricalsociety.com

Lions Clubs

Howe
Jeff Schrader, president, 562-3367

South Milford
R. D. Wolheter, contact person, 351-3581

Stroh
Steve Hamilton, contact person, 351-4232

Wolcottville
Robert Lewis, contact person, 215-1356
- LaGrange County Purdue Cooperative Extension Service**
Suite 10, 114 W. Michigan St., LaGrange, 499-6334

LaGrange County Extension Homemakers County Officers
President Lori Carney, vice president Brenda Jennings, treasurer Lisa Hochstetler, secretary Ira Johnson

Local Extension Clubs

Greenfield Mills
Brenda Jennings, president

Newbury
Betty Gibbs, president

Plato
Lisa Hochstetler, president

Purdue Extension Master Gardener
Rebecca Gump, president

Shipshewana Area Historical Society
760 S. Van Buren St., Shipshewana



A magical carriage is pulled by a horse in the Shipshewana Light Parade.

CONTRIBUTED



Members of the Rome City-Brimfield Lions Club attach a parade banner to a pontoon boat on a trailer in preparation for the Chautauqua Days parade in Rome City. The Lions club rides on the pontoon through the parade route, with the trailer pulled by a pickup truck.

CONTRIBUTED

Churches

Apostolic

ALBION APOSTOLIC CHURCH:

1008 E. South St., Albion. Pastor Bradley K. Geans. Sunday School, 9:30 a.m. Sunday Praise and Worship, 6:30 p.m. Thursday Bible Study, 7:30 p.m.

APOSTOLIC FAITH CHURCH OF GOD:

317 Pigeon St., Ligonier; 894-4711. Rev. Joseph Lee Brickey. Wednesday Bible Study, 7 p.m. Saturday Worship, 7 p.m. Sunday School, 10 a.m. Sunday Worship, 6:30 p.m.

APOSTOLIC LIGHTHOUSE TABER NACLE:

950 W. U.S. 20, LaGrange. 463-3720. Pastor Robert W. Yenna. Sunday, 10 a.m. and 6 p.m. Wednesday Bible Study, 7 p.m.

BREAD OF LIFE TABERNACLE:

321 E. Mitchell St., Kendallville; 582-1166. Rev. Shawn Kondas. Sunday Worship and Sunday School, 10 a.m. Evangelistic Service, 6 p.m. Wednesday Bible Study, 7:30 p.m.

Assembly of God

ARK OF AVILLA ASSEMBLY OF GOD:

125 Baum St., Avilla, IN 46710; 260-897-3627. Pastor Doug Harris. arkavilla@live.com. Sunday Service, 10 a.m. Sunday Evening Service, 6 p.m. Wednesday Evening Service, 6 p.m.

ASSEMBLY OF GOD (FULL GOSPEL):

815 N. Riley Road, Kendallville; 347-2096. Pastor Bob Monroe, 413-1053. Sunday School, 9:30 a.m. Worship, 10:30 a.m. Wednesday, 7 p.m.

CENTRO DE FE: 815 N. Riley Road, Kendallville. 347-2096. Pastor Peter Tamayo, 894-7768. Sunday Worship, 1:30 p.m.

TRINITY ASSEMBLY OF GOD:

1288 W. Union, Ligonier. Sunday School, 9:15 a.m. Worship, 10:30 a.m. Wednesday Champions for Christ Kids, 6:15 p.m. Youth Game room opens at 5:30 p.m.

Baptist

BEACON BAPTIST: Drake Road, Kendallville. Rev. Ronald Stratman. Sunday School, 9:30 a.m. Worship, 10:30 a.m. and 6 p.m. Wednesday, 7 p.m.

BEREAN BAPTIST: 110 Highland Park Drive, Albion. G.A.R.B.C. Pastor Douglas L. Keenan. Sunday School, 9:30 a.m. Worship, 10:30 a.m.

Fellowship, 7 p.m. Wednesday Family Night Ministries, 7 p.m.

BETHEL CHRISTIAN BAPTIST:

Five miles west of Kendallville on U.S. 6. Pastor Shawn Shepherd. Sunday School, 10 a.m. Worship, 11 a.m. Wednesday prayer, 7 p.m.

BIBLE BAPTIST OF LIGONIER:

204 W. Sixth St., Ligonier; 894-4988. Harold E. Heaton, 856-4908. Sunday School, 9:30 a.m. Worship, 10:30 a.m. and 6 p.m. Wednesday, 6:30 p.m.

BURR OAK BAPTIST:

Sunday School, 9:15 a.m. Worship, 10:30 a.m. Junior/Senior High Youth, Sunday 5:15 p.m.

CHARITY UNITED BAPTIST:

At the corner of C.R. 100S and C.R. 900E, LaGrange. Pastor Ben Brown. Sunday Worship, 11 a.m. Sunday School, 10:15 a.m.

COMMUNITY BAPTIST:

Northwest of South Milford on C.R. 700S. Sunday School, 9:45 a.m. Worship, 11 a.m.; Wednesday Prayer, 7 p.m.

CORNERSTONE FELLOWSHIP:

Corner of Mitchell and Oak Streets, Kendallville; 347-0615. Pastor Percy Young. Worship Service, 10:30 a.m. JAM Session, 10:30 a.m. Wednesday Prayer Meeting/Bible Study, 6:15 p.m.

CROSSROADS BAPTIST CHURCH:

8975 W. 250 N., (1 mile west of Blue Gate Restaurant), P.O. Box 326, Shipshewana; 260-768-4245. www.crossroadsbaptistindiana.com. Pastor Mark W. Suever. Sunday school, 10 a.m. Morning service, 11 a.m. Sunday evening service, 6 p.m. Wednesday evening, 7 p.m.

FIRST BAPTIST:

104 North St., Topeka. Rev. Mark Campbell, 593-2111 or 350-2740. Sunday School, 9 a.m. Sunday Worship, 10 a.m. Prayer, 6:30 p.m. Monday Bible Study, 6:30 p.m. Thursday.

FIRST FREEDOM BAPTIST CHURCH:

3263 S.R. 327 south of Corunna. Pastor Ron Bell. Sunday Worship, 11 a.m. Wednesday Worship, 6 p.m.

FIVE CORNER BAPTIST:

Two miles north of Wolcottville on S.R. 9. Pastor Jim Snyder. Sunday School, 10 a.m. Worship, 11 a.m. Wednesday Prayer, 6 p.m. Third Saturday Worship, Singing 6 p.m.

HARBOR OF LOVE BAPTIST:

2353 S. Lima Road, drive in front of

Kendallville Iron and Metal. Pastor Charlie Mosley. Sunday School, 10 a.m. Service, 11 a.m. Wednesday, 7 p.m.

HELMER INDEPENDENT BAPTIST:

C.R. 766S, Helmer. Pastor Rick Davis. Sunday School, 10 a.m. Worship, 11 a.m. Thursday Worship, 6 p.m.

HILLTOP BAPTIST CHURCH:

P.O. Box 24, 2722 E. C.R. 900N, Rome City. Pastor Johnny Huff. Wednesday Service, 6 p.m. Sunday Service, 11 a.m.

LAGRANGE BAPTIST:

1370 N. S.R. 9. 463-2348. Pastor Thurston Jones. Sunday School, 9:30 a.m. Services, 10:30 a.m. and 6 p.m. Wednesday, 6 p.m.

LIBERTY FREEWILL BAPTIST:

2900 E C.R. 1150N, Wolcottville. 260-582-9115. Pastor Billy Fields. Sunday School, 9:45 a.m. Worship, 11 a.m. Wednesday Prayer, 6 p.m.

LIGHTHOUSE BAPTIST FELLOWSHIP:

East Spring Street, LaGrange. Sunday Worship, 10:45 a.m. Sunday School, 9:30 a.m.

MOUNT CALVARY UNITED BAPTIST:

Main Street, Stroh. Pastor Willie Collins, 260-367-1293. Sunday worship, 10 a.m.

NEW FREEDOM BAPTIST: 300 N. Sycamore St., LaGrange. Rev. Wade Sturdivant.

NEW HOPE BAPTIST:

2900 N.C.R. 500E, Kendallville. Pastor Robert Boston. Sunday School, 9:30 a.m. Worship, 10:30 a.m., 6 p.m. Wednesday, 6:30 p.m.

NEW LIFE BAPTIST:

124 W. Hobart St., Ashley. Sunday School, 10 a.m. Worship, 11 a.m. 3rd Saturday, 6 p.m.

OPEN DOOR COMMUNITY CHURCH:

(American Baptist Church) 116 N. Main St., Wolcottville. Pastor Brandon Grimme. 854-3136. Sunday School, 9:30 a.m. Sunday Worship, 10:30 a.m. Tuesday Lunch Bunch, 11 a.m. Wednesday: Kids Club, ages 6-12, 5:30 p.m.; free community dinner, 6 p.m.; evening worship and study, 6:30 p.m.

ORMAS BAPTIST:

8962 N. 300 W., Columbia City, on Noble/Whitley line. (260) 799-5789. Pastor Neil Booth. Sunday School 9:30 a.m. Worship 10:30 a.m.

SALEM UNITED BAPTIST: S.R. 9, one mile north of U.S. 6, Kendall-

ville. Rev. Billy Tuttle and Rev. Glen Jackson. Sunday Service, 11 a.m.

SHILOH BAPTIST:

709 N. Johnson St., Ligonier; 894-3180. Rev. Jimmy Shepherd, 260-221-0003. Sunday Worship, 11 a.m. and 6 p.m. Wednesday service, 6 p.m. Gospel Jam: fourth Friday, 5 p.m. to 8 p.m.

SOUTH MILFORD INDEPENDENT BAPTIST:

Pastor Earl Bolen. Sunday School, 10 a.m. Worship, 11 a.m. Second Saturday, 6 p.m.

STROH UNITED BAPTIST:

Pastor Oley Smith. 260-562-3264. Sunday Service, 11 a.m. First Saturday, 6 p.m.

VICTORY BAPTIST FELLOWSHIP SBC:

886 N. Lima Road, Kendallville; 260- 564-5638. Pastor Dean Winebrenner. Sunday School, 9:30 a.m. Worship, 10:45 a.m. Bible Study Thursday, 6 p.m. victorybaptist-fellowship.com

WOLF LAKE BAPTIST:

Pastor Dan Carlson. Sunday School, 9:30 a.m. Children's Church, 10:30 a.m. Worship, 10:30 a.m. Thursday, 7 p.m.

ZION UNITED BAPTIST:

Valentine. Sunday School, 10 a.m. Worship, 11 a.m.

Bible Church

WESTON STREET BIBLE:

340 Weston St., Rome City. Pastor Dan Lash. Sunday School, 9:30 a.m. Worship, 10:30 a.m. "Think on These Things" Saturdays at 10:14 a.m. on WFCV 1090-AM.

Brethren

BRIGHTON CHAPEL:

5445 N. S.R. 3, Howe. Pastor Rustin Krapfl; 562-2505. Worship, 9 a.m. Second Service, 10:30 a.m. Sunday School, 9:30 a.m.

CEDAR LAKE CHURCH OF THE BRETHREN:

2939 C.R. 15 at C.R. 28, one mile south and 1 1/2 miles east of Corunna; 281-2021. Staci Peterson, pastor. Sunday Worship, 10:30 a.m. Website: cedarlakecob.org.

CORUNNA UNITED BRETHREN IN CHRIST:

Rev. Jason Hollopeter. Sunday School, 9 a.m. Worship, 10 a.m. Wednesday Pioneer Club for kids, 6 p.m.

WAWAKA CHURCH OF THE BRETHREN:

C.R. 700N off U.S. 6, Wawaka. Sunday School, 9:30 a.m. Worship, 10:30 a.m.

Churches

Catholic

BLESSED SACRAMENT: Albion. Father J. Steele, CSC. Masses: Saturday, 4 p.m. Sunday, 8 a.m.; Wednesday at 8:30 a.m.; and Thursday, 6 p.m.

IMMACULATE CONCEPTION: 319 E. Diamond St., Kendallville. Father John Steele. Masses: Saturday, 6 p.m. Sunday, 10 a.m. in English. Sunday 1 p.m. in Spanish; Tuesday, Thursday and Friday, 8:30 a.m.

ST. GASPAR: S.R. 9 North, Rome City. Father Louis Fowoyo, FM. Masses: Tuesday-Friday, 8 a.m. Saturday, 4:30 p.m.; Sunday Mass, 7:30 a.m. and 10 a.m. Confessions: 30 minutes before each Mass or Saturday from 9-10 a.m.

ST. JOSEPH’S: 50 N. 100E LaGrange. 463-3472. Father Osman Ramos, FM. Vicar Priest Raul Narroquim. Masses: Tuesday-Thursday, 9:30 a.m. Thursday, 6:30 p.m. in Spanish. Saturday, 5 p.m. in English, 7:30 p.m. in Spanish; Sunday Mass in English, 10 a.m.; Mass in Spanish, 12:30 p.m. Confessions: 30 minutes before daily Mass. Rosary: 30 minutes before Masses. Eucharistic Adoration after Thursday Mass, 30 minutes.

ST. MARY OF THE ASSUMPTION: 228 N. Main St., Avilla. Father Dave Voors. Sunday, 8 and 11 a.m. Monday-Saturday weekday at 9 a.m. Saturday evening, 5 p.m. Confessions, 4-4:45 p.m. Saturday and by appointment.

ST. MARY OF THE ANGELS: Big Long Lake. Saturday, 4 p.m. Sunday, 9 a.m.

ST. PATRICK’S: Ligonier. Father Wilson Corzo. Saturday Masses: Spanish, 5 p.m., English, 6:30 p.m. Sunday Masses: English, 10:30 a.m., Spanish, 12:30 p.m. and 2 p.m. Confessions after both Masses. Masses Wednesday, 5 p.m. and Friday, 8 a.m.

Christian Church

BROADWAY CHRISTIAN CHAPEL: Biblically-based traditional worship. 208 N. C.R. 900W, Kimmell. Rev. Samuel E. Erwin. Sunday School, 9:30 a.m. Worship, 10:30 a.m. Wednesday Service, 7:30 p.m.

CASIO DE ORACION: 130 Lake Terrace Drive, Kendallville. Pastor Salavador Espinoza, 260-229-7594. Sunday worship, 11 a.m.; Wednesday

service, 6 p.m.

ONE TRUTH CHRISTIAN OUTREACH: 309 Sargent St., Kendallville. Pastors Barbara and Tommy Keene. Sunday School, 10 a.m. Worship Service, 11 a.m. Wednesday Service, 6:30 p.m.

Church of Christ

CHURCH OF CHRIST: 307 E. North St. (U.S. 6), Kendallville; 347-1361. Sunday Bible Teaching, 9:30 a.m. Worship, 10:30 a.m. with Lord’s Table. Sunday Worship, 5 p.m. with Lord’s Table available. Wednesday Bible Study, 5 p.m.

CORUNNA CHURCH OF CHRIST: Pastor Brian Wilcox. Sunday School, 9 a.m. Worship, 10 a.m. and 7 p.m. Youth Hour, 7 p.m.

LIGONIER CHRISTIAN CHURCH: 9025 N. C.R. 860W, Ligonier. Minister Chris Coney. Sunday Bible School, 9:30 a.m. Worship, 10:30 a.m. and 6 p.m. Wednesday Night Service and Youth Service, 6:30 p.m.

MILLERSBURG CHURCH OF CHRIST: 11851 C.R. 44, Millersburg; 574-202-1100 or 574-238-0173. Sunday Bible study, 9 a.m.; Sunday worship, 10 a.m.; Wednesday Bible study, 7 p.m.

SOUTH MILFORD CHURCH OF CHRIST: 8030 E. C.R. 600S (1 1/2 miles north of South Milford on S.R. 3); 351-3671. Senior Minister Brian Walter. Sunday Worship, 9 a.m. and 10:30 a.m. Sunday School during services.

STROH CHURCH OF CHRIST: 4540 S. C.R. 1100W, Hudson, on the southeast edge of Stroh; 260-351-4626. Senior Minister Mike Hamm. Associate Minister Mark Hamm and youth minister Andy Hayward. Website: www.strohcofc.com. Sunday Worship, 9 a.m. Sunday School, 10:20 a.m.

Church of God

FIRST CHURCH OF GOD: 111 S. Oak St., Kendallville; 347-0469. Senior Pastor Regan Ford. Sunday worship, 10 a.m. Services broadcast live on Facebook.

LAGRANGE FIRST CHURCH OF GOD: S.R. 9 North; 463-3700. Sunday Worship, 9 a.m. and 10:30 a.m. Online service 9 a.m. at lagrangechog.org. Wednesday: Women’s Bible Study, 9 a.m.; Celebrate Recovery, doors open

6 p.m.; Youth Group, 6 p.m. to 8 p.m. with meal provided; men’s Bible study, 6 p.m. Second Thursday: Women at the well, 6 p.m. Friday: Common Ground Cafe, 7 p.m.

STONE LAKE CHURCH OF GOD: Shipshewana. Sunday Worship, 10:30 a.m. and 6 p.m. Sunday School, 9:30 a.m. Wednesday, 7 p.m.

STROH CHURCH OF GOD: Pastor Joe Clark. Adult Sunday School, 9 a.m. Morning Worship, 10 a.m. Bible Study and Prayer, Wednesday 7 p.m.

SUGAR GROVE CHURCH OF GOD: 5019 E. C.R. 500S., Churubusco, at 57 at C.R. 500E, Noble County; 693-1718. Pastor Tim Grable; associate pastor Tim Miles; youth pastor, Michael Baumert; and Lory Norden, general ministries. Sunday: masked worship service, 8:15 a.m.; worship and children’s church, 10:30 a.m. Sunday Kids and Youth, 6 p.m. Wednesday: Bible studies for men, women and youth. Thursday: Celebrate Recovery and Grief Share.

TRUE CHURCH OF GOD IN JESUS NAME: Lisbon; 347-5045. Worship Saturday, 6 p.m. Sunday, 10:30 a.m.

WOLCOTTVILLE CHURCH OF GOD: 210 S. Main St. Box 336, Wolcottville. Rev. Daniel Begley, 854-3636. Sunday School and Worship, 10 a.m. Evening, 6 p.m. Wednesday Prayer and Youth Service, 7 p.m.

Congregational

ONTARIO CONGREGATIONAL: Sunday Worship, 11 a.m. Sunday School, 10 a.m.

Episcopal

ST. MARK’S EPISCOPAL PARISH, ST. JAMES CHAPEL: Howe Military Academy. Rev. Beverly Collinsworth. Sunday Worship, 9 a.m.

Evangelical

BRIDGEWAY EVANGELICAL: 210 Brian’s Place. 599-0339. Pastor Josh Huggett. www.bridgewayweb.com. Sunday School Worship, 9 a.m. and worship service at 10 a.m. Bible Study, 9:15 a.m.

LIGONIER EVANGELICAL: 1911 Lincolnway South. Rev. Troy Diersing. Sunday School, 9 a.m. Worship, 10:15 a.m. Small Groups: Wednesday Youth, 6 p.m. Bible Study, 7 p.m.

Full Gospel

THE GOSPEL LIGHTHOUSE: 112 Veterans Way, Kendallville; 260-582-9451 or 260-582-9450. Pastor Carter Hicks and Apostle Zaundra Hicks. Sunday: Bible study, 10 a.m. Worship, 11 a.m.

Jehovah’s Witness

JEHOVAH’S WITNESS: Kingdom Hall, 106 Miller Road, Kendallville. Sunday Bible Lecture, 10 a.m., followed by Watchtower Study. Thursday Midweek Meeting, 7 p.m.

Lutheran

CALVARY EVANGELICAL LUTHERAN: 111 W. Orange St., Cromwell; 856-2610. Tom Monroe, FAM Worship: 9:30 a.m., Sunday School, 9:45 a.m. Food for All People carryout meal, 3rd Wednesday at 5 p.m.

EMMANUEL LUTHERAN: LaOtto (Evangelical Lutheran Church in America). Interim Pastor Jeremy Russel. Service, 10 a.m. Children’s Sunday School, 10 a.m.

IMMANUEL LUTHERAN: (Missouri Synod) 113 W. Albion St., Avilla. Pastor Patrick Kuhlman. Sunday School, 8:30 a.m.; Worship, 9:30 a.m.

LIVING WATER LUTHERAN CHURCH: (Missouri Synod) 1197 S. U.S. 33, Wolf Lake; 260-635-2336. Sunday Worship, 9:15 a.m. Bible Class (all ages), 10:15 a.m. Wednesday Night Services, 7 p.m. Weekly food pantry every Thursday, 3-4 p.m.

MESSIAH LUTHERAN: (Missouri Synod) S.R. 9 at C.R. 700S, north of Wolcottville; 854-3129. Pastor Anthony Appel. Sunday Worship, 9:30 a.m. Sunday School and Adult Bible School following worship. Holy Communion 2nd and 4th Sundays.

MT. PLEASANT EVANGELICAL LUTHERAN: (Evangelical Lutheran Church in America). 2520 C.R. 600E, 1/4 mile south of S.R. 8. 636-2777. Sunday Worship, 9 a.m. Sunday School, 10:15 a.m.

MT. ZION LUTHERAN (ELCA): 797 N. Detroit St., LaGrange; 463-3624. Pastor Dana Stonebraker. Sunday Worship 9 a.m.

PRINCE OF PEACE LUTHERAN: (LCMS) C.R. 550S at C.R. 1025E, southwest of Stroh. 351-2144. Sunday Worship, 9 a.m. with

Churches

children's classes. Bible Study, 10:30 a.m. Holy Communion 2nd and 4th Sundays. Wednesday Worship, 7 p.m.

ST. JOHN LUTHERAN: (Missouri Synod) 301 S. Oak St. (corner of Oak and Rush), Kendallville. Pastor Philip Rigdon. Sunday Worship, 8 a.m. (traditional), 10:30 a.m. (contemporary). Thursday Worship, 7 p.m. (traditional). Communion on first, third and fifth Sundays and the preceding Thursday. Sunday School, 9:15 a.m.

ST. MARK'S EVANGELICAL LUTHERAN (EVANGELICAL LUTHERAN CHURCH IN AMERICA): 210 N. Orange St. Albion. 636-2777. Sunday School 9:30 a.m. Worship 10:30 a.m.

Mennonite

LAKE BETHEL MENNONITE: 10500 E. C.R. 275S, LaGrange. Sunday School, 9:30 a.m. Worship, 10:30 a.m. Wednesday prayer meeting, 7 p.m.

Missionary

LIFEGATE CHURCH: 2555 N. C.R. 900W, Shipshewana. Rev. Rick Schultz, 768-4296. Sunday Contemporary Worship, 10:45 a.m. Life Group, 9:30 a.m.. Free meals 2nd and 4th Wednesday, 6:30-8 p.m. Food Pantry and Clothes Closet open 2nd and 4th Wednesday, 5-6:30 p.m.

LAGRANGE MISSIONARY: 808 N. Detroit St., LaGrange; 463-3528. Rev. Johnny Raber. Sunday Worship, 10 a.m. Handicap accessible.

REHOBOTH MISSIONARY: C.R. 125N, 1 3/4 miles south of Skinner Lake and 1/4 mile west of C.R. 300E. Rev. Joseph Snider. Sunday School, 9:45 a.m. Worship, 10:45 a.m.

Mormon

CHURCH OF JESUS CHRIST OF LATTER-DAY SAINTS: 1901 Dowling St., Kendallville. Sunday: Sacrament meeting, 9 a.m. Sunday School, 10:10 a.m. Priesthood and Relief Society meetings, 11 a.m.

Nazarene

CROSSPOINTE FAMILY CHURCH: 205 HighPointe Crossing, Kendallville, 1/4 mile west of S.R. 3 off of Drake Road; 260-599-0895. Pastor Rich Secor, 260-343-1558. CPFC46755@gmail.com. Office hours M-F, 9 -11 a.m. Sunday Bible Class (all ages), 9:10 a.m. Worship,

8 a.m. and 10:30 a.m. Nursery available for all services. Celebrate Recovery every Monday at 6:30 p.m., Rev. Norm Getts, 260-343-8515.

FORKS CHURCH OF NAZARENE: 11435 W. C.R. 25S, Middlebury. Pastor Eldon Stoltzfus, 574-825-9333. Sunday School, 9 a.m. Worship, 10 a.m.

LIGONIER CHURCH OF THE NAZARENE: College and Martin streets, Ligonier. Rev. John V. Lutton. Sunday School, 9:30 a.m. Worship, 10:30 a.m. and 6 p.m. Wednesday Bible Study, 7 p.m.

NEW VISION CHURCH OF THE NAZARENE: 522 S. Poplar St., LaGrange. Pastor Toni James. Sunday Worship, 4 p.m.

SHIPSHEWANA CHURCH OF THE NAZARENE: 2695 N. C.R. 900W; 768-4455 or 768-4291. Sunday School and Life Group, Sunday, 9 a.m. Worship, 10:30 a.m. Children Church, 10:30 a.m. Wednesday, 6:30 p.m.

Pentecostal

FREEDOM TO WORSHIP CHURCH OF GOD: C.R. 48, west of Altona; 281-2442. Pastor Joe Freeman. Sunday Service, 6 p.m. Wednesday, 6:30 p.m. Third Saturday Sing-in, 6:30 p.m.

NEW LIFE TABERNACLE: 609 N. Patty Lane, Kendallville; 347-8488. Senior pastor Rev. Austin Gilliland. Sunday School, 10 a.m. Worship, 11:30 a.m. Wednesday Bible Study, 7 p.m. Find online nlt.church.

Presbyterian

FIRST PRESBYTERIAN: 201 S. State St., Kendallville; 260-318-1202. Worship Sunday at 10 a.m. year-round.

FIRST PRESBYTERIAN OF ALBION: 210 W. Highland, Albion. Commissioned Ruling Elder (CRE), Beverly Harkey. Sunday Worship, 11a.m.

FIRST PRESBYTERIAN: 200 W. Michigan St., LaGrange; 463-3239 or 260-710-2434. Rev. Kenneth L. Weaver. Worship Service, 10 a.m.

HOPEWELL UNITED PRESBYTERIAN: 7355 E. Hopewell Road, Avilla. Sunday Service and Children's Sunday School, 9:30 a.m. Fellowship, 10:30 a.m.

LIGONIER PRESBYTERIAN: 407 S.

Cavin St. Ligonier; 894-3800. Pastor Kathy Kathary-Newton. Sunday Worship, 9 a.m.

LIMA PRESBYTERIAN: 608 4th St., Howe; 562-2296. Dave Hughes, pastor. Sunday school, 8:45 a.m. Worship, 10 a.m.

Seventh Day Adventist

WOLCOTTVILLE SEVENTH DAY ADVENTIST: 320 S. Main St. (S.R. 9), Wolcottville. Pastor Jesse Santos; 574-534-1834. Local Elder Ken Marsh, 854-3675. Saturday Bible Study, 9:30 a.m. Worship, 11 a.m. Wednesday Bible Study, 6:30 p.m.

WOLF LAKE SEVENTH DAY ADVENTIST: 3727 W. Wolf Lake St. Pastor Skip Hartmann, 574-534-1834. Local Elder Floyd Boland, 244-5318. Saturday Worship, 9:30 a.m. Bible Study, 11 a.m.

Society of Friends

QUAKER HAVEN FRIENDS MEETING HOUSE: 111 EMS D 16C Lane., Syracuse; 574-834-4193; www.quakerhaven.com. Sunday, 10 a.m.

United Methodist

ASBURY UNITED METHODIST: 605 E. Main, Albion; 636-7393. Pastor Bret Frymier. Sunday School, 8 a.m. Sunday Worship, 9 a.m. Wednesday Prayer Meeting, 6 p.m. Bible Study Wednesday, 6:30 p.m.

BRIMFIELD UNITED METHODIST: 1027 E. Summit St., Brimfield; 761-2501. Pastor Matt Bock. Sunday School, 9 a.m. Worship, 10:30 a.m.

CALVARY UNITED METHODIST: 101 S. Cherry St., Avilla; 897-3190. Rev. Chris Nelson. Sunday Worship, 9 a.m. Bible study after service.

CROMWELL UNITED METHODIST: Orange and Water streets. Rachel Case0Bales, pastor; 260-894-0649. Sunday Worship, 9 a.m.

EAST SPRINGFIELD UNITED METHODIST: U.S. 20 East, LaGrange; 367-2625. Rev. James D. Bartlett. Sunday School, 9:30 a.m. Worship, 10 a.m.

FAITH UNITED METHODIST: 411 E. Harding St., P.O. Box 783, Kendallville; 347-2616. Supply Pastor Kimberly Kennedy. Worship, 10:30 a.m.

HOWE UNITED METHODIST: 511 Third St., Howe; 562-2250. Sunday

Worship, 8:45 a.m. Sunday School, 9 a.m. Contemporary Service, 11 a.m.

INDIAN VILLAGE UNITED METHODIST: 2 1/2 miles south of Cromwell on S.R. 5; 856-5553. Pastor Rachel Bales-Case. Sunday School, 9:30 a.m. Sunday Worship, 10:30 a.m.

KIMMELL UNITED METHODIST: 2861 N. Hitler St., Kimmell; 260-760-0608. Pastor Stuart Mutzfeld. Sunday Worship, 9 a.m. Sunday School, 10:15 a.m. Bible Zone Kids Club Wednesday 5:45 p.m.

LAGRANGE FIRST UNITED METHODIST: 209 W. Spring St., LaGrange. 463-2859. Pastor Crystal Jacobson. Sunday Traditional Service, 8:30 a.m. Fellowship time, 9:30 a.m. Sunday School, 9:45 a.m. The Together Service, 10:45 a.m., fellowship hall.

LIGONIER UNITED METHODIST: 466 S. Townline Road, Ligonier; 894-3765. Pastor Jean S. Ness, Youth Leader Cody Cripe, Secretary Debbie Laird. Office Hours, 9 a.m.-3 p.m. Mon.-Fri. Traditional Worship at The Mount, 9 a.m. Sunday School at The Mount, 8 a.m. Contemporary Worship at the Crosswalk, 10:30 a.m. Bible Study and Youth Groups, Wednesday 6 p.m.

LIMA UNITED METHODIST: 6900 N. C.R. 450W, Shipshewana; 562-3719. Pastor Kevin Brower. Sunday School, adults and children, 9 a.m. Sunday Worship, 10 a.m.

MONGO UNITED METHODIST: S.R. 3, Mongo. Rev. James D. Bartlett. Sunday School, 9:50 a.m. Worship, 9 a.m. Contemporary Service, 11:30 a.m.

PRETTY PRAIRIE UNITED METHODIST: C.R. 750N, Howe; 562-2250. Worship, 10 a.m. Sunday School, 9 a.m.

RICHVILLE UNITED METHODIST: Sunday School, 9 a.m. Worship, 10 a.m. Pastor Gary Ford.

ROME CITY UNITED METHODIST: 297 Washington St., Rome City; 260-341-0233. Pastor Matt Bock. Sunday School. 8 a.m. Worship. 9 a.m.

SCOTT UNITED METHODIST: 7020 N. C.R. 675W, Shipshewana; 768-7257. Pastor Josh Watts. Sunday Worship, 10 a.m. Sunday

Churches

School, 11 a.m. Prayer Meeting, 6:30 p.m. First Thursday each month. Bible Study, 5:30 p.m. Thursday. JUMP, 5:30-7 p.m. Wednesday. HOPE, 7-8 p.m. Wednesday. Food pantry, 4 p.m. to 5:30 p.m. every Wednesday.

SHIPSHEWANA UNITED METHODIST: Shipshewana. Pastor Jeffrey Starkey. Sunday School, 9 a.m. Worship, 10:30 a.m. Wednesday Bible Study, 10:45 a.m.

TOPEKA UNITED METHODIST CHURCH: 124 W. Pine St., Topeka; 593-2941. Pastor Jeffrey Starkey. Worship, 9 a.m.

TRINITY CHURCH UNITED METHODIST: State and Rush streets, Kendallville; 260-347-0056. Rev. Drew Baker. Traditional service, 9 a.m. Sunday School, 10 a.m. Modern contemporary service, 11 a.m.

TRINITY UNITED METHODIST: Albion. Pastor Bret Frymier. Sunday School, 9:30 a.m. Worship, 10:30 a.m. Family Night Bible Study/ Fellowship 6 p.m.

WAYNE CENTER UNITED METHODIST: 1015 E. Schoolhouse Road, Kendallville; 260-573-8752. Pastor Ken Walker. Sunday School, 9 a.m. Sunday Worship, 10 a.m.

WOLF LAKE UNITED METHODIST: U.S. 33, Wolf Lake; 248-1549. Pastor Deanna Strombeck. Sunday Worship, 9 a.m. Sunday School for children, 9 a.m. Thursday Bible Study, 6 p.m. Pastor available at the church from 5-7 p.m. on Thursday.

WOODRUFF GROVE UNITED METHODIST: 4860 S. C.R. 450E; 854-2067. Pastor Chris Wild. Sunday School, 9:30 a.m. Sunday Worship, 10:30 a.m.

Wesleyan

ALBION WESLEYAN: 800 E. Main St., Albion. Pastor: Rev. Samuel Maddox Jr. Sunday Worship, 10 a.m.

CORNERSTONE WESLEYAN: Northwest of S.R. 9 and U.S. 33, Merriam. Pastor Dale Munsell. Sunday Worship, 10:35 a.m. and 6 p.m. Sunday School, 9:30 a.m. Wednesday, 6:45 p.m., Family Night with Kids' Klub for children, Youth Group for teens and Bible Study for adults.

CULTIVATE CHURCH (FORMERLY LAOTTO WESLEYAN): Old S.R. 3

on south edge of LaOtto; 897-6060. Lead Pastor Aaron Lee. Sunday Worship, 10:10 a.m. wearecultivate.org

Non-denominational

AFLAME REVIVAL CENTER: Pastor Bob Lambert, 574-534-2896. Sunday services, 3 p.m.

BELL TOWER BIBLE: 8851 N C.R. 250W, between Wawaka and Rome City; 761-2321. Pastor James La-Follett. Sunday Classes, 9:30 a.m. Family Worship, 10:30 a.m. Wednesday Prayer Meeting. Bible Study, and Kids4Truth, 6 p.m.

BRIMFIELD REVIVAL CENTER: U.S. 6, Brimfield. Pastor Brett Frick. Saturday Services, 7 p.m. Sunday School, 10 a.m. Worship, 11 a.m.

BURR OAK CHURCH: 11010 W. C.R. 1100N, Ligonier; 574-642-4813. Pastor Richard Carpenter. Sunday School, 9 a.m. Worship, 9:50 a.m. Wednesday Prayer and children's programs, 6:30 p.m.

CALVARY CHAPEL NORTH LAKES: C.R. 435S and C.R. 1170E, Stroh; 351-4215. Sunday Service, 9:30 a.m. Bible studies available.

CHURCH OF THE TRUE GOD: 5685 S. S.R. 3, Wolcottville, 2 miles north of South Milford on S.R. 3. Pastor Kenneth Beverly, 503-0497. Assistant Pastor Wayne Johnson, 336-1367. Sunday School, 9:30 a.m. Worship, 11 a.m. and 6 p.m.

CHURCH OF GOD OF PROPHECY MISSION: 109 W. 2nd St., Ligonier. Pastor James R. Ferguson. Sunday School, 10 a.m. Worship, 11 a.m. Evangelist Service, 7 p.m.

CHURCH OF THE STONE: 7270 S.R. 9, Wolcottville; 854-2738. Pastors Mike and Abi Stanley. Sunday School, 10 a.m. Worship, 11 a.m. and 6 p.m. Wednesday Prayer, 7 p.m.

COMMUNITY FELLOWSHIP OF TOPEKA: 128 Roy St., Topeka; 593-2472. Pastor Lyn Stutzman. Sunday Service, 10 a.m.

CORNERSTONE FELLOWSHIP: S.R. 120 and C.R. 1000W., Shipshewana; 768-4304. Rev. Joseph Sheely. Sunday School, 10 a.m. Worship, 11 a.m. and 6 p.m. Wednesday, 7 p.m. Bible Study, Tuesday, 7 p.m.

CORUNNA COMMUNITY CHURCH INC.: Rev. Richard Pickard. Sunday School, 9:30 a.m. Services,

10:30 a.m. and 6 p.m. Wednesday service, 6 p.m.

DESTINY FAMILY OF FAITH: 445 N. Riley St, Kendallville; 260-599-0254. Pastor Mike Wilson. Church and Sunday School, 10 a.m. Bible Study, 6:30 p.m. Thursday.

EDEN WORSHIP CENTER: Old Honeyville School, 4095 S. C.R. 900W, Topeka; 593-2979. Pastor Matt Gingerich. Sunday: Coffee and Fellowship, 8:45 a.m. Worship Service, 9:30 a.m. Children's Ministry during service. Cell groups on Wednesday and Friday evenings. Youth Service Wednesday, 6:30 p.m.

EMMA CHURCH: 1900 S. C.R. 600W, Topeka. Pastor Gene Hartman; 593-2036 or 593-3726. Worship, 9 a.m. Sunday School, 10:15 a.m.

FAIRVIEW FELLOWSHIP: 615 Professional Way, Kendallville; 260-437-1525. Pastor Marc Buwalda. Sunday service, 9 a.m. and 11 a.m. Office hours, Monday-Friday, 10 a.m. to 2 p.m.; email connect@fairviewfellowship.church.

FAITH ALIVE CHURCH: 1608 E. Dowling St., Kendallville; 242-2103. Senior Pastor John Maloney. Service times: Sunday, 10 a.m., Friday, 6:30 p.m. Website: thefaithalivechurch.com.

FIRST CHRISTIAN CHURCH: 110 W. Waits Road, Kendallville; 260-347-1729. Website: firstkville.org. Pastors: David Gruber, lead pastor; Michael DiSanto, associate pastor; and Lisa Hostler, youth ministry director. Worship Gathering: Sunday 8:45 a.m. and 10:30 a.m. AWANA, Wednesday at 6 p.m. September through April.

FULL GOSPEL LIGHTHOUSE TABERNACLE: 6522 Noe St., Kimmell. Pastor Glen Patrick, 463-4194. Sunday School, 10 a.m., Worship, 11 a.m. and 6 p.m. Wednesday Bible Study, 6:30 p.m.

GRACE CHRISTIAN: 126 E. Mitchell St., Kendallville; 347-3923. Pastor Chris Mosley. Sunday School, 9:30 a.m. Worship, 8 a.m. and 11 a.m. Wednesday service, 7 p.m.

GREEN CENTER COMMUNITY CHURCH: 2861 S. C.R. 300E, Albion. Pastor David Harrold. Sunday School, 9 a.m. Worship, 10 a.m.

GORDON'S CAMPING: Campground minister Wade Sturdivant. Sunday Worship, 8:30 a.m.

LEGACY CHURCH: 1011 Town St., Kendallville.

IGLESIA DE DIOS: 2895 N. U.S. 33, Kimmell. Ramiro Macia, minister. Services: Friday 7 p.m. Saturday 10 a.m. and 6 p.m.

LAGRANGE CHURCH OF CHRIST: 407 S. Townline Road; 463-3571. Sunday School, 9:30 a.m. Worship, 10:30 a.m. and 6 p.m. Wednesday Bible Service, 7 p.m.

LAKEVIEW WILDWOOD COMMUNITY CHURCH: 4975 S. C.R. 050W, LaGrange. Worship, 10 a.m.

MARION CHRISTIAN FELLOWSHIP: 5460 N. C.R. 450W, Shipshewana; 562-3261. Sunday Worship, 9:30 a.m. Sunday School (all ages) to follow.

MAPLE GROVE CHURCH: 806 S. Main St., Topeka. Pastor Jason Gingerich. 593-2844. Sunday School, 9 a.m. Sunday Worship, 10 a.m.

MERCY TREE MINISTRIES: 306 N. Allen Chapel Road, Kendallville. Pastor John Pfeiffer. Sunday service 10 a.m.

MESSIAH FELLOWSHIP CHURCH: 6200 E. S.R. 120, Howe; Pastor Ron Hyre. Saturday Worship, 2:30 p.m.

MESSIAH'S HOUSE OF YAHVAH (7TH DAY): corner of C.R. 400S and C.R. 200E, 7 miles south of Albion, 2 miles east of S.R. 9; 636-2275. Saturday Worship, 10:30 a.m.

MERRIAM CHRISTIAN CHAPEL: 3985 S. U.S. 33, Merriam. Sunday School, 9:15 a.m. Worship, 8 a.m., 10:35 a.m. and 7 p.m. Wednesday Prayer, 7 p.m. AWANA for children, 6:30 p.m. Teen Club for teen ministries, 6:30 p.m.

NEW BEGINNING INTERNATIONAL MINISTRIES: 1990 N. C.R. 1200W, Cromwell. Pastors Saul and Irma Saucedo, 260-906-6155. Sunday school, 10 a.m. Sunday worship, 11 a.m.

ORLAND CONGREGATIONAL CHURCH: 9315 W. S.R. 120, Orland. Mark Emelander, pastor, 260-668-1967. Sunday School, 9:30 a.m.; Worship, 10:30 a.m.; Wednesday Youth Group and Good News Club for children, 6 p.m.

PATH OF LIFE COMMUNITY CHURCH: 3583 S.R. 327, Auburn; 260-242-3090. Pastor Dave Beard. Sunday Worship, 9:30 a.m.

Churches

PLATO CHRISTIAN FELLOW-SHIP CHURCH: 340 S. C.R. 500E, LaGrange;260-336-3995. Pastor Michael Antal. Worship, 10 a.m. Wednesday Bible Study, 4 p.m.

SALEM COMMUNITY MISSIONARY: C.R. 325 S, 1/4 mile southeast of Wilmot. Pastor Gary Colby. Sunday Worship, 10:30 a.m.

SHORE CHURCH: 7235 C.R. 100N, Shipshewana. Pastor Nic Raber 768-4240. Sunday Worship, 9:15 a.m. Sunday School, 10:15 a.m.

SOUTH MILFORD CHURCH IN THE GARDEN:7510 S.R. 3, South Milford. Pastor Michael Antal; 351-3381. Sunday Worship, 8:30 a.m.

Wednesday Bible Study, 1 p.m.

SPARTA CHRISTIAN CHURCH: 2584 N. U.S. 33, P.O. Box 85, Kimmell; 260-348-5952. Adam Nelson. Worship, 10:30 a.m.

STONE’S HILL COMMUNITY: U.S. 33, South, Ligonier; 894-7528. Pastor Joey Nelson. Sunday Worship, 10 a.m. (Jr. Church and nursery available). Celebrate Recovery, 6:30 p.m. Wednesday. Wednesday Children’s Ministry, 6:30 p.m.. Youth Cafe and Game Room open at 6 p.m., Wednesday Youth Ministry, 6:30 p.m. Wednesday Parent Ministry, 6:30 p.m.

STRONG TOWER WORSHIP

CENTER: 502 W. Diamond Lake Road, Ligonier; 894-7065. Pastor Joshua Vargas. Adult service Sunday at 9:30 and worship service at 10:30 a.m. Children’s Bible Study, Wednesdays at 6:30 p.m. and adult Bible study at 6:30 p.m.

THE HOUSE, CHRISTIAN YOUTH CENTER: 203 S. Main St., Ligonier; 221-3063. Youth Service, Tuesdays at 6 p.m.

TEMPLO BETEL ASAMIEAS DE DIOS: North Cavin and Miller streets, Ligonier; 894-4487. Sunday School, 9:30 a.m. Worship, 5:30 p.m.

THE HOUSE OF PRAYER: 1608 E. Dowling St., Kendallville. Pastor

Emory Gibson. Thursday Service, 6:30 p.m. Sunday Service, 10 a.m.

THE RED ZONE: 9358 E. Wizard of Oz Way (Enchanted Hills Playhouse), Cromwell. Saturday, 7 p.m. Sunday, 10 a.m.

UPPER ROOM TABERNACLE OF PRAISE: 2245 Old S.R. 3N, Avilla. Pastor Quient Zimmerman. Sunday Worship, 11 a.m. Wednesday Bible Study, 7 p.m.

VINEYARD CHRISTIAN FELLOW-SHIP: 700 Kelly St. Extended, Rome City, Sunday Worship, 10 a.m. Wednesday, 7 p.m.



LaGrange County Council President Mike Strawser of Strawser Auction Group loaned a vintage sleigh for the holiday display in the LaGrange County Courthouse gazebo.



Avery Gorst of Elkhorn, Wisconsin, and Santa Claus share a moment. Gorst’s family travels to Shipshewana for the tree lighting every year.



This vintage Rome City fire truck was an entry in the 2023 Chautauqua Days parade. This year’s parade is in downtown Rome City.



Two students from the Rome City National Elementary Honor Society place white crocus bulbs in a “bouquet” planting in the garden at Sylvan Lake Public Access Site. Honor society students and Advance Rome City adult volunteers nestled the spring bulbs among the existing plants.



A giant mountain cabin scene illuminates the horizon beyond a glimmering drive-through archway at the Lights of Joy in Shipshewana.



Santa Claus is carried in a past Shipshewana Christmas Light Parade. This year's event will be held on Saturday, Nov. 8, at 7 p.m.



Nashville bluegrass band Williamson Branch performs in front of the Christmas tree on Middlebury Street.



Joseph Ryne of Advance Rome City demonstrates how to plant a bulb with the point up and the hairy roots down before the Rome City Elementary National Honor Society students get to work in the Sylvan Lake Public Access Site garden in downtown Rome City.



Horses will remain as part of the Dutch Creek Farm Animal Park attraction when it reopens in May.



Bicycles of all types can be seen mainly in LaGrange County during the two-day Amishland and Lake bike tour. These riders are heading in and out from the support and gear station in Mongo.



Quality. Handcrafted.

Complete line of *regionally made* solid wood furniture

- Bedding, Mattresses & Linens
- Rugs — including Machine Washable!
- Upholstered and accent furniture
- Decor — realistic greenery, mirrors, wall art & more

Wana
Cabinets & Furniture^{LLC}

7245 W 200 N
Shipshewana, IN
260.768.7850

CRAFTHOUSE Visit our upstairs store for fabrics,
Fabrics & Gifts delightful baby gifts, decor, and more.

www.WanaFurniture.com

NOW YOU KNOW!

Call 260-347-0400
to set up your
online account
and gain access
to e-editions,
breaking news
and much more.

*Included access available with a
5 day subscription to The News Sun,
The Star, or The Herald Republican

Your paid
subscription includes
online access!*

