

Metavine

Botanical Conservatory Sculpture Proposal

Prepared by: Cary Shafer

caryshafer@me.com

www.Caryshafer.com

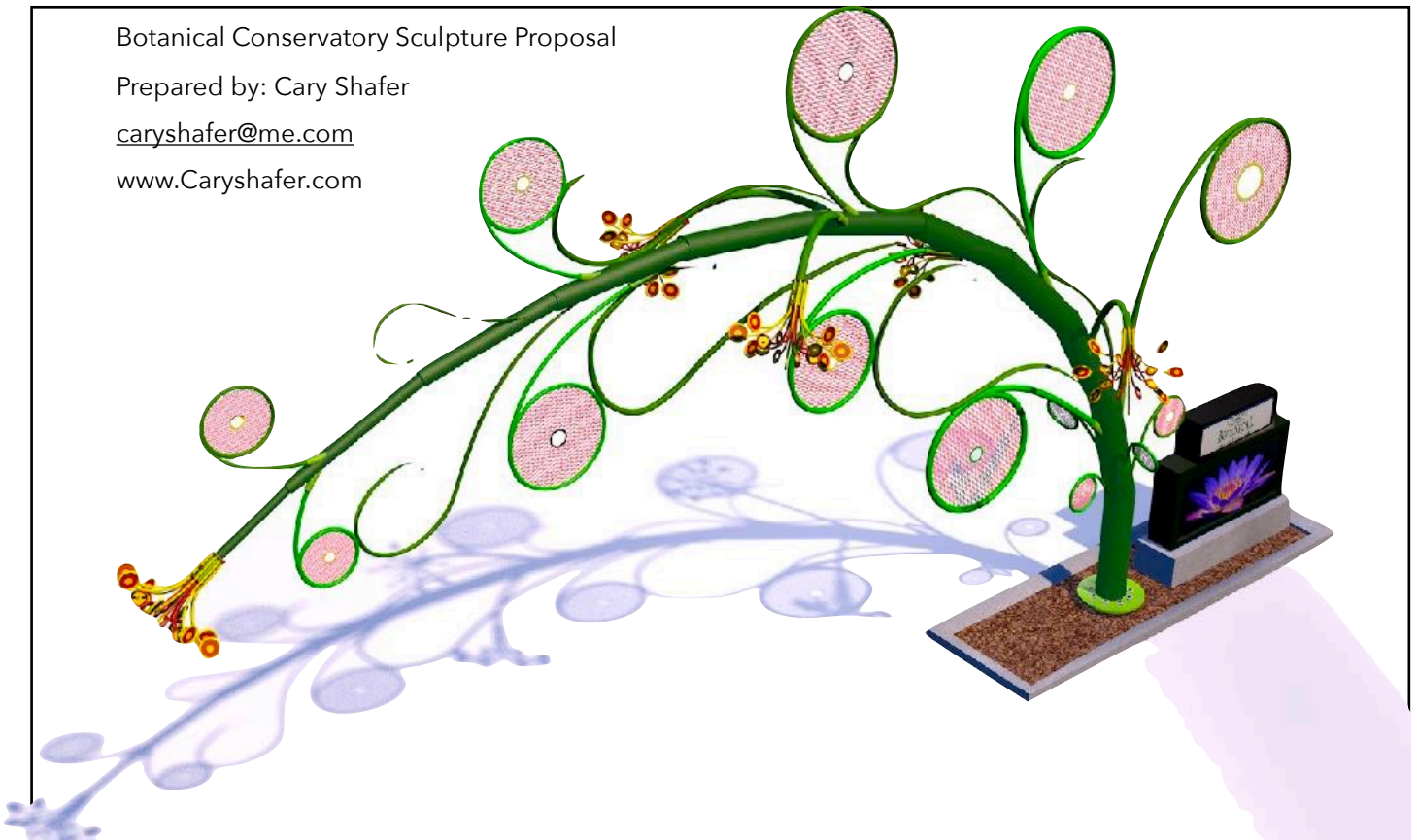

CONCEPT

Rising elegantly out of the foundation planter box is the Metavine. Its bamboo-like stem, made from welded steel tube, supports stamen-like tips resembling chandeliers and rolled steel tubes unfurling like leaves. Painted in bright colors inspired by nature, Metavine arches over the walkway inviting the viewer to look at it from every angle. Playful and elegant, Metavine is a site specific creation inspired by nature. Both light and airy it will be a dramatic stroke across the skyline without blocking any of the surrounding architecture.

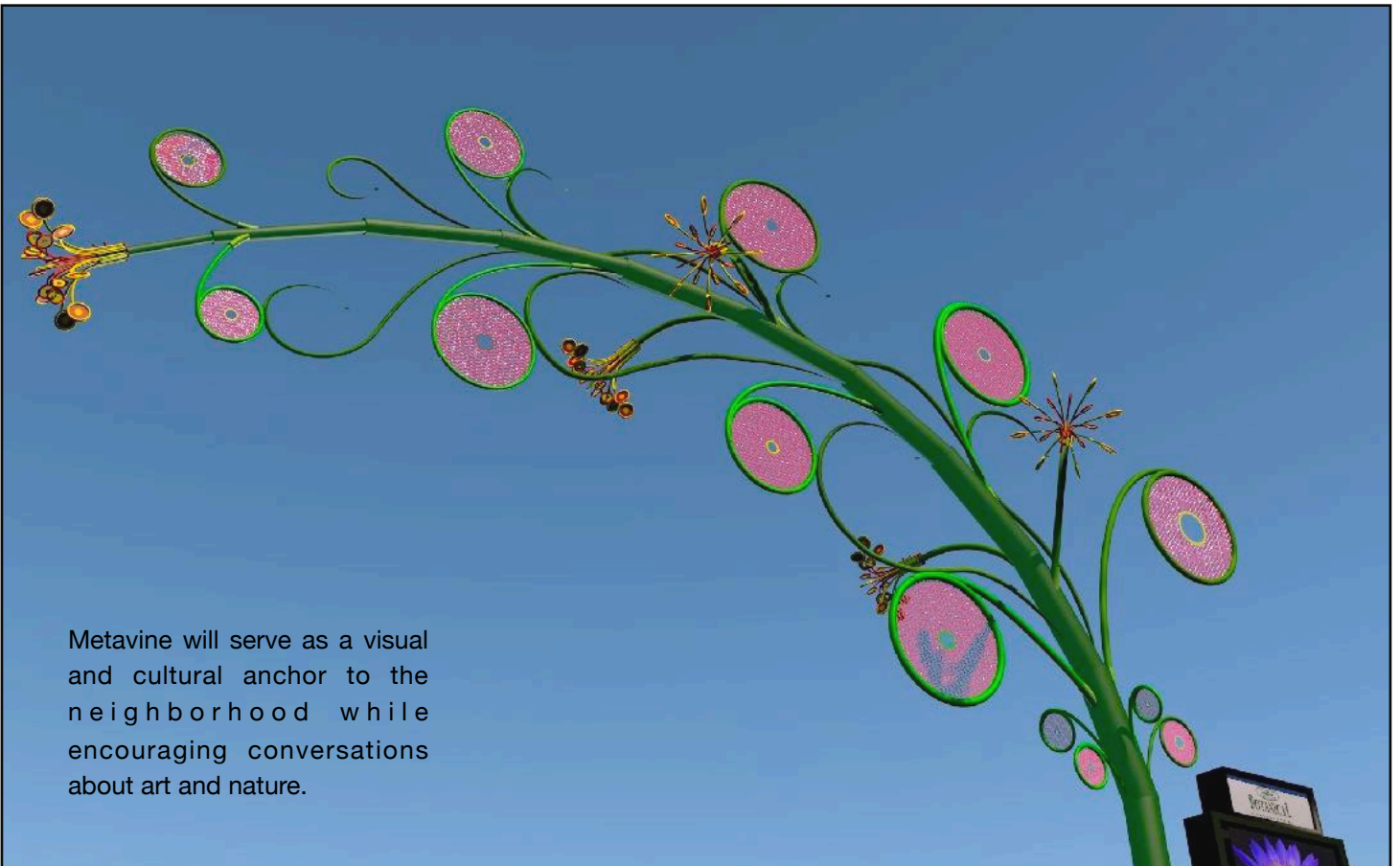
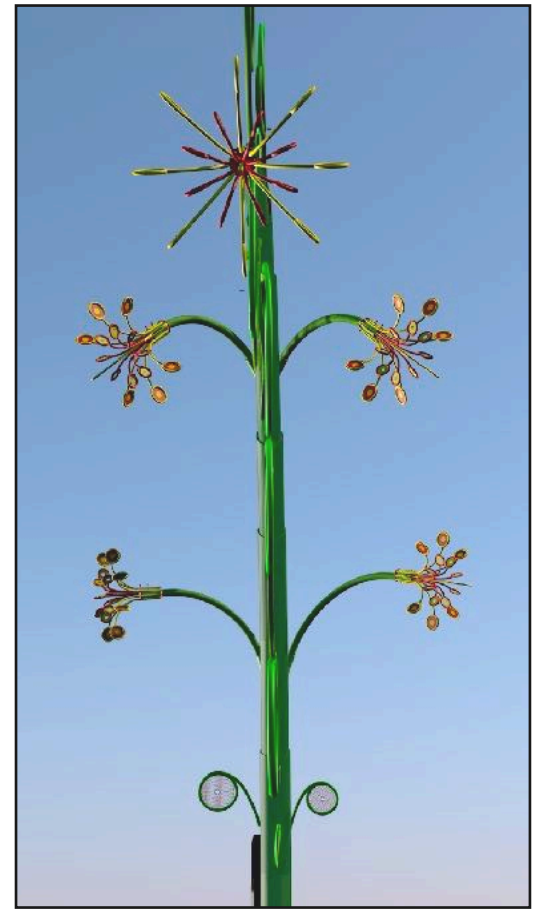
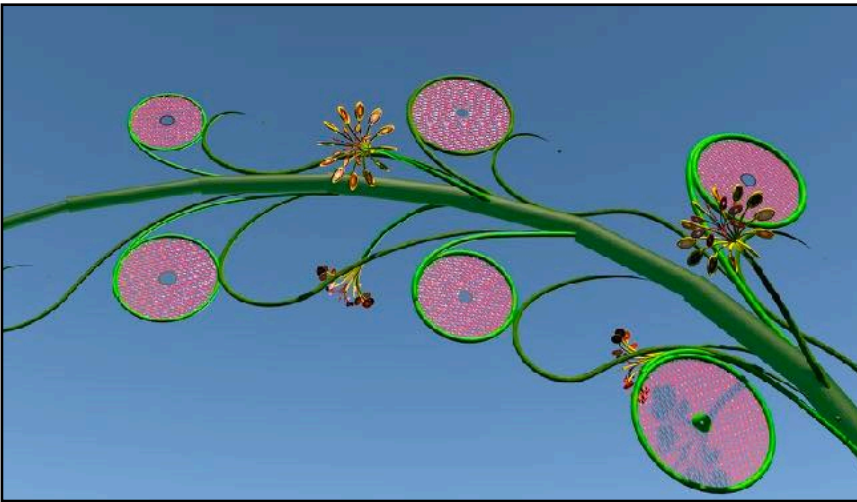

Metavine will serve as a visual and cultural anchor to the neighborhood while encouraging conversations about art and nature.

INSTALLATION

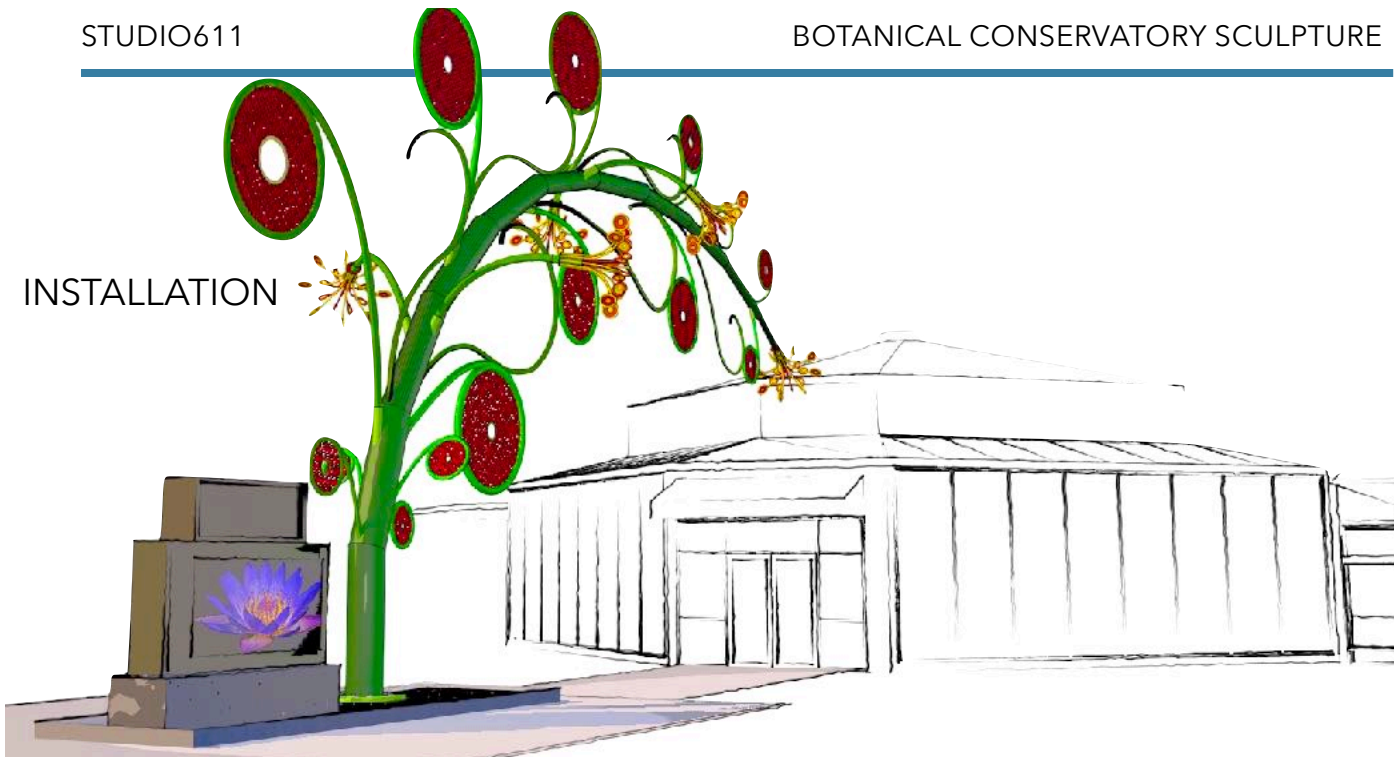

Installation will require a setting crane and some onsite welding. An experienced erector will require 2-3 days depending on final design and the amount of required welding.

The sculpture will arrive by flatbed trailers in a few pre-assembled units with the backbone stem being at least 2. The circles and stems will be attached according to the engineer and installers input.

All parts will be primed and pre-painted where possible with the final touchup paint applied after the erectors are finished.

Metavine's base plate will be fabricated based upon pre-existing anchor bolt locations. Anchor specs will be provided by the engineer.

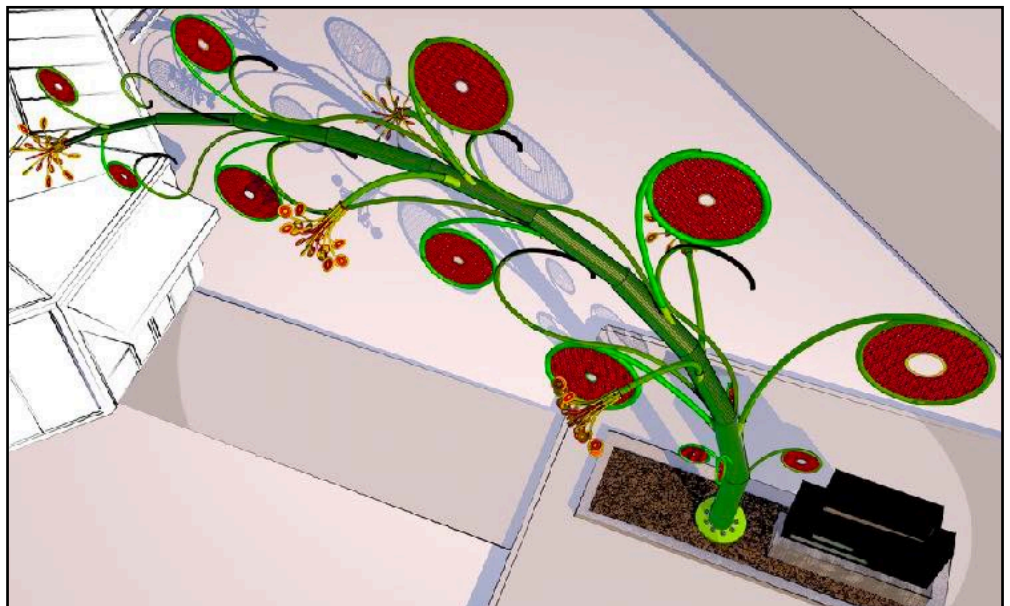

BUDGET

Engineer's stamp and fabrication drawings	7,500.00
Materials and Fabrication	60,000.00
Installation	25,000.00
Paint	5,000.00
<i>Estimated total</i>	97,500.00

Estimated costs are based on consultation with industry experts and personal experience.

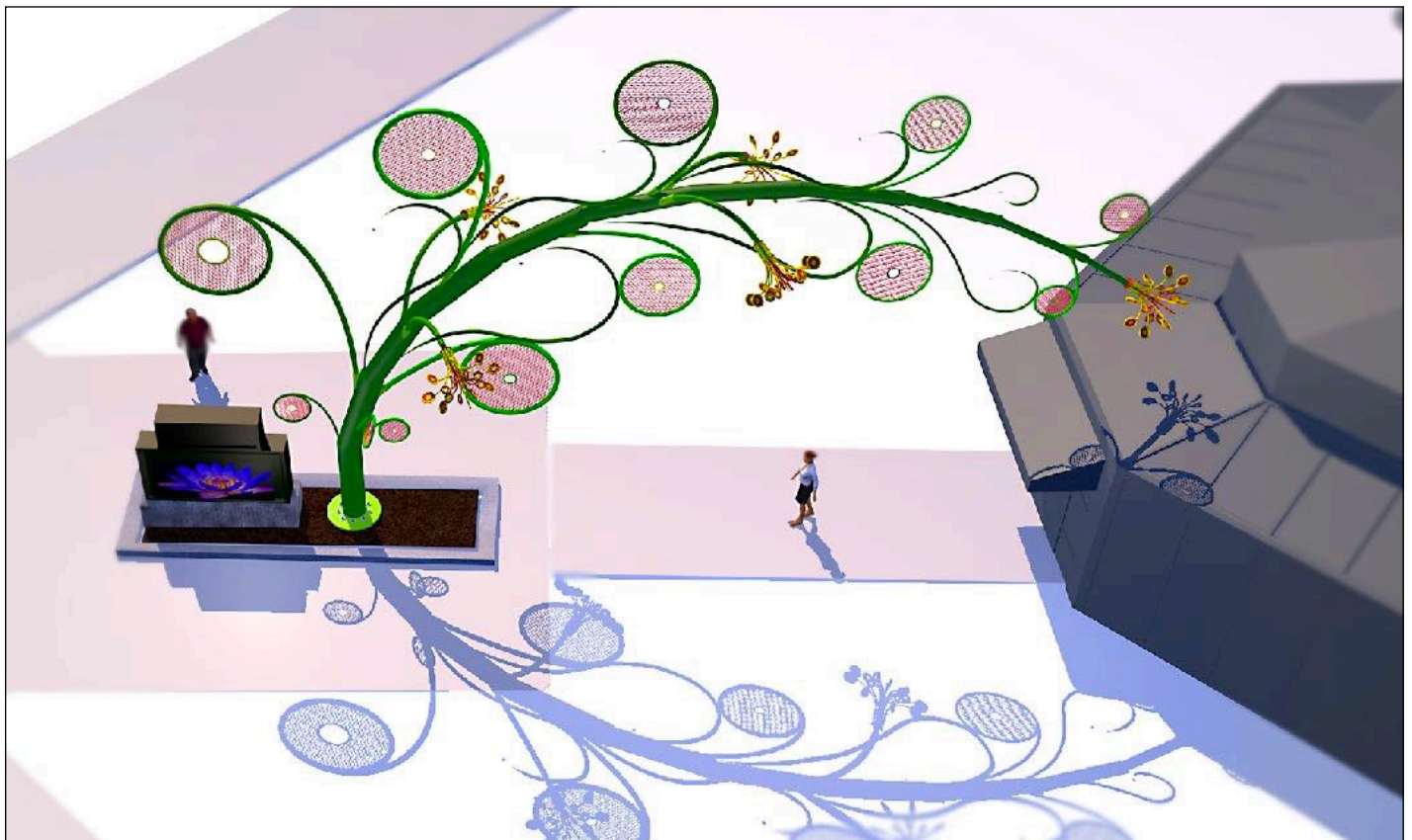

DIMENSIONS

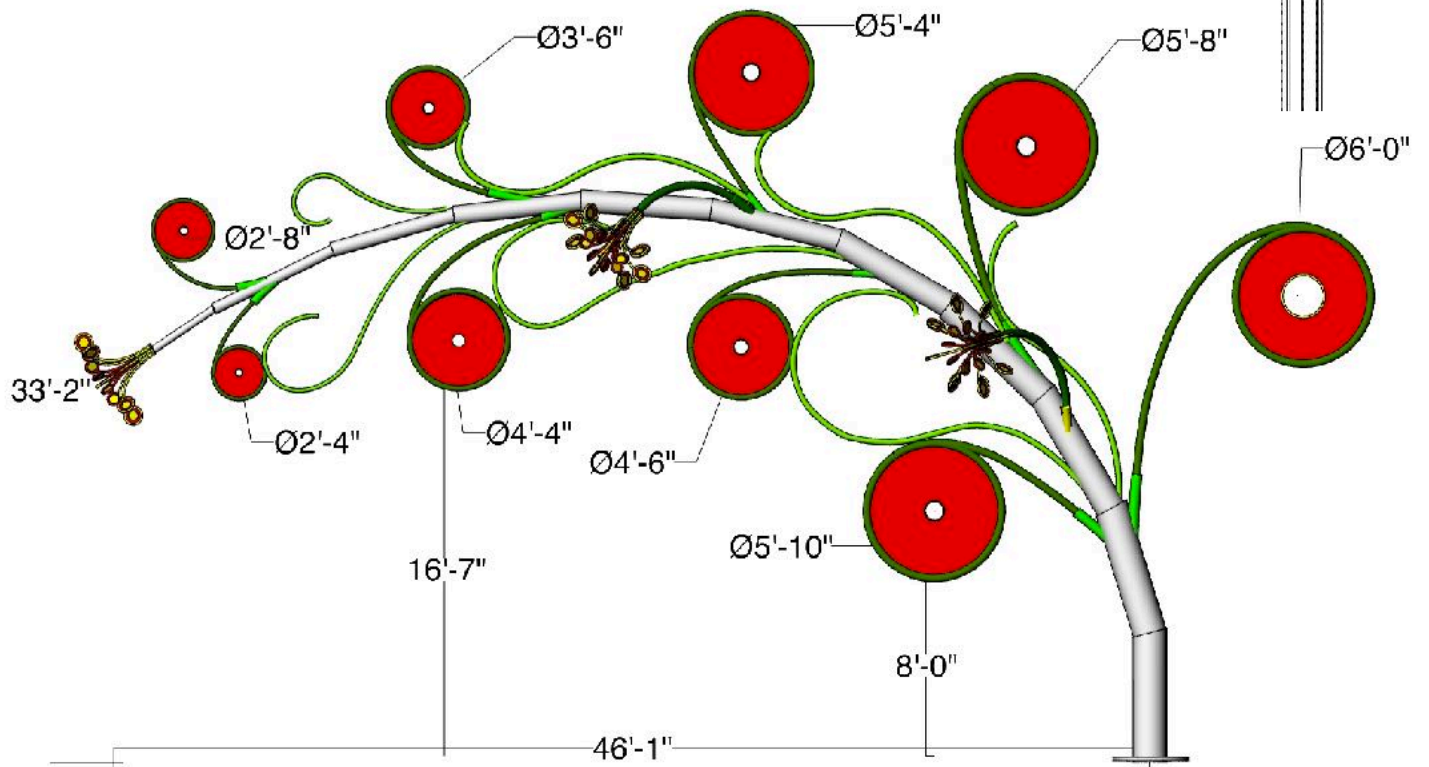
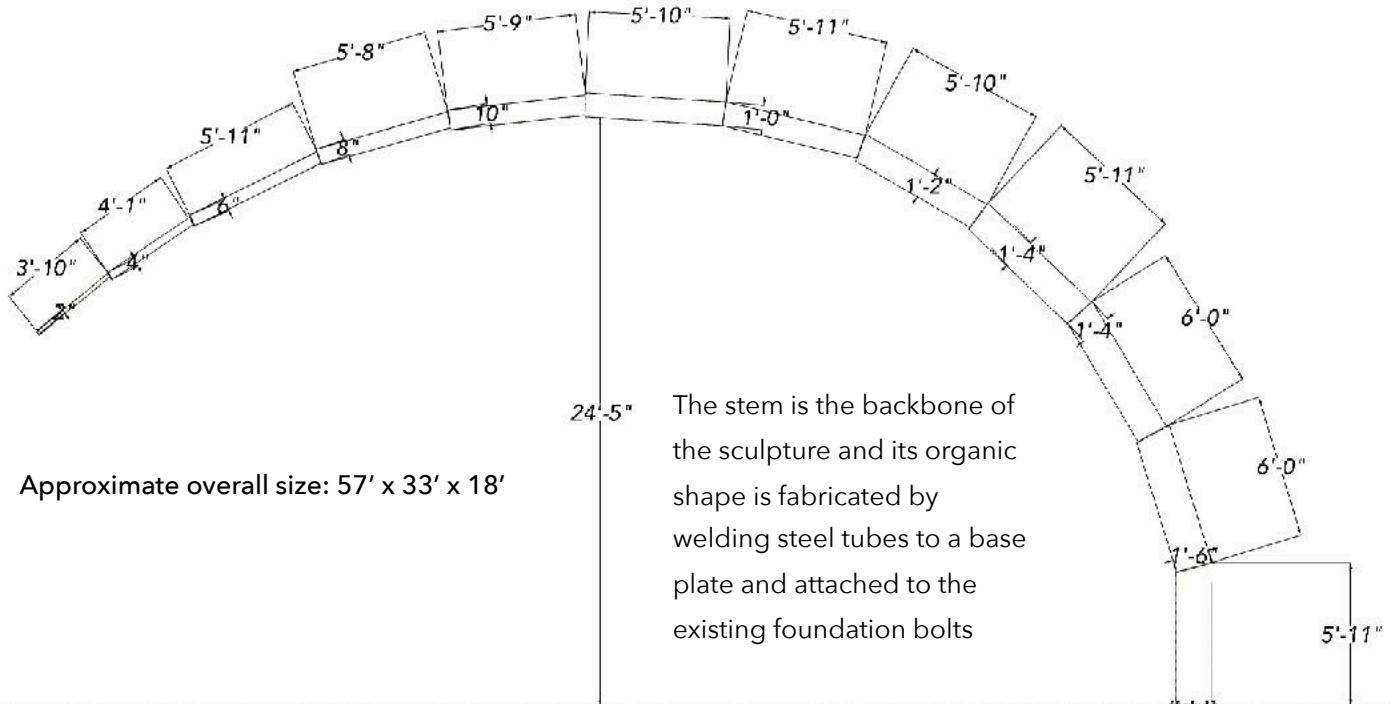

Chandelier shaped tips, 5 total, made from repetitive shaped arcs and circles, angle down appearing to look at the viewer.

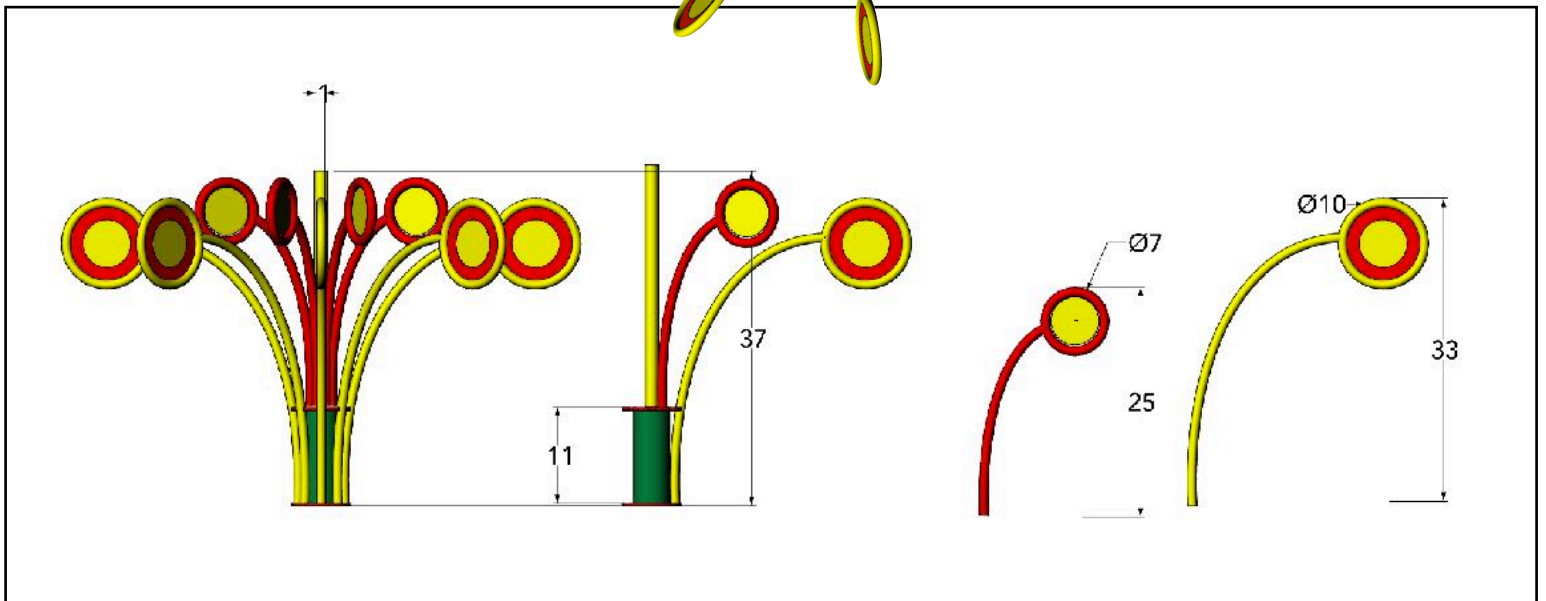
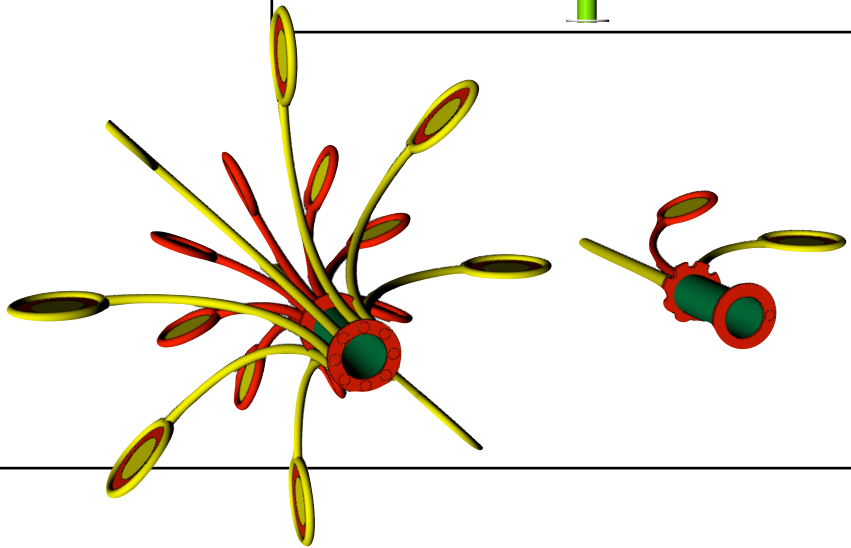
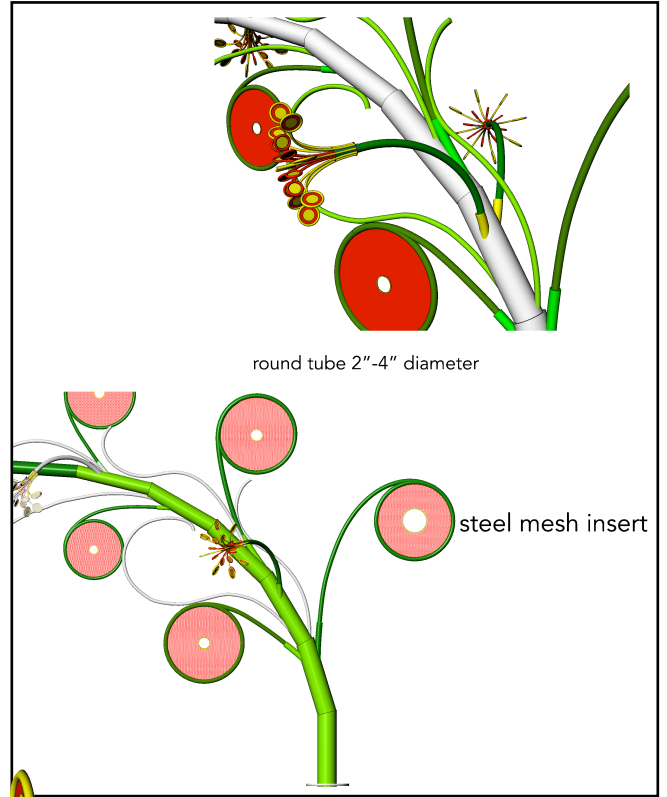
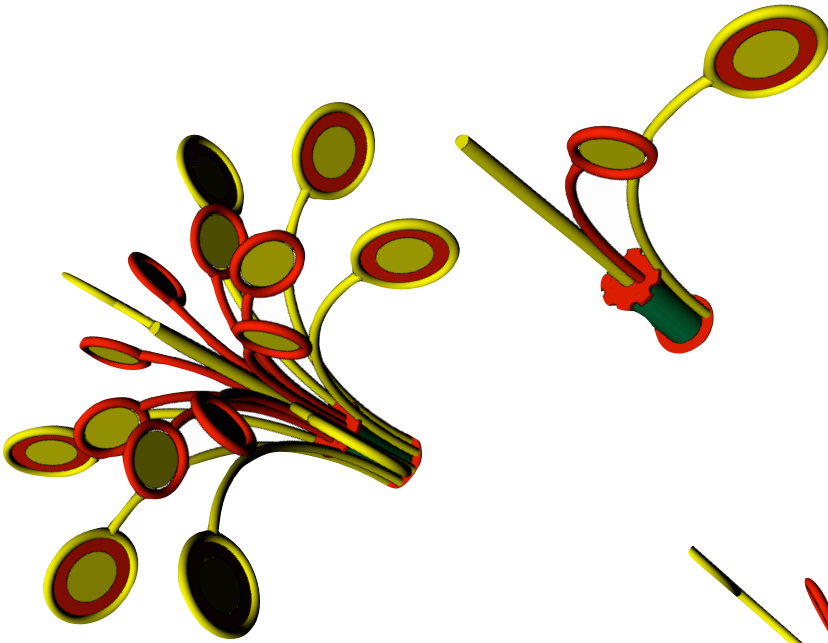

MAINTANCE

Periodic touchup paint. Paint colors will be supplied

Design allows for easy access to all the parts.

PRODUCTION TIMELINE

Upon accepted commission final artist drawing will be made and delivered to engineers for their work to specify materials and welding requirements. Stamped drawings will then be sent to the fabricator.

The fabricator will draw what they need to cut all the parts and weld the assemblies.

Parts cut and assembled in units.

Spray primed

Delivery to Site

Unload and installation

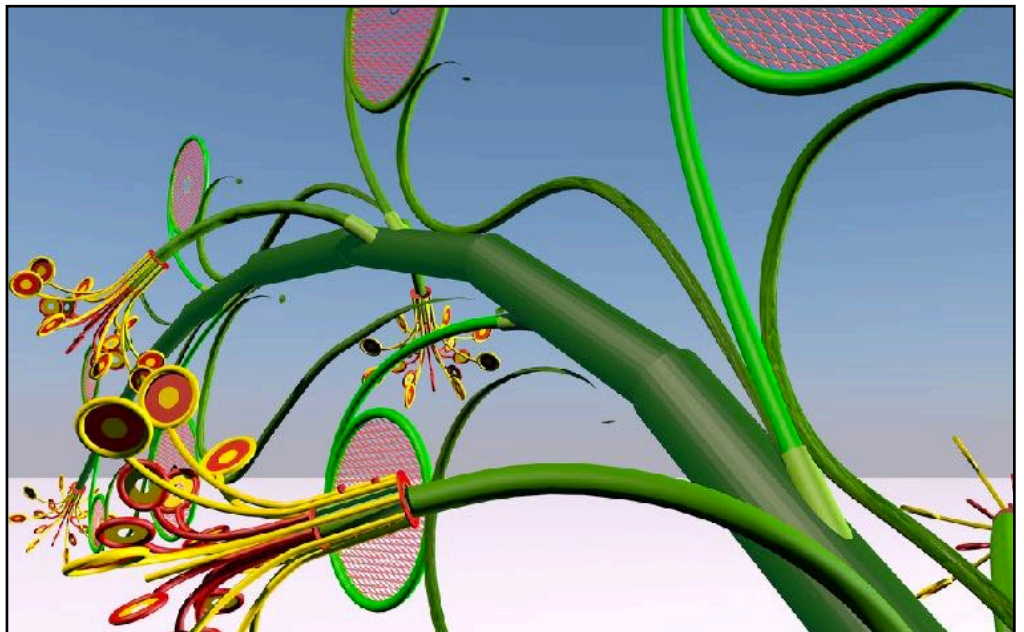

PREVIOUS WORKS

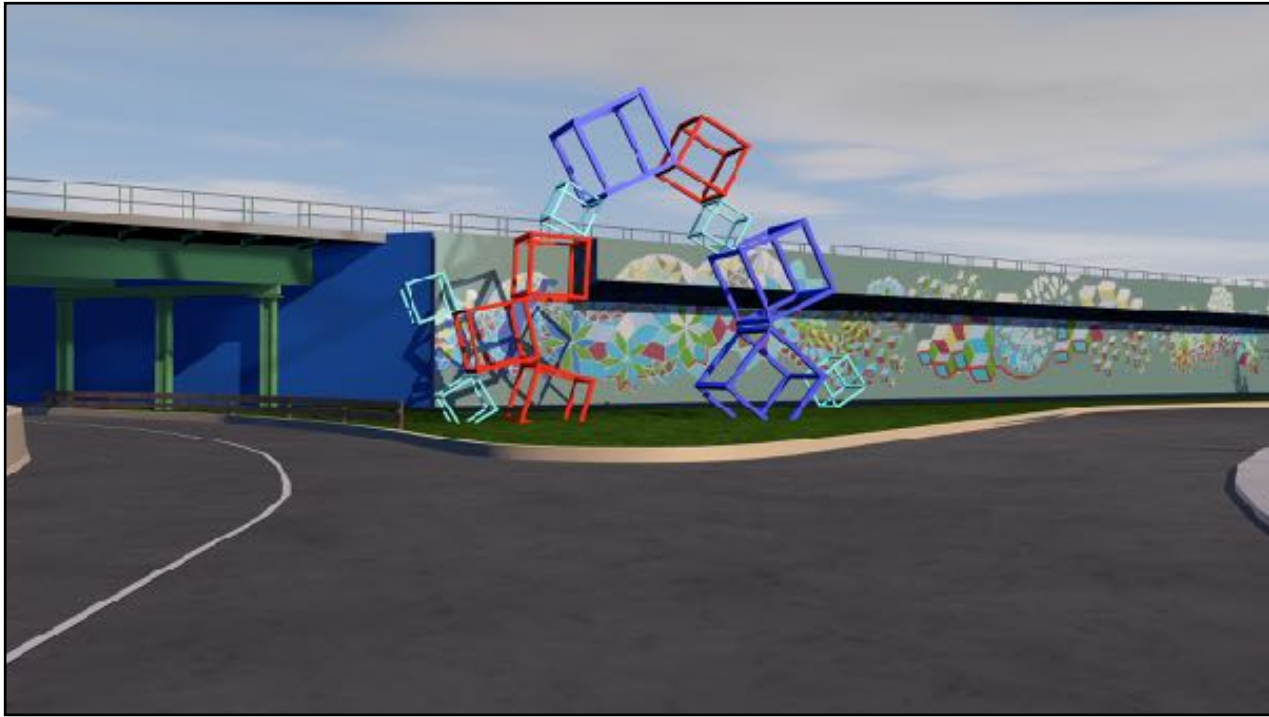

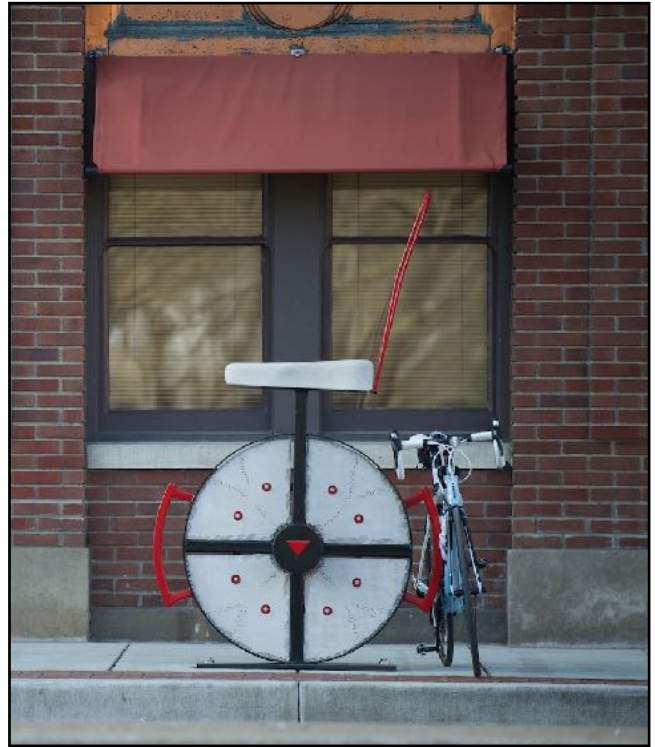



About Cary Shafer

American sculptor, Cary Shafer is a classically-trained stone carver whose breadth of work includes major architectural projects, private garden installations, and freestanding abstract sculpture.

A native of Indiana, Cary attended the Chicago Art Institute before completing four years of training with Italian master-carver Vincent Palumbo at Washington's National Cathedral. Apprenticed in the historic tradition, Cary learned stone carving's complex body of technical knowledge, its secrets to stones, the preferred tools for varying stages of work, and the techniques for achieving light and shadow. Among the many ornamental stones, Cary carved the final gargoyle on the cathedral.

From studios across the United States and in Europe, Cary's work continues to evolve as he explores the boundaries of his art on the personal and the large-scale. Completing many unusual, private commissions, he has also contributed to projects nationwide, served as Artist-in-Residence at Crazy Horse Mountain, South Dakota, and conducted restoration work at the White House.

Cary's skill and spirit of creativity allows him to envision the unique and to execute site-specific requests with masterful attention to detail. As fluidly, this same aesthetic has led him to embrace art direction in the film industry, and to share the significance of his work in lectures at schools and universities. With each new project, Cary finds new opportunity for challenge and inspiration that draws on one of the oldest, rarest crafts in the world.

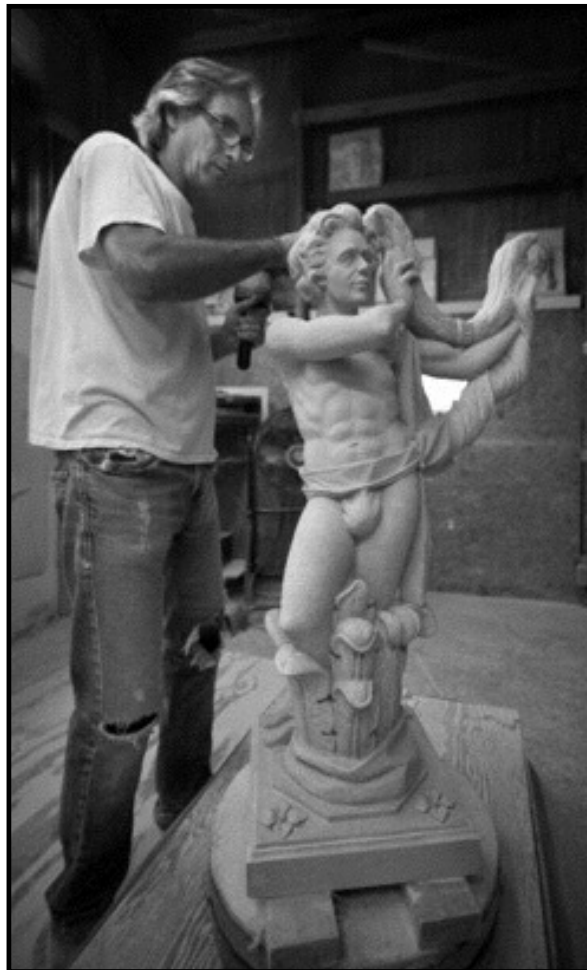

REFERENCES

Drs. David and Katrina Seitz
5701 North Carrollton Ave
Indianapolis In 46220
317 253 6364

Carlene St John
2939 Russell st.
Berkeley CA
510 649 0695

